



2008-2009
UPDATE
Bingham
ASSOCIATION

A few comments from the editor

Brendan J. O'Donnell (great, great, grandson of Clarissa Bingham 1.10a.2b.1.1.3.), has finished a complicated piece of research on one of his Bingham ancestors and shares his findings here in a concise and easy to understand discussion. Read on, learn, and applaud!

“One of the family mysteries is the inconsistency between the birth date of Herbert MacKay Bingham Jr. (1.10a.2b.1.1.8.2b.1.) of 12 Nov 1901 and the marriage of his parents (Herbert MacKay Bingham Sr and Cornelia Strassburg Carroll) on 25 October 1909.

Herbert Sr.'s first wife, Kate Price, died in 1904 leaving daughters Dorothy and Kathryn. Cornelia was the daughter of August Strassburg and Caroline Ruppert and married William Joseph Carroll in Manhattan on 11 February 1901 (marriage cert.)

The 1910 census lists Herbert Sr. and Cornelia in Manhattan with five children: Dorothy, Kathryn, August J. (age 8), William J. (age 6), and J. Ruppert (age 6). The three boys reflect names from Cornelia's family and first husband and the latter two were probably twins.

Herbert Sr. died in 1914 and the 1920 census lists Cornelia with three sons: Herbert M. (age 18), J. Ruppert (age 16) and Stuart A. (age 16). August J. had thus changed his name to Herbert M. and William J. had changed his to Stuart A.

Cornelia married Joseph Oppenheimer of Butte, Montana in 1921 and Joseph is listed in the Montana death index as dying on 31 January 1924. In the 1930 census, Cornelia was married

to James Bruce (Bruce J.) Kremer and living in Butte with sons Herbert M. (age 28), Ruppert (age 26), and Stuart (age 26); all three with last name Bingham.

The New York City birth index includes a record for August J. Carroll, born in Manhattan on 12 November 1901, the same birth date as Herbert M. Bingham Jr. It seems apparent that Cornelia's three sons were from her first marriage and were later adopted by Herbert M. Bingham Sr.

Cornelia and Bruce moved to Washington DC by 1940 where Bruce died on 23 July 1940 (obit). Cornelia died 15 May 1974 (obit) at age 92 and is buried with Bruce in Rock Creek Cemetery."

Brendon J. O'Donnell
Fairfax, VA
(emailed December 22, 2008)

Editors note; For Brendon's other contributions look for @BJO

~~~~~

### **Special Acknowledgements**

Tina Baird and Sharon Tinley. Plainfield, Illinois Public Library

Selina Brown for her assistance with entries on Internment.net.

Elmer Dickson for everything on kendallkin.org and his personal help as well.

Kyle D. Conrad of the Newton County, Indiana, Historical Society

Jennifer S. Newton, History Intern, St. Augustine Historical Society Research Library

Dodge/Jefferson Counties Genealogical Society, Watertown, Wisconsin

Barbara Baraw and Patricia Haslam, retired CG, Stowe, Vermont, Historical Society

## Generation Two

- 1.3. **Mary BINGHAM** (Thomas)  
Bur: Windham Center Cemetery®682



*Mary Bingham Backus  
Gravestone*

*Windham Center Cemetery®682*



## Generation Four

- 1.9a.3.1. **Hannah BINGHAM** (Lemuel, Samuel, Thomas)

*substitute entry; new info, new chr.: 4-21*

Born: 26 Apr 1738, Windham CT®5: 31

Mar: 20 Jan 1757, **Joshua LAS[S]JELL** Scotland, Windham, CT ®5, page 31, 152, ®574, Third Book, Scotland, page 45; Born: 21 Dec 1729, Hingham; Mar (1): Susanna WALDEN; Died: 22 Sep 1807, Lanesborough, Berkshire, MA; Bur: Talcott Cemetery, Lanesborough, Berkshire, MA®865; ®864

Died: 11 Oct 1827, Lanesborough, Berkshire, MA; Bur: Talcott, Cemetery, Lanesborough, Berkshire, MA ®865

Hannah, the oldest child of Lemuel and Hannah Perkins Bingham was born in the Scotland section of Windham. At the age of eighteen she married Joshua Lasell as his second wife. [Joshua's son by his first wife died the day he was born 16 Mar 1753.®865] They first lived in Windham and had five children whose births were recorded in the Windham records between 1757 and 1765. One died in infancy. Hannah and Joshua next lived in the "Horse Neck" area of Norwich where two more children were born and baptised. In 1772 the family moved to Nobletown where the last two children were born. Before 1790 they moved to Lanesborough, Berkshire, MA where they were enumerated on the first federal census. At that time, two sons over 16, one son under sixteen, and one daughter lived at home. Their son Bingham Lassell was baptised by the Rev. Gideon Bostwick in Lanesborough.®553: Remarkable Records of Rev. Gideon Bostwick, 1770-1793. Great Barrington, MA Both Hannah and Joshua died and were buried in Lanesborough.

Lasell children

1. Joshua 16 Oct 1757, Windham CT®55: 152
2. Lemuel 24 Jun 1759, Windham CT®55: 152
3. Leban 16 Jun 1761, Windham CT; Died: 20 Sep 1761, Windham CT®55: 152
4. Susannah 3 Oct 1762, Windham CT®55: 152
5. Martha 25 Mar 1765, Windham CT®55: 152
6. Hannah 9 Jun 1767, Norwich, New London, CT®865
7. Laban 14 Sep 1770, Norwich, New London, CT®865
8. Elias 25 Aug 1772, Nobletown, MA (now Hillsdale, Columbia, NY)®865;
9. Bingham 21 Jan 1775, Nobletown, MA (now Hillsdale, Columbia, NY); Bapt: 11 Jul 1779, Lanesboro, MA®865



*Hannah Bingham Lassell Gravestone*



*Joshua Lassell Gravestone*

*Talcott Cemetery, Lanesborough, Berkshire, MA@864*

## Generation Five

1.2.8b.3.4. **Edward BINGHAM** (Elisha, Jonathan, Abel, Thomas)

*new info, rewritten bio-sketch: 5-28*

Born: 23 Feb 1776, Enfield NH@85

Mar: abt 1804, NY **Almira HOOKER**; Born: 30 Mar 1789, NY@92; Died: 6 Aug 1873, Danby, Tompkins, NY; Bur: Baptist Corners Cemetery, Spencer, NY@915

Died: 6 Mar 1860, Spencer, Tioga Co NY; Bur: Baptist Corners Cemetery, Spencer, NY@915

Edward was the fourth son of Elisha and Hannah Slapp Bingham. His mother died when he was sixteen. A few years later, in 1797, his father and brothers, Elias and Abel, left Enfield, NH and moved to Jay, Essex Co NY. Edward probably remained on the farm with brother Alfrad; at least he paid taxes in Lebanon NH 1797 to 1801. Thereafter, he lived in Jay, Essex, NY, also, where he married Almira Hooker, about 1804 when she was sixteen. In 1810, Edward and family were enumerated in Jay with two males and one female under ten. His father, Elisha, may have lived with him at the time.@136: 17 During the War of 1812 Edward served in Sanford's Unregimented Battalion, New York Militia at the rank of Private.@310, Roll Box 17

Edward and family moved to Spencer, Tioga County between 1820 and 1830 where he lived until he died shortly before the 1860 census was taken.@115: 145, @150: 113, @92: 108; @830 One report claims that Edward may have had as many as twelve children, but only six males other than himself and wife Almira were attributed to him on the 1830 census when Edward was 54 years old. Sons Ira and Seth also lived in Spencer at the time. Samuel, Henry and Abel moved to IL, Daniel died age 17. Edward died age eighty-two in 1858. After Edward died, Almira lived with son Seth in Danby, Tompkins, NY.

### Children

1.2.8b.3.4.1. Ira 1808 Jay, Essex, NY

1.2.8b.3.4.2. Samuel H. 1816 Jay, Essex, NY

1.2.8b.3.4.3. Henry 1823 Spencer, Tioga, NY

1.2.8b.3.4.4. Seth 1825 Spencer, Tioga, NY

1.2.8b.3.4.5. Abel C. Dec 1829 Spencer, Tioga, NY

1.2.8b.3.4.6. Daniel 1838 Spencer, Tioga, NY; Died 1855 Spencer, Tioga, NY; Bur: Baptist Corners Cemetery@915

1.2.8b.3.7. **Ophelia BINGHAM**@832 (Elisha, Jonathan, Abel, Thomas)

*new info, rewritten bio-sketch: 5-28*

Born: 8 Nov 1781, Enfield NH@85

Mar: abt 1802 **Eli PAGE** (Peter PAGE, Sarah FARNSWORTH) NY@832; Born: 11 Sep 1775 Charleston, Sullivan, NH@887; Died: 6 Dec 1859, Collins, Erie, NY (age 84 yr 2 mo 25 da); Bur: Mt Pleasant Cemetery, Collins, Erie, NY@887

Died: 19 Mar 1868, Collins, Erie, NY (age 86 yr 4 mo 11 da); Bur: Mt Pleasant Cemetery, Collins, Erie, NY@887  
Ophelia and Ely lived in Collins, Erie, NY from 1834 until their deaths.

Page children

1. Elisha Bingham 11 Aug 1804 VT
2. Mary Ann 5 Aug 1806
3. Phyzona 1809 - 1 Apr 1839@887
4. Casper 1811 - 26 Jan 1836@887
5. Peter 1815- 12 May 1838@887
6. Semantha 1816 - 26 Sep 1886@832
7. Ely Jr. 1819
8. Caroline B. 1823-1884

1.10a.2b.1.1. **Samuel BINGHAM Jr.**

*add to bio sketch: 5-47*

In December 2004, Finzer Roller, LLC, acquired Samuel Bingham Enterprises (SBE) from Reinhold Industries. SBE manufactures printers rollers and other products at 14 locations in the US and Canada. From the company's press release: "In business for more than 175 years, Bingham has been a pioneer in the roller making industry."

## Generation Six

1.1.6.5a.1a.4. **Catherine "Caty" BINGHAM** (Royal, Benjamin, Jabez, Thomas, Thomas)

*replace entry: 6-11*

Born: 25 Dec 1786, Caughnawaga, Montgomery Co NY

Mar: 14 Oct 1804 **John VAN DUSER** Fonda, Montgomery Co NY@211; Born: 3 Feb 1772, Johnstown, Montgomery, NY@1041; Died: 21 Apr 1860, Will, IL@1041

Died: 25 Aug 1852, Joliet, Will, IL@1041

After marriage, Caty and John lived in Madison Co, NY, where their eleven children were born. In 1837 when Caty was 51 years old, she and John moved to Will County, IL. Their son George, their sixth child, had moved to Chicago in 1836 where he spent the winter searching for land. He found tracts in Will County where he and father John bought in June, 1837. John and Caty lived in Will County the rest of their lives. George was the only surviving child. @1041

VanDuser children: 1. George 19 Jul 1817, Lenox, Madison, NY@1041

1.1.8a.2.6.6. **Susan BINGHAM**

*new information; expanded entry: 6-25*

Born: 5 Aug 1808, Sprague, Lisbon Twp, New London Co CT@5: 5

Mar (1): 10 May 1827 **John KIRK** (Andrew KIRKPATRICK) Trumbull, OH@242; Born: 1805

Mar (2): abt 1874 **Ann**; Died: 27 Jan 1891, Jacksonville, Morgan, IL

Died: 1872, Chicago, Cook, IL@964

Susan was 11 years old when she moved with her family to Ellsworth, Trumbull County, OH from Sprague, New London, CT. She was 19 when she married John Kirk and he was 22. John had already been in the mercantile business in Youngstown for five years. When the 1830 census was taken, they were both between 20 and 30 and daughter Alice was their only child. One male age 15-20 lived with them. The 1840 census accounts for Alice, Henry or Thomas, Mary, and Maria and one male age 20-30 in addition to John age 30-40 and Susan, also age 30-40. By 1850 John was a clerk working for a well known iron foundry firm in Pittsburgh: Jones and Laughlin. He traveled throughout the Ohio Valley and into Illinois doing business on the company's behalf. The family retained their home in Youngstown, now Mahoning County, Ohio where they raised their children, seven of whom were alive and at home in 1850. The youngest, Rufus Lord Kirk, was born in December 1850. When Rufus was 7 years old John and Susan Kirk moved to Chicago. John opened a warehouse there for Jones and Laughlin and ran it for five years. The family was not enumerated in 1860. John left Jones and Laughlin in 1862 and moved to Mercer County, PA where he worked in agriculture for two years. In 1864, the family returned to Chicago so John could use the city as his center of operations as a commercial representative for several eastern iron manufacturing companies. In 1870 the two youngest children, Ellen and Rufus, were still at home and Gurdon Bingham, Susan's nephew (son of Susan's brother Lemuel) age 26 lived with them and worked as a clerk for John. Susan died in 1872, two years before John retired. John married again about 1874, a woman named Ann and moved to Jacksonville, Morgan County IL where he lived until he died in 1891.@964

Susan's sons Thomas J. Kirk and Rufus L. Kirk continued in the iron business. Thomas was the senior partner in the firm Kirk, Coleman & Company, dealers in iron and heavy hardware. Rufus was an accountant. Through time the company was known as Thomas J. Kirk & Company, Kirk and Barker, The Kirk Iron and Hardware Company, and The Wick and Bonnell Company. In 1882, Rufus became an accountant with S.D. Kimbark.@964

Kirk children born Youngstown, Trumbull/Mahoning OH

- |               |               |                               |              |               |
|---------------|---------------|-------------------------------|--------------|---------------|
| 1. Alice 1828 | 2. Henry 1830 | 3. Thomas J. 22 Aug 1832@965  | 4. Mary 1834 | 5. Maria 1838 |
| 6. John 1840  | 7. Ellen 1849 | 8. Rufus Lord 15 Dec 1850@964 |              |               |

**CHILDREN OF EDWARD** (Elisha, Johnathan, Abel, Thomas)

*new info; new bio-sketches: 6-46-47*

1.2.8b.3.4.1. **Ira BINGHAM** (Edward, Elisha, Johnathan, Abel, Thomas)

Born: 3 Apr 1808, Jay, Essex Co NY

Mar: abt 1830 **Sally HOLDRIDGE** (Elisha HOLDRIDGE)<sup>830</sup>, p. 446 NY; Born: 16 May 1807, Bridgewater, Susquehanna, PA; Died: 3 Mar 1885, Spencer, Tioga, NY; Bur: Baptist Corners Cemetery, Spencer, NY<sup>915</sup>

Died: 4 Feb 1849, Spencer, Tioga Co NY<sup>682</sup>; Bur: Baptist Corners Cemetery, Spencer, NY<sup>682</sup>

Ira was probably Edward's oldest son. The 1830 census attributes one 20-30 year old household member to Edward. If this is Ira, it would place Ira's birth between 1800 and 1810 which would fit with his parent's approximate marriage date and his younger brother's known birth dates. Furthermore, the 1840 census shows that Ira and his wife were both between 30 and 40 years of age. The confusing issue is the time span of nine years between Ira's birth and his next sibling. The 1830 census indicates more than five years. That census also records only male siblings. Ira was probably born in Jay, Essex Co NY about 1808 and moved to Spencer by 1830. He was enumerated on the 1840 census with one male child 10-15 and two female children 5-10.<sup>150</sup>: 113 This would account for his two oldest daughters on the 1850 census, but the son is missing. Furthermore, Ira is also missing from the 1850 and all succeeding censuses. Only Sally and the children appear.<sup>92</sup>: 108 Both Hall in her transcription and FindaGrave.com show that Ira was born in 1808 and died in 1849.

If Sally's father was Elisha Holdridge as indicated in the Historical Gazetteer of Tioga County, New York, then Sally was born in Bridgewater, Susquehanna County, PA. Holdridge moved his family to Spencer, Tioga, NY between 1820 and 1830 when Sally would have been between the ages of 13 and 23. She would have met and married Ira shortly after arriving in Spencer.

After Ira died, Sally married James Tompkins. Tompkins had been born in England about 1814 and may have been related to the many Tompkins in Tioga and Tompkins Counties, NY. The 1860 census shows Sally, age 53, and daughter Mary (age given as 18 and surname spelled Brigham) living with Tompkins and three others (Mary Cashman, 18; W.H. Cashman, 17; Liddy Forsythe, 19). However, in 1870, Sally is not living with Tompkins, but with son Ira Augustus and his family in Spencer. Sally's son Seth and daughter Sarah A. also live with Ira Augustus. The 1880 census for Spencer is not available so we can't say where Sally was then living. All we know is that she was buried in the Baptist Corner's Cemetery where Ira had been buried.

Children born Spencer, Tioga, NY

1.2.8b.3.4.1.1. Emma 1830

1.2.8b.3.4.1.2. Eliza A. 1832

1.2.8b.3.4.1.3. Mary Lambert 1835

1.2.8b.3.4.1.4. Sarah A. 1842

1.2.8b.3.4.1.5. Ira Augustus 1844

1.2.8b.3.4.1.6. Seth H. 1846

1.2.8b.3.4.2. **Samuel H. BINGHAM** (Edward, Elisha, Johnathan, Abel, Thomas)

Born: 2 Jun 1816, Jay, Essex, NY<sup>897</sup>

Mar: 11 Mar 1837 **Harriet H. GRIDLEY** (Henry GRIDLEY; Sarah SCHOFIELD) NY; Born: 16 Apr 1819 NY<sup>897</sup>; Died: 12 Jun 1885, Newark, Kendall, IL<sup>897</sup>; Bur: Millington-Newark Cemetery, Kendall, IL<sup>897</sup>

Died: 10 Aug 1907, Newark, Kendall, IL; Bur: 12 Aug 1907 Millington-Newark Cemetery Newark, Kendall, IL<sup>897</sup>

Samuel lived in Newark Twp, Kendall Co, IL for 62 years, but before arriving in IL he lived in Tompkins Co, NY and Spencer, Tioga Co, NY. where his oldest child, daughter Rachel A. was born in 1839 and died in 1841. Then in 1843 Samuel, wife Harriet and 2 year old Martin moved to Newark, Kendall Co, IL to join his father-in-law Henry Gridley. We know that Samuel arrived in 1843 because his third child, daughter Margaret A. died that year and was buried in Millington-Newark Cemetery. Samuel bought a village lot about 1844 and built a house where he lived the rest of his life. In the Biographical Directory of Kendall County Samuel is listed as a Boot and Shoemaker, and an independent republican and a baptist.<sup>898</sup>, <sup>912</sup> He had one unfortunate incident with his business. In March 1868 a fire in the center of Newark destroyed Manchester's drug store, Winchell's Hardware, and Bingham's shoe store.<sup>901</sup>, p. 374 After Samuel's wife died in 1885, son Martin continued to live at home, unemployed, and in 1900 Samuel's daughter Mary E. Saunders also lived with him.

Children

1.2.8b.3.4.2.1. Rachel A. 26 Aug 1839; Died Feb 1841 Spencer, Tioga, NY; Bur: Baptist Corners Cemetery, Spencer, NY<sup>915</sup>

1.2.8b.3.4.2.2. Martin "Mart" A. 18 Aug 1840 Spencer, Tioga, NY<sup>897</sup>

1.2.8b.3.4.2.3. Margaret A. 1843; Died as Infant Sep 1843 Newark, Kendall, IL; Bur: Millington-Newark Cemetery<sup>897</sup>

1.2.8b.3.4.2.4. Sarah Jul 1844 Newark, Kendall, IL

1.2.8b.3.4.2.5. Mary Elizabeth Aug 1849 Newark, Kendall, IL<sup>899</sup>

1.2.8b.3.4.2.6. Samuel J. 1853; Died 20 Sep 1854 Newark, Kenalll, IL; Bur: Millington-Newark Cemetery<sup>897</sup>

1.2.8b.3.4.3. **Henry BINGHAM** (Edward, Elisha, Johnathan, Abel, Thomas)

Born: Jun 1823 Tompkins, NY

Mar: 1 Jan 1851 **Mary Louise GRIDLEY** (Henry GRIDLEY; Sarah SCHOFIELD) Kendall, IL<sup>897</sup>; Born: 5 Aug 1832 Spencer, Tioga, NY<sup>897</sup>; Died: 2 Mar 1909, Shabbona, DeKalb, IL<sup>897</sup>; Bur: Lakeview Cemetery, Row E, Lot 60. South Haven, MI<sup>897</sup>, <sup>910</sup>

Died: 1902, South Haven, Van Buren, MI; Bur: Lakeview Cemetery Row E, Lot 60, South Haven, MI<sup>910</sup>

Henry followed his older brother, Samuel to Newark, Big Grove Twp, Kendall Co, IL arriving in 1845.<sup>901</sup>, p. 249 Henry was also a shoe maker and the 1850 census shows him, age 27, living with brother Samuel and family and using the name

Harry. In 1851, Henry married Samuel's wife's sister, Mary Louis Gridley and by July 7, 1860 when the federal census was taken, they had three children. The youngest, Samuel, just one month old, apparently died very young as there does not seem to be a cemetery record for him and he was not part of the family on the 1870 census.

Henry quit the shoe making trade before 1880 and became a farmer in Fox Twp, Kendall County. Fox is located due west of Kendall. Two children were at home in 1880, William H. and Minnie (Mary) E. In 1900 Henry and Mary lived with son William and daughter Minnie in Afton Township, Dekalb County where William was farming. In 1901, Henry and Mary moved to near South Haven, MI. Henry died and was buried there in 1902. Mary spent the rest of her life in Shabbona, IL mainly with youngest daughter Minnie who did not marry.

Children born Newark, Big Grove, Kendall, IL

- 1.2.8b.3.4.3.1. Margaret Augusta 1853
- 1.2.8b.3.4.3.2. Elida Ann 1855
- 1.2.8b.3.4.3.3. William H. 1860
- 1.2.8b.3.4.3.4. Samuel 1860; Died an infant
- 1.2.8b.3.4.3.5. Mary (Minnie) Estelle 1863

1.2.8b.3.4.4. **Seth BINGHAM** (Edward, Elisha, Johnathan, Abel, Thomas)

Born: 11 Oct 1825, NY

Mar: abt 1850 **Anna Eliza BROCK**; Born 3 May 1826 Spencer, Tioga, NY; Died: 9 Oct 1892, Spencer, Tioga, NY; Bur: Evergreen Cemetery, Spencer, Tioga, NY

Died: 12 Mar 1906, Spencer, Tioga, NY; Bur: Evergreen Cemetery, Spencer, Tioga, NY

Seth and Anna Eliza had not been married long when the 1850 census was taken in Spencer, Tioga Co NY as they had no children. Twenty years later, in 1870, they lived in Danby, Tompkins Co NY, a few miles north of Spencer. Their daughter, Frances (Frankie) had just married; sons John and Spencer were at home. Seth's mother, Almira, age 82, also lived with them. By 1880, Almira had died and the sons were no longer living at home, but daughter, Frankie D. Spaulding (Spaulding) and grandson, Benny S. Spaulding (Spaulding) lived with them. Seth was farming. Son John was married and lived on a nearby farm. After Anna Eliza died in 1892, Seth moved in with daughter Frances and family in Spencer, Tioga, NY.

Children

- 1.2.8b.3.4.4.1. Frances (Frankie) D. Feb 1851
- 1.2.8b.3.4.4.2. John J. Jul 1852
- 1.2.8b.3.4.4.3. Ira D. Apr 1855
- 1.2.8b.3.4.4.4. Spencer 1857

1.2.8b.3.4.5. **Abel C. BINGHAM** (Edward, Elisha, Johnathan, Abel, Thomas)

Born: Dec 1829 Spencer, Tioga, NY

Mar: **Estelle**; Born: 1840, NY; Died: bef 1900

Died: 6 Dec 1906, Chicago, Cook, IL

Abel C., or A.C. as he was called, was a physician and practiced in Harvard, McHenry, IL northwest of Chicago. In 1860, he lived in Alden. As a physician he was privileged to pay a license tax of \$10.00 on his profession in 1862 to help pay for the Civil War. In 1864 he paid the same annual tax on his profession as well as a \$1.00 tax on his new carriage, considered to be a luxury item. In 1865 his tax jumped to \$22.80: \$10.00 for the professional license, \$1 on the carriage, \$1 on a gold watch - another luxury item - and \$10.80 or 5% of \$216, the amount he earned over \$10,000.

After the war, Abel's income continued to increase. In 1870 he claimed a value of \$13,300.00 on his real estate and \$2,200.00 on his personal estate. Abel's family increased, also. He and Estelle had two daughters, Angie, age 4, and Lena age 4 months. Over the next decade, Abel's family doubled in size. At age fifty, Abel was the father of four daughters and the family had a servant girl from Prussia.

A. C.'s wife, Estelle, died before 1900. The online Illinois Death Index does not yet contain a record for her. A.C. was 70 years old and daughters Cassie and Amy C. lived at home. Cassie was a postal clerk and Amy worked at the telephone exchange.

Six years later, 1906, A.C. died age 78. The daughters moved into Chicago to live with their widowed sister Angeline. She worked as an office clerk for a publishing house and she got sister Cassie a job as bookkeeper with the same publishing house. Sister Amy C. found a job as a stenographer in an architect's office. After 1910, we lose track of the girls.

Children probably all born Harvard, McHenry, IL

- 1.2.8b.3.4.5.1. Angeline 1866
- 1.2.8b.3.4.5.2. Lena Feb 1870
- 1.2.8b.3.4.5.3. Minnie J. Aug 1873
- 1.2.8b.3.4.5.4. Cassie A. Aug 1877
- 1.2.8b.3.4.5.5. Amy C. Feb 1881

1.9a.2.3.2a.2. **Elisha BINGHAM** (John Clark, Abner, Abisha, Samuel, Thomas)

*add info: 6-56*

Mar: **Betsey FRENCH**; Died 18 Dec 1869; Bur: Plainfield Township Cemetery, Plainfield, Will, IL

Betsey probably actually died in Kendall County, IL where in 1860 she lived with grandson Silas E. Bingham. The cemetery has old and new grave stones for the family. Photos of these appear in the entry for son Elisha (1.9a.2.3.2a.2.5.) in Generation Seven.

=====

1.9a.3.7a.2c.4. **Royal Tyler BINGHAM**

*new data and addition to bio sketch 6-60*

Mar: **Amy PROCTOR** (Asa Proctor); Died: 28 Aug 1889 Fletcher, Franklin, VT@682; Bur: Binghamville Cemetery, Fletcher, Franklin, VT@682

Bur: Binghamville Cemetery, Fletcher, VT@682

Royal Tyler was a carpenter like his older brother, Nathan Robinson, and also claimed the value of his property to be about \$1,000 in 1850. @92: VT, Franklin, Fletcher: 2 In 1880, he owned a farm of 65 acres in Fletcher and he, wife Amy, and daughter Leona A. age 32 lived together. Nephew Julian Elias (1.9a.3.7a.2c.11.2.) lived with them. Julian worked on the farm. @844, @846

For over twenty years, Royal Tyler was Fletcher town secretary. He represented his district in the State Legislature 1858 - 1859 and was one of the judges of the County Court in 1862 - 1863. @833, pp. 282-84.

Children born/died Fletcher, Franklin, VT@59

1.9a.3.7a.2c.4.1. Royal Harrison Bur: Binghamville Cemetery, Fletcher, Franklin, VT@682

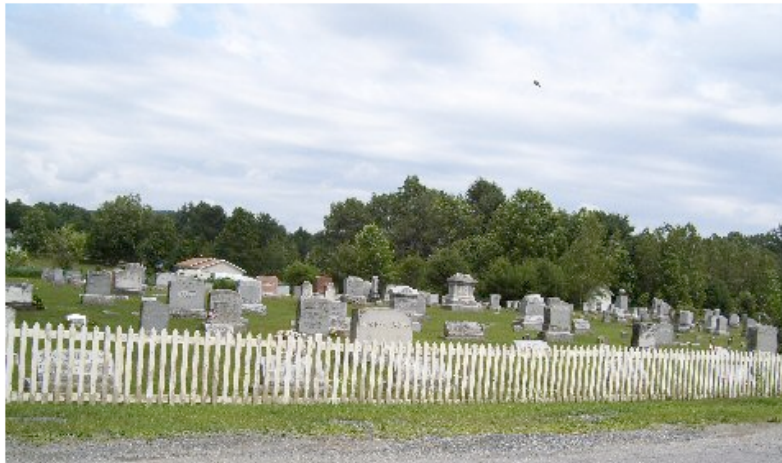

**Binghamville Cemetery, Fletcher, Franklin, VT**



*Left:  
Bingham Monument  
Binghamville Cemetery*



*Right:  
Front of Bingham Monument  
showing Royal T. Bingham  
and Amy P. Proctor  
inscription*



1.9a.3.7a.2c.5. **William Henry Harrison BINGHAM**

*wife parents, death date, addition to bio sketch: 6-60*

Mar: **Orpha R. CAMP** (Riverius Camp, Hannah Robinson)

Died: 12 Oct 1894 Stowe, Lamoille, VT.

In 1874 and 1876 William H.H. was the Democrat candidate for governor.®833, ®834 Unsuccessful in his bids, he moved his business headquarters to Montpelier in 1877 and was elected president of the Vermont Mutual Fire Insurance Company. In 1878 he ran for governor one last time, but could not overcome the strength of the Republican party in VT. That same year he became one of the directors of the state prison and house of corrections. He and Orpha had no children.

Barbara Baraw, president of the Stowe Historical Society wrote on 23 March 2008, "We have a 'Boat load of information' on the notorious W.H.H. including the history of the home he built on Main street, his holding mortgages for many town folks, his life as an attorney, his convincing the town to pay for a road half way up Mt Mansfield to his half way house/hotel, his building an hotel on top of Mt Mansfield the highest mountain in VT in 1858 before the one that took up 4 blocks in the village which was built in 1863 and burned to the ground Oct 29, 1889, and the Notch house/hotel that he built in 1869 that was open for 7 years until the porcupines chewed too much of it. Myth has it that he was known as 'Gov' because of the times he ran for governor and didn't win."

Barbara went on to say that the Big Hotel was not solvent for much of its existence. She has started to collect the land and corporate records following its ups and downs and is plotting the various lands WHH once owned at one time or another. He gave 1.5 acres to the village district to build a school with the caveat that a fence be around it at all times. That didn't last more than his lifetime. The school was used from 1861 until 1973 and is now the home of the Stowe Free Library and Helen Day Art Center.

The next time you drive to VT, stop by the Stowe Historical Society to say hello and to thank Barbara Baraw, Patricia Haslam, retired CG, and all others for the work they're doing on the Bingham (4 sons of Elias settled in Lamoille County) and their help.

=====

1.10a.2b.1.1.2. **Samuel Bingham III**®BJO

*add sentence: 6-75*

His wife is unknown but he was listed as 'widowed' on his death certificate.®BJO

1.10a.2b.1.1.6. **Emma Taylor Bingham**®BJO

*add vitals for spouse: 6-75*

Mar: 10 May 1862 **Jonathan ADCOCK** (Charles ADCOCK, Rachel ?); Born: 24 Jul 1825 ENG; Died: 1 Oct 1890®100

1.10a.2b.1.1.8. **Leander Kelly Bingham**®BJO

*substitute entry with some new info: 6-75*

Born: 17 Dec 1837 NYC

Mar: 20 Apr 1859 **Anna Maria KARR** (George Karr, Maria L. Finel) NYC; Born: 17 Jan 1839 NYC; Died: 5 Jan 1925 NYC;

Bur: Woodlawn Cemetery, Bronx NY®414

Died: 30 Oct 1909 NYC; Bur: Woodlawn Cemetery, Bronx NY®414

Leander became the principal son in the family printers' rollers business, Samuel Bingham's Sons and variants, from 1858 to his death in 1909. In the Civil War, he served briefly on two occasions in Company I of the 12<sup>th</sup> New York Militia Infantry: as a lieutenant for three months in 1861 and as a captain for one month in 1863. (military record) He lived in Manhattan and was wealthy enough to have one live-in servant in 1880 and two in 1900. Three of his sons, Charles, Herbert, and Frederick, later ran the New York portion of the company.

Children born/died NY, NY®172: T765-13

1.10a.2b.1.1.8.1. Charles 22 Jan 1860

1.10a.2b.1.1.8.2. Herbert MacKay 21 Aug 1863

1.10a.2b.1.1.8.3. Frederick Leander 19 Dec 1865

1.10a.2b.1.1.8.4. **Edward W.** 28 Oct 1870; Died: 27 Aug 1871 (obit)

1.10a.2b.1.1.8.5. Florence Karr 16 Jun 1875

1.10a.2b.1.1.8.6. Harry Sterling 1 May 1879; Died: 12 May 1899

1.10a.2b.1.1.9. **William Henry Harrison BINGHAM**®BJO

*new info shown below: 6-75*

Mar: 12 Jan 1860 **Emily C./Emma TAYLOR** (George Taylor, Emily C. Gaul) NYC; Born: 1840 England; Mar (2): Samuel

Rufus Seymour 15 June 1902 Brooklyn NY; (marriage cert); Died: 17 December 1930, Dedham MA (death cert); Bur:

Cypress Hills Cemetery, Brooklyn NY (burial record)

Children born NYC

1.10a.2b.1.1.9.1. Charlotte E. 22 Aug 1861 (death cert)

1.10a.2b.1.1.9.2. Adelaide T. 30 Jul 1863 (death cert)

1.10a.2b.1.1.9.3. Edith 1866 (census)

1.10a.2b.1.1.9.4. William H. 17 Aug 1869 (death cert)

1.10a.2b.1.1.10. **Elizabeth Shourds BINGHAM**®BJO (Samuel, Samuel, Gideon, Joseph, Thomas)

*new info: 6-75*

Born: 25 Dec 1841 NYC

Mar: 24 Nov 1864 **John T. EARLE** (John Earle, Mary ?) NYC; Born: 15 Aug 1834 NY (death record); Died: 28 February 1906,

Bristol RI (death record); Bur: North Cemetery, Bristol RI

Died: 5 November 1899 (death record); Bur: North Cemetery, Bristol RI

Elizabeth and John lived in Bristol RI after their children were born. He worked as an agent. She died of tuberculosis.

Earle children born NY

## Bingham Association UPDATE 2008-2009

- 1.10a.2b.1.1.10.1. Mary E. 1865 (1870, 1880 census); Died: after 1880
- 1.10a.2b.1.1.10.2. Carrie L. Sep 1870; Died: 1910-14 (census, husband re-marriage)
- 1.10a.2b.1.1.10.3. Annie M. Aug 1873; Died: 15 Apr 1924, Providence RI (death cert.)

### 1.10a.2b.1.1.12. **Millard Fillmore BINGHAM**@BJO (Samuel, Samuel, Gideon, Joseph, Thomas)

*significant new info: 6-76*

Born: 17 Oct 1847 NYC

Mar (1): 25 Aug 1874 **Henrietta P. MORGAN** (Charles A. Morgan, Mary E. Spencer) Brooklyn, Kings, NY; Born: 1844/5 Brooklyn, Kings, NY (census, marriage cert.); Died: 3 Jan 1898 Chicago, Cook, IL (death cert.); Bur: Rosehill Cemetery, Chicago IL (burial record)

Mar (2): 5 Apr 1899 **Anna R. MAHANEY** (William J. Mahaney, Edith Harfleigh) Harrisburg, Dauphin, PA; Born: 22 Jan 1858 Shepardsstown PA (death cert., husband military record); Died: 18 June 1930 Philadelphia PA (death cert.); Bur: Harrisburg Cemetery, Harrisburg PA (death cert.)

Died: 28 Dec 1921 Oxford MD; Bur: Rosehill Cemetery, Chicago IL (burial record)

In the Civil War, he served one month in 1863 with Company I, 12<sup>th</sup> New York Militia Infantry (with brother Leander) and 100 days in 1864 with Company A, 102<sup>nd</sup> New York National Guard Infantry in Elmira NY. (military record) Shortly after his father died, Millard left New York City to settle in Chicago and set up a branch of the family business manufacturing printers' rollers. His company did not operate under the same name as his brothers' in NYC, but was called Sam'l Bingham's Son Mfg. Co. By the time Millard died, he had branches in Atlanta, Cleveland, Dallas, Des Moines, Indianapolis, Kansas City, Minneapolis, Pittsburgh, Springfield, OH, and St. Louis. The business remained with the family until about 1957.

Children Henrietta Morgan (@172: T746-11)

- 1.10a.2b.1.1.12.1. May (Mal) Morgan 4 May 1876 NYC
- 1.10a.2b.1.1.12.2. Millard Fillmore Jr. 21 Oct 1878 Chicago, Cook, IL
- 1.10a.2b.1.1.12.3. Carl Geary 20 Feb 1880 Chicago, Cook, IL
- 1.10a.2b.1.1.12.4. Samuel Almiron 13 Jun 1882 Chicago, Cook, IL

=====

### 1.10a.2b.5.1.9. **Florinda Jane BINGHAM** (George J., Elisha, Gideon, Joseph, Thomas)

*replace entry: 6-79*

Born: 6 Apr 1847, Newport, Lake, IL

Mar (1): 7 Nov 1867 **Ezra M. BEDELL** McLean, IL@633; Born:abt 1848, NY @695; Died: 4 May 1891, Grand Island, NE @891; Bur: Grand Island, NE @891

Mar (2): **Andrew Jackson BRITTON**; Born Feb 1850 VA; Died 2 Jan 1924 Miami, Ottawa, OK

Died: 28 Dec 1936, Miami, Ottawa, OK

Ezra enlisted on August 30, 1862 at age nineteen as a Corporal in H Company 147th NY Infantry. He was captured at Gettysburg July 1, 1863, but paroled. On June 20, 1864, he was promoted to Full Sergeant and on 7 June 1865 he was mustered out giving him 2 years, 9 months, 7 days service. @676 For that service he qualified for care in the Nebraska Soldiers and Sailor's Home, Grand Island, Hall, NE. In 1890 he was enumerated there as a resident.@697 Wife Florinda applied for an invalid pension on July 15, 1889 and for a widow's pension on May 16, 1891. Brother George A. Bedell, husband of Florinda's sister, Miranda, was Ezra's guardian.@717

Sometime in the mid 1870s, Ezra and family lived in Kansas where son Elbert Eugene was born in 1874. Ezra and family returned to Lorraine, Henry, IL where he was a farmer and they were enumerated on the 1880 census, but left again after 1885 and moved to Nebraska. Lorraine, IL. A Nebraska Tract Book search shows Ezra M. Bedell owning land in sec 30, Twp 13, R 38W [Reel 11 or 12]. In less than 5 years, Ezra was a patient in the Nebraska Soldiers and Sailor's Home in Grand Island where he died in 1891.

Florinda remarried, but the date is needed. Her second husband was Andrew Jackson Britton and he had a son, Roy W. just three years younger than Florinda's Roger Sherman. They moved to Miami, Ottawa Nation, Indian Territory where they were enumerated on the 1900 census.@892 Andrew worked as a laborer most of the time and they lived there for the rest of their lives.

For undocumented dates above see "The Cade Kids" under Family Tree, Ancestry.com.

Bedell children:

1. Alantha "Allie" J.; Born: 14 May 1869, Lorraine, Henry, IL; Mar: 17 Apr 1890 George B. KELLEY; Born: 8 May 1867, RI; Died: 29 Oct 1901; Died: 10 Nov 1902, Colfax, Colfax, NM
2. Lorin L.; Born: 1871, Lorraine, Henry, IL
3. Elbert Eugene; Born: 19 Feb 1874, KS; Mar: Daisy Belle RATHBORN
4. Etta V.; Born: 1876, Lorraine, Henry, IL
5. Martha J.
6. Roger Sherman; Born: 12 Jan 1885, IL@675; Mar: Mabel M. HUTER; Chr: Smith F., Dora J., Julia M.

## Generation Seven

### CHILDREN OF IRA (Edward, Elisha, Jonathan, Abel, Thomas)

*new entry: 7-50*

#### 1.2.8b.3.4.1.4. **Sarah A. BINGHAM** (Ira, Edward, Elisha, Jonathan, Abel, Thomas)

Born: 1842, Spencer, Tioga, NY<sup>92:108</sup>

So far, all we know about Sarah is that in 1870 she lived with brother Ira Augustus.

#### 1.2.8b.3.4.1.5. **Ira Augustus BINGHAM** (Ira, Edward, Elisha, Jonathan, Abel, Thomas)

Born: May 1844, Spencer, Tioga, NY<sup>92:108</sup>

Mar (1): **Eliza Jane WILCOX**; Born: 14 May 1847; Died: 15 Sep 1883 Spencer, Tioga, NY; Bur: Evergreen Cem.<sup>915</sup>

Mar (2): **Alzoa**; Born: 13 Nov 1855, NY; Died: 13 Mar 1901, Spencer, Tioga, NY; Bur: Evergreen Cemetery<sup>915</sup>

Mar (3): **Elsie A. WATSON**; Born: 1860; Died: 1938, Spencer, Tioga, NY; Bur: Evergreen Cemetery<sup>920</sup>

Died: 1923, Spencer, Tioga, NY; Bur: Evergreen Cemetery<sup>920</sup>

Ira Augustus, fifth child, but oldest son of Ira and Sally Holdridge Bingham was first enumerated on the 1870 federal census. He lived on a farm in Spencer with wife, Eliza, and son Ira W. His sister Sarah A. and brother Seth H. lived with him, and also his mother, Sally Tompkins, who had married second, James Tompkins. By 1887-88 Ira was farming 250 acres in Spencer.<sup>830</sup> Wife Eliza Jane had died in 1883 and Ira A. had married second, Alzoa, surname unknown, but she died in 1901 age 45. By 1900 the only child left at home was son Arthur Garfield, age 20.<sup>1007</sup> Ira A. married third, Elsie Ann Watson in 1902. Elsie had a daughter Ruth Watson who in 1910 was a teacher, but in 1920 was a Doctor of Osteopathy. The three lived in Spencer and at age 75 Ira was still working as a retail merchant selling machinery and fertilizer.

Children born Spencer, Tioga, NY

1.2.8b.3.4.1.5.1. Ira Wilcox 1869

1.2.8b.3.4.1.5.2. Edward Augustus 1874

1.2.8b.3.4.1.5.3. Lewis Jay 1876

1.2.8b.3.4.1.5.4. Arthur Garfield 1880

#### 1.2.8b.3.4.1.6. **Seth H. BINGHAM** (Ira, Edward, Elisha, Jonathan, Abel, Thomas)

Born: Jun 1846, Spencer, Tioga Co NY

Seth H. did not marry. Father Ira had died when Seth was two years old and mother Sally was married again by the time Seth was twelve. Instead of living with his mother and step-father in 1860, Seth was hired out as a farm laborer to the Peter Bogart family in Spencer. In 1870, both Seth and sister Sarah, as well as mother Sally, lived with brother Ira Augustus. He must have lived with Ira for several years, helping on the farm for in 1887-88 he was listed as a farmer in the Directory of Tioga County. *[The 1880 census for Spencer has an index, only, and that is not digitized and available at this date, 10 Aug 2009.]* Seth left the farm and moved to Syracuse before 1900 for in that census year he was boarding with the Holden Cameron family on Beard Place and working as a book agent. We have no further records for Seth.

### CHILDREN OF SAMUEL H. (Edward, Elisha, Jonathan, Abel, Thomas)

*new entry: 7-50*

#### 1.2.8b.3.4.2.1. **Martin "Mart" A. BINGHAM** (Samuel H., Edward, Elisha, Jonathan, Abel, Thomas)

Born: 18 Aug 1840, Spencer, NY<sup>897</sup>

Died: 19 Aug 1925, La Salle Co., IL; Bur: Millington-Newark Cemetery, Newark, Kendall, IL<sup>897</sup>

Martin lived at home with parents and worked as a laborer in Newark until his father died in 1907.<sup>898</sup>, p. 85. Martin's sister, Mary E. Bingham Saunders, had been living at home, also, since before 1900. The two siblings remained together and in 1910 school teacher Charles Holley boarded with them. Mary, age 63, was head of household. Martin was 70.<sup>977</sup> Mary died in 1919 so Martin then went to live with cousin Marshal Bagwill and family and Marshal's unmarried sister Emily Bagwill. The Bagwills lived in Mission, LaSalle, IL.<sup>976</sup> Presumably, Martin remained there until his death in 1925.

#### 1.2.8b.3.4.2.3. **Sarah BINGHAM** (Samuel H., Edward, Elisha, Jonathan, Abel, Thomas)

Born: Jul 1844, NY

Mar: 17 Mar 1863 **Martin WILSON** (James J. WILSON, Lucy) Kendall, IL<sup>897</sup>; Born: Aug 1836, IL

Sarah was 19 when she married Martin Wilson in 1863. He was 27 and a tin smith by trade.<sup>980</sup> He was also a Civil War veteran having enlisted for a three year term on 7 Aug 1861 and assigned to company F, 36th Illinois US Infantry where he served as 2nd Lieutenant.<sup>981</sup> The Thirty-sixth Infantry was organized at Camp Hammond, near Aurora, IL. The regiment went to St. Louis for rifles and muskets and then into camp at Rolla, MO until the middle of January, 1862. It then moved to near Bentonville, AR where companies B and K participated in battles at Leestown and Pear Ridge, March 7 and 8. The regiment then camped at Keltsville Mo with other regiments comprising Col. Osterhaus' Brigade.<sup>982</sup> At this point Martin resigned and returned home.<sup>981</sup>

The Illinois state census for 1865 shows Martin, Sarah, and baby Grant living near her father, Samuel.<sup>983</sup> Within the next five years the family moved to Rutland, LaSalle County, west of Kendall, where they were enumerated on the 1870 census. Martin was still working as a "tinner" and daughter Lulu was 4 years old.<sup>984</sup>

Martin gave up tinning to become a hardware merchant in Marseilles, La Salle County before 1880. By then, both of his parents had come to live with his family and his father at 75 was clerking in the hardware store.<sup>985</sup>

We don't find Sarah and Martin again until 1910 when they are living in Aurora Ward 2, Kane County, IL. They had been married 47 years and son Grant, age 45, still lived with them. A fourth household member, Lilly Itckenburger is listed as a step-daughter, born in KS, working as a dressmaker. Sarah is named "Sallie", and is 65. Martin is 73.<sup>986</sup> We do not know where or when they died, what happened to Grant, nor who Lilly actually was.

Wilson children: 1. Grant 1865 2. Lulu 1866

1.2.8b.3.4.2.4. **Mary Elizabeth BINGHAM** (Samuel H., Edward, Elisha, Jonathan, Abel, Thomas)

Born: Aug 1849, IL <sup>989</sup>

Mar: 31 Dec 1868 **Henry M. SAUNDERS** Kendall, IL<sup>633</sup>; Born: NY

Died: 24 May 1919, Newark, Kendal, IL; Bur: Millington-Newark Cemetery<sup>897</sup>

Mary E. was 19 years old in 1868 when she married Henry M. Saunders, ten years her senior. Saunders was a tin smith in Big Grove Township. The couple eluded the 1870 census so we don't see them again until 1880 when just the two of them formed the household.<sup>978</sup> We learn from the 1900 census, however, that they had had two children both of whom died. In 1900 Mary claimed that she was married, had been for 31 years, but lived at home with her widowed father, age 83, and brother Martin, age 59.<sup>979</sup> Husband Henry lived somewhere else. In 1910, after their father died, Mary and Martin were still living together, Mary as head with her own income.<sup>977</sup> Mary died in 1919.

**CHILDREN OF HENRY** (Edward, Elisha, Jonathan, Abel, Thomas)

*new entry: 7-50*

1.2.8b.3.4.3.1. **Margaret Augusta BINGHAM** (Henry, Edward, Elisha, Jonathan, Abel, Thomas)

Born: Jan 1853 IL

Mar: 12 Oct 1876 **Henry Winthrop YOUNG** Kendall, IL<sup>626</sup>; Born: Sep 1845, MA; Died: 2 Jul 1917, Shabbona Village, DeKalb, IL<sup>921</sup>

Margaret Augusta went by her middle name, Augusta. She and Henry first lived in Milan, DeKalb County, IL where Henry farmed.<sup>988</sup> They later settled in Shabbona Village, DeKalb County where Henry listed his occupation as Police Magistrate in 1900.<sup>989</sup> By 1910 Henry and Augusta were retired and living on their own income. Sister Minnie moved in with Augusta and Henry in 1909 after the girls' mother died.<sup>990</sup> Henry died in 1917 and the two sisters continued to live together through at least 1930.<sup>987</sup>

Young children: 1. Winthrop 1878 2. Jesse A. 1880

1.2.8b.3.4.3.2. **Elida Ann BINGHAM** (Henry, Edward, Elisha, Jonathan, Abel, Thomas)

Born: Jul 1855, IL

Mar: 26 Dec 1874 **Charles Fox CRUM** Kendall, IL<sup>897</sup>; Born: 22 Oct 1846, Tioga, NY<sup>900</sup>, p. 968; Died: 7 Feb 1934, Millington, LaSalle, IL<sup>921</sup>

Died: 20 Jun 1935, Millington, LaSalle, IL<sup>921</sup>

Elida Ann and Charles Crum are difficult to follow in the federal censuses. Crum has been written or transcribed as Cronn, Crumm, and Cann and Elida has been Lida, Ludia, Ada, and Lydia A. She called herself Lida and that may well have been her original name. Lida and Charles had two children and apparently lived in Millington all of the time. Millington straddles the boarder between Kendall and La Salle counties and each portion forms part of a different statistical reporting area. Deeds need to be checked to know exactly where Lida and Charles Crum lived.<sup>991, 992, 993, 994, 995</sup>

Charles had moved to Newark, Kendall County with his parents in 1856. The parents bought land in Fox Township and Charles lived there until he was twenty-one. In 1876, he bought the farm from his parents, but sold it in 1886 and bought 130 acres of improved property adjacent to the town of Newark. He later added 40 more acres. His main farming interest was in sheep and hogs. Charles belonged to the Republican party and served as a School Director for many years.<sup>900</sup>

Crum children: 1. Maud Mar 1876 2. Frank R. Jan 1879

1.2.8b.3.4.3.3. **William H. BINGHAM** (Henry, Edward, Elisha, Jonathan, Abel, Thomas)

Born: Jul 1860, IL

Mar: 1906 **Cora R.**; Born: 1875, MI

Died: Nov 1931, Toledo, OH <sup>940</sup>

William, age 39, was unmarried in 1900. He had a farm in Afton Township, DeKalb County, IL and his sister and parents lived with him.<sup>996</sup> The 1910 federal census tells us that William had been married to Cora R. for four years, that they had one child, Mary E. age two, that William worked as a farmer, and that they lived in Reynolds Township, Montcalm County, MI. William's mothers' obituary of 1909 did not mention a wife and child, but named Howard City, MI as William's home. Howard City is in Reynolds Township. William and Cora had another child, a son, La Verne, born about 1911. WHERE was La Verne born, MI or OH? William and Cora next appear in Toledo, Lucas, OH where he was working as a printer in 1920.

Children:

1.2.8b.3.4.3.3.1. Mary Elizabeth 1908 Reynolds, Montcalm, MI

1.2.8b.3.4.3.3.2. La Verne (male) 1911

1.2.8b.3.4.3.5. **Mary “Minnie” Estelle BINGHAM** (Henry, Edward, Elisha, Jonathan, Abel, Thomas)

Born: 21 Sep 1863, Newark, Kendal, IL

Died: 10 Feb 1937, Sheridan, LaSalle, IL; Bur: Millington-Newark Cemetery, Kendall, IL<sup>897</sup>

Minnie did not marry. Essentially, she lived with her parents until they died and then with her sister Augusta.

In 1900, brother William, who also remained at home until he was over 40 years old was head of household.<sup>996</sup> After mother Mary died in 1909, Minnie lived with sister Augusta in Shabbona until after 1930.<sup>990</sup><sup>987</sup> To follow Minnie’s life in more detail see the bio-sketches for parents Henry and Mary, brother William, and sister Augusta.

**CHILDREN of SETH** (Edward, Elisha, Jonathan, Abel, Thomas)

*new entry: 7-50*

1.2.8b.3.4.4.1. **Frances “Frankie” D. BINGHAM** (Seth, Edward, Elisha, Jonathan, Abel, Thomas)

Born: Feb 1851, Spencer, Tioga, NY<sup>172</sup>: T765-13

Mar: Jan 1870 **John Smith SPAULDING** (Benjamin SPAULDING; Sarah Ann WARNER) Spencer, Tioga, NY<sup>941</sup>; Born: Mar 1850, NY

Frances went by the name Frankie much of the time and husband John Smith Spaulding had gone by the name Smith since childhood as revealed on the 1860 federal census when he was 8 years old.<sup>947</sup> In 1870, six months after they were married, they lived in the dwelling next to John Smith’s father, Benjamin Spaulding.<sup>948</sup> Where Smith was in 1880 is not known, perhaps at home in Spencer, but Frances and son Benny S. were living with her parents in Danby, Tompkins, NY.<sup>949</sup> Son Leon was born in 1892 and in 1900 the family, minus son Benny, was enumerated in Spencer. Frances’ father Seth, then a widower, lived with them.<sup>946</sup> Smith was not at home to be enumerated in 1910, but Frances and son Leon had a seventy year old boarder, George Whitney.<sup>950</sup> In 1920, Smith was at home, as was Frances. No one else lived with them. We do not know when either of them died, nor have we found either son.

Spaulding children: 1. Benjamin S. 1875 2. Leon Oct 1892

1.2.8b.3.4.4.2. **John J. BINGHAM** (Seth, Edward, Elisha, Jonathan, Abel, Thomas)

Born: Jul 1852, Danby, Tompkins, NY

Mar: **Amanda**; Born: Jul 1858, NY

Died: bef 1920, Tioga, NY

Recently married in 1880, John J. and wife Amanda lived in Danby, Tompkins, NY three dwellings away from his father, Seth. John was 27, Amanda was 25 and they were farming.<sup>949</sup> Both sons claim to have been born in Pennsylvania in the 1880s and thus appeared on the 1900 census, ages 15 and 13, with their parents, living in Owego Village, Tioga, NY. John worked as a day laborer.<sup>951</sup> In 1910 John was the proprietor of a second hand business and son Seth lived at home.<sup>953</sup> John died before 1920 when the census shows Amanda living alone in the dwelling next to son, Seth.<sup>952</sup>

Children

1.2.8b.3.4.4.2.1. Seth 1884

1.2.8b.3.4.4.2.2. William 1885

1.2.8b.3.4.4.3. **Ira D. BINGHAM** (Seth, Edward, Elisha, Jonathan, Abel, Thomas)

Born: Apr 1855, Danby, Tompkins, NY

Mar: **Stella C. DAVIS**; Born: Mar 1854, NY

Died: 1925; Bur: Evergreen Cemetery, Spencer, Tioga, NY<sup>920</sup>

Ira and Stella C. were married by 1880 when they were enumerated on the federal census living in Ithaca, Tompkins, NY next to Stella’s father. Ira worked on the farm.<sup>956</sup> They may have had three sons as some have claimed, but in 1900 Stella claimed no children and she and Ira were divorced. Stella was a farmer in Ithaca Township and had one lodger.<sup>957</sup> <sup>958</sup> The following information needs to be verified: From the census we may deduce that Ira moved to Chicago and took a job as a teamster. He lived in a dwelling on Wells Street. Brother “Spence” and a female named Clara and called “sister” lived with Ira. Spence also worked as a teamster.<sup>963</sup> However, a Spencer Bingham living in a boarding house and working as a laborer also was enumerated in Chicago in 1900. We do not know if they are one and the same as neither has been found on any later census. In 1910 Ira was recorded as a widower. He lodged on Washington Boulevard and worked as a roofer. No Spencer or Clara were to be found. Presuming that this is the correct Ira, based mainly upon age and the few Bingham with the same name, Ira remarried before 1920. His wife, Fannie, age 49, was born in KY. Ira still worked as a roofer. Cook County records a death for an Ira on 6 July 1924. His body could have been removed to Evergreen Cemetery, Spencer, Tioga, NY and buried there in 1925.

1.2.8b.3.4.4.4. **Spencer BINGHAM** (Seth, Edward, Elisha, Jonathan, Abel, Thomas)

Born: 1857, Danby, Tompkins, NY

We have very little information about Spencer. As a thirteen year old in 1870, he lived at home. He was recorded living at home in Danby, again, in 1892 when he was 35.<sup>959</sup> In 1900, Spencer may have been enumerated twice on the census, both times in Chicago. The birth dates and ages fit this Spencer Bingham, but no other. One record shows him age 42 living as a lodger on South Clinton street and working as a laborer. The other record has him living with brother Ira on Wells street

and working as a teamster. A female, Clara Bingham, recorded as sister lives with them. We can't identify Clara. Spencer then disappears from the censuses and other records online.

**CHILDREN of ABEL C.** (Edward, Elisha, Johnathan, Abel, Thomas)

*new entry: 7-50*

1.2.8b.3.4.5.1. **Angeline BINGHAM** (Abel C., Edward, Elisha, Jonathan, Abel, Thomas)

Born: 1866, IL@172: T746-11

Mar: **HORNER**

Died: 8 Jul 1917, Chicago, Cook, IL@921

Angie married before her mother died in 1900 as she was not then living at home as were her sisters Cassie and Amy. Six year later, in 1906, Angie's father died and sisters Cassie and Amy moved to Chicago to live with Angie who was a widow by then. Angie worked as an office clerk for a publishing house and helped her sisters find jobs.@969 After 1910 we loose track of the girls.

1.2.8b.3.4.5.3. **Minnie J. BINGHAM** (Abel C., Edward, Elisha, Jonathan, Abel, Thomas)

Born: Aug 1873, IL @172 T746-11

Mar: 9 Dec 1895 **Charles WILLIAMS** Alexander Co, IL@633; Born: Aug 1868, IL

Minnie was 22 years old when she married Charles Williams in 1895 in Alexander County in southern IL. In 1900 the couple lived in Curran Twp, Sangamon, IL. Charles worked as a teamster. They had been married for four years and had two children, but only one was living. After 1900 we loose track of Minnie and family.

Williams children: 1. Deceased 2. Grace N. 1898

1.2.8b.3.4.5.4. **Cassie A. BINGHAM** (Abel C., Edward, Elisha, Jonathan, Abel, Thomas)

Born: 1878, IL@172: T746-11

Cassie lived at home in 1900 with her sister Amy C. and her widowed father A.C. age 70. Cassie worked as a postal clerk and Amy worked at the telephone exchange.@1000

Six years later, 1906, A.C. died age 78.@666 The daughters moved into Chicago to live with their widowed sister Angeline. She worked as an office clerk for a publishing house and she got sister Cassie a job as bookkeeper with the same publishing house. Sister Amy C. found a job as a stenographer in an architect's office.@969 After 1910, we loose track of the girls.

1.2.8b.3.4.5.5. **Amy C. BINGHAM** (Abel C., Edward, Elisha, Jonathan, Abel, Thomas)

Born: Feb 1881 IL

We know little of Amy C. other than she lived at home with sister Cassie and widowed father A.C. when she was 19 and worked at the telephone exchange.@1000 After her father died, she moved to Chicago with sister Cassie and they both lived with widowed sister Angeline Horner. Amy found a job as a stenographer for an architectural firm.@997

=====

1.9a.2.3.1a.1.1. **Ozro G. W. BINGHAM** (Benjamin, Ripley L., Abner, Abisha, Samuel, Thomas)

*new entry: 7-54*

Born: 21 Aug 1811, Stanstead, QUE@893

Mar: **Mary Ann SAMPSON**; Born: 11 Feb 1814, Erie, NY@893

Died: 11 Dec 1867 Clayton, IA@893; Bur: Monona Cemetery, Monona, Clayton, IA@894

Ozro G. W. graduated from Rochester Medical University.@909 In 1840 he and his family lived in Glenville, Schenectady, NY. At that time his household consisted of himself, one female under five, one female 10-15, one female 15-20, and one female 30-40.@1009

The family moved to Oak Grove, Dodge County, Wisconsin before 1848, where in that year O.G.W. was practicing medicine in Beaver Dam.@938, p. 166 He had been there long enough to be honored as one of three speakers at meeting of free soil sympathizers held at Clason Prairie on 28 August 1848.@938, p. 200

Ozro is missing from the 1850 census, but in 1860 he, wife Mary Ann and two children, Arthur C. and Romeo were enumerated at Lake Mills, Jefferson County, WI.@1010 Today, I-94 runs just north of Lake Mills. Son Ozro P. was born in 1849 and buried in Rock Lake Cemetery, Lake Mills, Jefferson County. The family moved to Iowa in 1866 and Ozro G.W. died in 1867. His widow and son Arthur remained in Monona through 1870.@1011 Apparently son Arthur moved to Boardman Township after he married for in 1885 he lived there with his wife. His mother-in-law and his own mother lived together in the next dwelling.@905

*Note: Find-a-grave records 2 graves for Bingham in Rock Lake Cemetery. One is for Ozro P. with a birth date of 6 Oct 1849. The other is for death date of 30 May 1865. This could be for the same person or for two different people. We know that son Romeo was 2 years old in 1860 and that he was not alive in 1870 so the second death could be for Romeo born 1858 in WI. This needs to be checked against local WI records not online.*

**Children**

1.9a.2.3.1a.1.1.1. Ozro P. 1849-<1866; Bur: Rock Lake Cemetery Lake Mills, Jefferson, WI@682

1.9a.2.3.1a.1.1.2. Arthur C. 1852

1.9a.2.3.1a.1.1.3. Romeo 1858-<1870

=====

**CHILDREN OF ELISHA** ((John Clark, Abner, Abisha, Samuel, Thomas)

*substitute entry: 7-57*

1.9a.2.3.2a.2.1. **William Hurd BINGHAM** (Elisha, John Clark, Abner, Abisha, Samuel, Thomas)

Born: 1 Oct 1810, Lower Canada<sup>92</sup>

Mar: 22 Feb 1834 **Malvina BLY** (David Bly, Hannah); Born: 1818, NY; Died: aft 1880; Grave Marker: Plainfield Cemetery, Plainfield, Will, IL [no dates]<sup>1039</sup>

Died: abt Oct 1857, Na-an-say, Kendall, IL

William H. married while his family lived in Chautauqua Twp, Chautauqua Co NY. He was enumerated there on the 1840 U.S. census.<sup>150: 190</sup> He left NY after his son, [William] Henry, was born in 1843. The family arrived in Na-au-say, Kendall, IL soon after.<sup>901: 233</sup> Many knew him by his middle name, Hurd.<sup>900</sup> His grandson, the son of James Albert also had the middle name Hurd. On 9 May 1846, William patented 160 acres in the SW 1/4 of section 27 and on May 27, 1846 he patented 40 acres in section 28, that is the SW 1/4 of the SE 1/4.<sup>900: 695</sup> In 1848 William bought 200 A more in T36 R8 S27 and 28 in 1848 through the Chicago land office.<sup>510: Document Nos. 22628 IL 1200.097; 22802 IL 1160.073</sup> The 1859 plat map of Kendall County, published two years after William's death, shows the Bingham estate owning acreage in the northwest quarter of section 34.<sup>1014</sup> More research needs to be done on William H.'s land transactions.

The family was enumerated in Na-au-say Twp on the 1850 U. S. census. Henry Bingham, born in PA in 1827, before William H. married, lived with them.<sup>92: 256</sup> Henry was undoubtedly a younger brother. Son, Silas, age 15-16, was enumerated twice, so we know that he was going to school and working as a hired farm hand for Rufus Bohnstead. <sup>92: IL: Will: Wheatland: 52</sup> Brother, Elisha, also settled in Kendall Co.

According to the 1855 IL State Census, William's household then consisted of 1 male under 10 (James), 2 males 10-20 (H. Ozro and Henry), 1 male 20-30 (Silas E.), 1 male 40-50 (Wm. H.); 1 female under 10 [?], 1 female 10-20 (Amanda), 1 female 40-50 (Malvina). After William's death in 1857, we do not know where Malvina lived until 1880 when she appeared on the Washington, Newton, IN census living with son James and family. She was then sixty-three years old.<sup>1040</sup> Since Malvina's grave marker contains no dates, her place and date of death is unknown. Likewise, we do not know where William Hurd is buried, nor his exact date of death.

Note that the *The Bingham Family in the United States* authored by Theodore A. Bingham<sup>1</sup> assigns the wrong children to William Hurd. The correct children are given below.

Children

- 1.9a.2.3.2a.2.1.1. Silas E. 1835 NY
- 1.9a.2.3.2a.2.1.2. Hiram Ozro 1838 NY
- 1.9a.2.3.2a.2.1.3. Amanda D. 1840 NYn
- 1.9a.2.3.2a.2.1.4. William Henry 1843 NY
- 1.9a.2.3.2a.2.1.5. James Albert 1851 IL

1.9a.2.3.2a.2.5. **Elisha BINGHAM** (Elisha, John Clark, Abner, Abisha, Samuel, Thomas)

Born: 6 Aug 1819, Meadville, Crawford, PA<sup>83</sup>

Mar: 23 Dec 1847 **Elvira C. MAUDLIN** (Enoch MAUDLIN) <sup>897</sup>, Parents of the Brides and Grooms; Born: 11 Mar 1827,

Milton, Wayne, IN; Died: 8 May 1919, Plainfield, Will, IL<sup>1039</sup>; Bur: Plainfield Cemetery<sup>1039</sup>; <sup>1112</sup>

Died: 31 May 1871, Na-Au-Say, Kendall, IL <sup>1039</sup>; Bur: Plainfield Twp Cemetery, Plainfield, Will, IL<sup>1039</sup>; <sup>1112</sup>

Elisha and Elvira were married in Wayne County, Indiana just before Christmas, 1846.<sup>1114</sup> Within a year their first child, a son, was born, but soon died. Another son, born soon after, died as well. Both were buried in either Wayne or Union counties, Indiana.<sup>1114</sup> The 1850 census shows Elisha's wife, spelled Alvira, and infant son Elisha living in Union, Montgomery, IN with Elisha's sister Mary Jane Terhune and her husband, G.W.<sup>1070</sup> Elisha was not enumerated there because he had gone to California "with a group in quest of gold." On the way home, several in the party died of a deadly fever. Elisha was stricken, but survived.<sup>1114</sup>

In 1851 Elisha and Elvira left Indiana to settle in Naasay Townhip, Kendall Co., IL where Elisha's older brother, William Hurd, lived.<sup>898</sup> Daughter Mary Elinor was born in Naasay in 1852 and son Theodore in 1854, but Mary Elinor died later that year. Elisha and Elvira had another daughter in 1855 and a son in 1858. but brother William Hurd died in 1857. That left Elisha, William H.'s sons, Silas and Hiram Ozro, and Elisha's younger brother, Henry to be enumerated in Naasay in 1860.<sup>83: 95</sup> Elisha, himself, died in 1871.

Elvira was left with three young children and a mortgaged farm of 240 acres in section 26 valued at \$14,000. She kept the farm and worked for sixteen years to pay off the debt. <sup>1114</sup> Apparently she then rented the farm and moved to Plainfield, Will County in 1887. She had transferred church membership to the Plainfield Methodist Church in 1874. She lived in Plainfield the rest of her life. Her granddaughter Nettie and husband Albert Scroggins later lived on the farm, perhaps from their marriage in 1906.

Apparently Elvira kept an open welcome mat. In 1880 her children, Emma and Willard were at home. Niece, Amanda, age 40, daughter of William H., and grandniece, Anna, Amanda's daughter age seven also lived with her and she had a boarder to help with the farm.<sup>172: T746-11</sup> Through all the years, Elvira stayed in touch

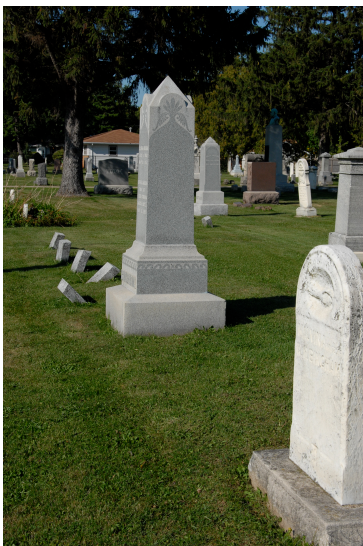

with her sister-in-law, Mary Jane Bingham Terhune and from her obtained the birth and marriage dates of brother-in-law William Hurd's children. Elvira gave a copy to Benjamin Thomas Bingham and thus preserved a valuable family set of vital records.®FFB

Elvira lived for 92 years, 1 month, and 27 days. She outlived her Bingham husband and all of her children. She is undoubtedly the one responsible for the family monument in Plainfield Cemetery.

Children

1.9a.2.3.2a.2.5.1. Calvin 1847-1848 Died as Infant

1.9a.2.3.2a.2.5.2. Elisha 1849-1850 Died as Infant

1.9a.2.3.2a.2.5.3. Mary Elinor 1852-1854 Died as Child

1.9a.2.3.2a.2.5.4. Theodore Smith 1854

1.9a.2.3.2a.2.5.5. Emma 31 Oct 1855, Naausay, Kendall, IL®172 T746-11; Died: 23 Jun 1897; Bur: Plainfield Cemetery ®1039; ®1112

1.9a.2.3.2a.2.5.4. Willard H. 1858

*Above and Right*

*Elisha & Elvira family gravestones  
Plainfield Township Cemetery,  
Will County, Illinois*

*Malvina's stone (Elisha's mother) is in foreground, alone,  
next is the large family stone  
(see close up to right)  
with Elisha and Elvira on face and deceased children on back*

*The first two small stones can't be read,  
then Father, Mother, Grandmother*



1.9a.2.3.2a.2.8. **Mary Jane BINGHAM** (Elisha, John Clark, Abner, Abisha, Samuel, Thomas)

Born: 16 Jun 1825, PA

Mar: 22 Feb 1847 **Garrett Washington TERHUNE** Union, Montgomery, IN ®1071 Born: Feb 1822, Shelby, KY;

Died: 1910, Garden City, Finney, KS

Died: 1911 - 1919

Mary Jane was the eighth of Elisha and Betsey French Bingham's eleven children. She and three or four of her sisters married in Montgomery County, IN in the 1840s.®1100 This could well mean that Elisha and Betsey lived in Indiana in the 1840s and that Elisha died there.

In 1850 Mary Jane was 22 years old and married to Garrett W. Terhune, a surname that has been transcribed in many creative ways. They lived in Union, Montgomery, IN. Brother Elisha's wife, Elvira and her infant son Elisha were enumerated with them.®1070 Elisha was in California seeking gold. (See above 1.9a.2.3.2a.2.5.)

Mary Jane and G.W.'s first son was born in 1852 and in 1859 their second son was born. In 1860 and 1870 the family lived in Rensselaer, Jasper, IN.®1072, ®1073

Before 1880, G.W. decided to try his hand at raising cattle so the family moved to Colfax, Colfax, New Mexico. Son William, already married, moved to Colfax also and lived next door, but son Frank still lived at home.®1074 Mary Jane and G.W. would have been responsible for attracting Mary Jane's nephew, Theodore, to New Mexico in the 1880s. (See below 1.9a.2.3.2a.2.5.4.)

Mary Jane and G.W. left New Mexico before 1900 and moved to Garden City, Finney, KS. Son William had died and his widow, Margaret, 61, and daughter, Maud, 21, moved to Kansas with them and lived next door. Mary Jane was 74 and G.W. was 78.®1101 Son Frank W. and family lived in Sherlock.®1077 G.W. took up the occupation of wagon maker and he and Mary Jane appear in both the 1905 Kansas State Census and the 1910 federal census living in Garden City.®1076 Son Frank W. lived in the same ward with his wife Julia G. and her son Arland W., called adopted son. Frank's occupation was Farm Day Labor.®1075

G.W. died in 1910, but a death date is needed for Mary Jane.®1102

Terhune children:

1. William Henry 1852, Crawfordsville, Montgomery, IN; Died: 1897, Garden City, Finney, KS®1104



2. Frank Wesley 1859, Rensselaer, IN; Died: 1922, Garden City, Finney, KS

**CHILDREN OF ROYAL TYLER** (Elias, Elias, Lemuel, Samuel, Thomas)

*new and enhanced entries: 7-62*

1.9a.3.7a.2c.4.2. **LeRoy Monroe BINGHAM** (Royal Tyler, (Elias, Elias, Lemuel, Samuel, Thomas)

Born: 10 Apr 1845 Fletcher, Franklin, VT

Mar: 14 Feb 1871 **Alma Maria EDWARDS** (Jonathan Judson EDWARDS) Stowe, Lamoille, VT<sup>59</sup>; Born: 19 Jan 1850, Thompsonville, CT; Died: 14 Aug 1918, Burlington, Chittenden, VT

Died: 27 Nov 1911, Burlington, Chittenden, VT

At age sixteen and just twenty-four days after Fort Sumter surrendered to the South, LeRoy enlisted in the Vermont Volunteer Militia 7 May 1861. He was assigned to Company H of the 2nd Infantry Regiment as a Private. For the next three years he saw action and was wounded in both the Battle of Chancellorsville, May 2-4, 1863, and the Battle of The Wilderness, May 5-6, 1864. He mustered out as Corporal on 29 June 1864.<sup>676</sup>, <sup>785</sup> After LeRoy died in 1911, wife Alma applied for a widow's pension.<sup>786</sup>

After the war, LeRoy attended the academy at Stowe, the Normal School at Johnson, VT, and the New Hampton School at Fairfax, VT. He then studied medicine at the University of Vermont and received his M. D. degree in 1870 when he was twenty-five. He remained in Stowe for four more years practicing medicine and acting as Superintendent of Schools. After the birth of his second child he moved his family to Burlington, VT where he practiced for his remaining career, mainly as attending surgeon at the Mary Fletcher Hospital. He was also Surgeon General of the State of Vermont in 1880 and on the Anatomy and Surgery faculty of the University of Vermont Medical School.<sup>833</sup>, pp. 282-84 The family lived at 110 College Street in Burlington, but by 1910 lived at 49 Williams Street.<sup>822</sup>

After LeRoy's death, widow Alma and daughter Amy moved to 165 Prospect where they were in 1916.<sup>841</sup>

Children

1.9a.3.7a.2c.4.2.1. Harry LeRoy 6 Jun 1872 Stowe, Lamoille, VT

1.9a.3.7a.2c.4.2.2. Mary Alma 27 Nov 1873, Stowe, Lamoille, VT<sup>59</sup>; Died: 16 Aug 1884, Burlington, Chittendon, VT<sup>59</sup>; Cause of death: peritonitis<sup>59</sup>

1.9a.3.7a.2c.4.2.3. Amy Belle 19 Jul 1878, Burlington, Chittendon, VT<sup>59</sup>

1.9a.3.7a.2c.4.2.4. William 1882-1882; Cause of death: premature<sup>59</sup>

1.9a.3.7a.2c.4.2.5. Royal Edwards 2 Jan 1885, Burlington, Chittendon Co VT

1.9a.3.7a.2c.4.3. **Amy Leona BINGHAM** (Royal Tyler, (Elias, Elias, Lemuel, Samuel, Thomas)

Born: 29 Jul 1847, Fletcher, Franklin, VT

Mar: Unmarried

Died: 1927, Fletcher, Franklin, VT<sup>682</sup>; Bur: Binghamville Cemetery, Fletcher, Franklin, VT<sup>682</sup>

Amy Leona went by the name of Leona A. She lived at home in Fletcher, probably until both of her parents died. In 1900 she was head of the household that included her younger sister Emma and Emma's husband Horace Thomas. [Note that as of 4 April 2008 these names were transcribed incorrectly in the Ancestry.com version of the U.S. Census for 1900. Leona was Leo and Thomas was Dhamas.] Leona was listed as a merchant of general merchandise.<sup>849</sup> She continued in this occupation through 1910 when nephew Leroy T. Kinsley lived with her and worked as a clerk in a hardware store.<sup>850</sup> Perhaps this was Leona's store? By 1920, Leona had retired and moved to Barton, Orleans County where she lived with grandniece Amy Leona Gelo and family.<sup>851</sup> Leona died in 1929 and was buried in Binghamville Cemetery near Fletcher.

1.9a.3.7a.2c.4.4. **Ella Lenora BINGHAM** (Royal Tyler, (Elias, Elias, Lemuel, Samuel, Thomas)

Born: 8 Jun 1851, Fletcher, Franklin, VT

Mar: 10 Apr 1872 **Rufus KINSLEY** Fletcher, VT; Born: 9 Oct 1831, Fletcher, Franklin, VT; Died: 11 Jun 1911, Lowell, Orleans, VT<sup>JLCK</sup>, <sup>1008</sup>

Died: 13 Sep 1909, Lowell, Orleans, VT<sup>JLCK</sup>

Ella's husband Rufus Kinsley was twenty years older than she. As an eighteen year old, Rufus worked as a printer in St Albans, Franklin, VT.<sup>852</sup> Ten years later, age twenty-eight, he and his brother were simply enumerated as laborers living with farmer Edger Montague in Fletcher.<sup>853</sup> Shortly after the Civil War began, Rufus enlisted as a Corporal. He was assigned to Company F, 8th Infantry Regiment on 18 February 1862. He was discharged for promotion to Full 2nd Lieutenant and commissioned in Company B, 74th Infantry Regiment U.S. Colored Troops on 1 October 1863. He remained with the Colored troops until he resigned from the army 18 July 1865.<sup>676</sup> Rufus returned to live with the Montagues where in 1870 he was again enumerated as a farm laborer.<sup>854</sup>

On the Special Schedule of surviving Civil War veterans taken in 1890, Rufus claimed a total length of service of 3 years, 7 months, 14 days. He also claimed injury to his legs and ribs and that he had incurred chronic diarrhea, the most common complaint of all veterans. <sup>564</sup>, Roll 105, p. 1.

Ella and Rufus were married in 1872 and had seven children in the next eleven years, six boys and one girl. On their farm, actually located in Lowell, they had 17 dairy cows and a sugar orchard of 500 trees.<sup>855</sup>

Five of the children were still living at home in 1900. Daughter Amy, at 24, was a teacher and Lester, at 22, was at school. Leroy worked in a shop and Guy worked on the farm.

Ella died in 1909, but in 1910 Rufus and the two youngest boys were still working the farm.<sup>856</sup>

Kinsley children born Lowell, Orleans, VT [Note JLCK = <sup>1008</sup>]

1. Clayton Bingham 29 Sep 1873; Died: 15 Nov 1956, St Johnsbury, VT<sup>JLCK</sup>

2. Benton Allen 14 Sep 1874; Died: 12 Aug 1907, CHINA<sup>JLCK</sup>

## Bingham Association UPDATE 2008-2009

3. Amy Leona 4 Apr 1876; Mar: Elmer GELO; Died: 28 Nov 1939, Barton, VT@JLCK
4. Lester Montague 6 Nov 1877@JLCK; Died: 1949
5. Leroy Tyler 17 Mar 1879@JLCK; Died: 1947
6. Floyd Guy 15 Sep 1881; Died: 15 Dec 1946, Montpelier, VT@JLCK
7. Chellis Alonzo 13 Sep 1884; Died: 21 Oct 1939, Hancock, VT@JLCK

### 1.9a.3.7a.2c.4.5. **Emma Martha BINGHAM** (Royal Tyler, (Elias, Elias, Lemuel, Samuel, Thomas)

Born: 31 Oct 1852 Fletcher, Franklin, VT

Mar: 17 May 1892 **Horace THOMAS** Fletcher, Franklin, VT@59; Born: Mar 1856, VT; Died: 1904; Bur: Binghamville Cemetery, Fletcher, Franklin, VT@682

Died: 1904 Fletcher, Franklin, VT; Bur: Binghamville Cemetery, Fletcher, Franklin, VT@682

Emma was forty years old in 1892 when she married Horace Thomas age thirty-six. Before that Emma had worked as a housekeeper or servant. In 1880, she worked for Renselie and Phebe Bailey in Fletcher.@848 In 1900 the couple lived with Emma's older sister Leona in Fletcher. Horace was a farmer.@849 Only four years later, in 1904, they both died. A cause of death is needed.

=====

## **CHILDREN OF LUCIUS** (Erastus, Jedediah, Lemuel, Samuel, Thomas)

*new entry: 7-59*

### 1.9a.3.5a.10a.2.2. **Lillie/Lilly BINGHAM** (Lucius, Erastus, Jedediah, Lemuel, Samuel, Thomas)

Born: 24 Mar 1851, Vernon, Jennings, IN

Mar: 20 Feb 1872, Kendall, IL@633 **William CULBERTSON**; Born: abt 1852, NY; Died: 1908, Fowler, Benton, IN

As a 19 year old in 1870, Lillie was enumerated in two places. She lived with her mother in Normal, IL in June and in July with cousin Amanda D. in Montana, Labette, KS and worked for her as a domestic servant.@1034, @1048 Two years later, in IL, Lillie married William Culbertson. Their daughter, Ruby, was born in 1873 in IN, but in 1880 the family lived in Worthington, Nobles, MN.@1035

Culbertson child: Ruby 1873 IN

=====

### 1.10a.2b.1.1.8.1. **Charles BINGHAM**@BJO

*add new info: 7-75*

Born: 22 Jan 1860 Williamsburgh, Kings, NY (birth record)

Mar: 24 Oct 1882 **Helen E. LAWRENCE** (John Lawrence, Ann E. Frost) NYC; Born: 17 Apr 1861, East Morrisania NY (death cert, marriage cert); Died: 2 July 1930 New Rochelle NY (death cert.); Bur: Woodlawn Cemetery, Bronx NY (burial record)

Died: 18 June 1947 Yonkers NY (death cert.); Bur: Woodlawn Cemetery, Bronx NY (burial record)

Children

1.10a.2b.1.1.8.1.1. Marion L. 4 Sep 1884 (unmarried, at home 1936)

1.10a.2b.1.1.8.1.2. Helen F. 25 Jun 1889 (unmarried, at home 1936)

### 1.10a.2b.1.1.8.2. **Herbert MacKay BINGHAM**@BJO

*add new info: 7-75*

Born: 21 Aug 1863 NYC

Mar (1): 8 Jul 1886 **Kate M. PRICE** (William H.C. Price, Julia A. Darby) NYC; Born: Jul 1864, Auburn AL (census, death cert);

Died: 27 Oct 1904 NYC; Bur: Woodlawn Cemetery, Bronx NY. (burial record)

Mar (2): 25 Oct 1909 **Cornelia E. STRASSBURG CARROLL** (August Strassburg, Caroline Ruppert) NYC; Born: 4 Jan 1882

Brooklyn, Kings Co NY (passport application); She Mar (1) 11 Feb 1901 William J. CARROLL NYC (marriage cert); Mar (3):

30 Jun 1921 **Joseph Elias OPPENHEIMER**; Mar (4): 18 Sep 1926 James Bruce KREMER (marriage cert); Died: 15

May 1974 Washington DC (obit); Bur: Rock Creek Cemetery, Washington DC (burial record)

Died: 2 Dec 1914 NYC; Bur: Woodlawn Cemetery, Bronx NY. (burial record)

Herbert worked in the family business, Bingham Brothers printers' rollers, and then was president from 1891 until his death in 1914. He lived in Manhattan most of his life but lived in northern NJ in the latter part of the 19<sup>th</sup> century. He died of cancer.

Children Kate Price born Nutley NJ (birth certs)

1.10a.2b.1.1.8.2a.1. Dorothy P. 9 Jul 1888

1.10a.2b.1.1.8.2a.2. Kathryn E. 2 Nov 1894

Adopted step children Cornelia Carroll: (census, vital records)

1.10a.2b.1.1.8.2b.1. Herbert MacKay Jr. (originally August J. Carroll)

1.10a.2b.1.1.8.2b.2. Stuart A. (originally William J. Carroll)

1.10a.2b.1.1.8.2b.3. J. Ruppert (originally J. Ruppert Carroll)

### 1.10a.2b.1.1.8.3. **Frederick Leander BINGHAM**@BJO

*new vital records: 7-75*

Born: 19 Dec 1865 Morrisania NY (family history, gravestone, marriage cert)

Mar: 23 Oct 1888 **Margaret Wright LEGGETT** (John W. Leggett, Mary E. Huggins) NYC; Born: 1864 NYC (gravestone, marriage cert); Died: 13 Nov 1936 NYC (death cert); Bur: Woodlawn Cemetery, Bronx NY (burial record)

Died: 3 May 1934 NYC (death cert); Bur: Woodlawn Cemetery, Bronx NY. (burial record)

1.10a.2b.1.1.8.5. **Florence Karr BINGHAM**®BJO *new vitals for husband: 7-75*  
Mar: 24 Oct 1905 **Victor HARRISON-BERLITZ** (Howard Harrison, Beatrice Carpanette/Calperneti) NYC; Born: 6 Nov 1864  
Naples, Italy (death cert); Mar (1): 5 Nov 1898 Bertha Berlitz NYC (marriage index); Died: 16 Nov 1932 NYC (death cert);  
Bur: Woodlawn Cemetery, Bronx NY (burial record)

=====

**CHILDREN OF WILLIAM HENRY HARRISON**®BJO (Samuel, Samuel, Gideon, Joseph, Thomas) *new entry: 7-75*

1.10a.2b.1.1.9.1. **Charlotte Emily BINGHAM**®BJO (William H.H., Samuel, Samuel, Gideon, Joseph, Thomas)  
Born: 22 Aug 1861 NYC (death cert)  
Mar (1): 4 Sep 1880 **William J. KENNEDAY** (William D. Kenneday, R.A. Gregg) NYC (marriage cert); Born: 1855 NY (marriage  
cert); Died: 15 Feb 1891 Brooklyn, Kings, NY (death cert); Bur: Cypress Hills Cemetery, Brooklyn NY  
Mar (2): 1892 **Rhodes Green TUCKER** (Henry G. Tucker, Frances A. Fisher) (census); Born: 1 Jul 1856 Providence RI (RI birth  
index); Died: 18 Jan 1944 Wellesley MA (death cert); Cremated: Forest Hills Crematory, Boston MA; Bur: North  
Burying Ground, Providence RI  
Died: 18 Mar 1940 Dedham MA (death cert); Cremated: Forest Hills Crematory, Boston MA; Bur: North Burying Ground,  
Providence RI

1.10a.2b.1.1.9.2. **Adelaide Taylor BINGHAM**®BJO (William H.H., Samuel, Samuel, Gideon, Joseph, Thomas)  
Born: 30 July 1863 NYC (death cert)  
Mar: 11 Dec 1890 **Mortimer S. BROWN** (Joseph C. Brown, Harriet L. Fagg) Brooklyn, Kings, NY (marriage cert); Born: 28  
Feb 1861 Brooklyn, Kings, NY (death cert); Died: 24 Mar 1943 Brooklyn, Kings, NY (death cert); Bur: Cypress Hills  
Cemetery, Brooklyn NY (burial record)  
Died: 8 Feb 1934 Brooklyn, Kings, NY (death cert); Bur: Cypress Hills Cemetery, Brooklyn NY (burial record)  
Brown children  
1. Charles T. 5 Sep 1891 Brooklyn NY (death cert); Died: 3 Sep 1950 Binghamton NY (death cert)  
2. Mortimer S. 15 Oct 1896 (SSDI, census); Died: 29 Jun 1980 (burial record)

1.10a.2b.1.1.9.4. **William Henry BINGHAM**®BJO (William H.H., Samuel, Samuel, Gideon, Joseph, Thomas)  
Born: 17 AUG 1869 NYC (death cert)  
Mar: 1892/3, **Adelaide T.** (census); Born: c. 1870 MI (census); Died: after 1932  
Died: 29 March 1932 Shaker Heights, Cuyahoga, OH (death cert); Bur: Hudson MI.(death cert)  
William and Adelaide, or W.H. and A.T. as they sometimes called themselves, lived in Lakewood west of Cleveland.  
William worked as a foreman in a factory in 1920 and in 1930 he was working as a manager of printers' supplies.  
Child  
1.10a.2b.1.1.9.4.1. William H. c.1906 PA (census) lived at home through 1930 working as a bank auditor

=====

1.10a.2b.1.1.12a.1. **May/Mae Morgan BINGHAM**®BJO (Millard F., Samuel, Samuel, Gideon, Joseph, Thomas) *new info: 7-75*  
Mar: 25 May 1914 **Richard E. MANDERS** (James Manders, Emma J. ?) Cambridge, Dorchester, MD (marriage cert); Born: 14  
Jan 1892 Oxford MD (WWI draft card); Mar(2): Bertha ?; Died: 1955 (gravestone); Bur: Springhill Cemetery, Easton MD  
(burial record); Died: aft 1942®780  
Died: 2 May 1924 Oxford, Talbot, MD (death cert); Bur: Springhill Cemetery, Easton MD (burial record)  
Richard was a farmer and driver on the Eastern Shore of Maryland.

1.10a.2b.1.1.12a.2. **Millard Fillmore BINGHAM Jr.**®BJO (Millard F., Samuel, Samuel, Gideon, Joseph, Thomas) *new info: 7-75*  
Mar: 20 Jul 1903 **Leila FEATHERSTONE** (John Featherstone, Ida M. Howe) Chicago, Cook, IL(marriage cert); Born: 25 Aug  
1883 IL (CA Death Index); Died: 29 Nov 1958, Santa Monica, CA (CA Death Index); Bur: Valhall Cemetery, St. Louis MO  
Died: 25 Apr 1948 Chicago, Cook, IL (death cert); Bur: Rosehill Cemetery, Chicago  
IL (burial record)  
Millard managed the family factory in St. Louis for over a decade and retired as vice president and general manager of  
Samuel Bingham Sons Manufacturing Company in Chicago.  
Children born MO (death certs)  
1.10a.2b.1.1.12a.2.1. Millard Fillmore III 21 Jul 1904  
1.10a.2b.1.1.12a.2.2. Fred Parker 28 Feb 1907  
1.10a.2b.1.1.12a.2.3. Leila Ruth 18 Jul 1914

1.10a.2b.1.1.12a.3. **Carl Geary BINGHAM**®BJO (Millard F., Samuel, Samuel, Gideon, Joseph, Thomas) *new info: 7-75*  
Mar (1): 20 Jan 1902 **Mary Norris SIMON** Bur: Rosehill Cemetery, Chicago IL (burial record)  
Mar (2): 1956 **Esther NELSON JOHANIGMAN** (Swen Nelson, Minnie Anderson); Born 14 Dec 1890 IL (death cert); She mar  
(1): Sterling E. Johanigman; He died 19 Nov 1953 Cook, IL; Died: 19 Jan 1970 Highland Park IL (death cert); Bur:  
Skokie IL (death cert)  
Died: 23 Jul 1959 Highland Park IL; Bur: Rosehill Cemetery, Chicago IL (burial record)  
Carl was president of Samuel Bingham Sons Manufacturing Company in Chicago. His first wife and mother of his children

was a graduate of Vassar College.

1.10a.2b.1.1.12a.4. **Samuel Almiron Bingham** @BJO (Millard F., Samuel, Samuel, Gideon, Joseph, Thomas) *new info: 7-75*  
 Mar: 18 Feb 1908 **Rose M. SEYMOUR** (Charles E. Seymour, Anne Dearden) Springfield MA (mar cert); Born: 26 Jun 1882  
 Springfield MA (death cert); Died: 9 Mar 1955 Tryon, Polk Co NC (death cert)  
 Died: 2 Aug 1959 Tryon, Polk Co NC (death cert); Bur: Calvary Church Cemetery, Fletcher NC (death cert)  
 Samuel graduated from Cornell University in 1905 and worked in the family printers' rollers business, serving as secretary of Samuel Bingham's Sons Manufacturing Company in Chicago for many years.

=====

1.10a.4a.1.10.3a.7. **Henry William BINGHAM** (George E., Nathan, Elijah Jr., Elijah, Joseph, Thomas) *replace entry: 7-83*  
 Born: 29 May 1840, Claremont, Sullivan, NH  
 Mar: 27 Mar 1862 **Josephine BURY**; Born: Nov 1844 NY; Died: 8 Jul 1930 Livingston, Park, MT@1118; Bur:  
 Mountain View Cemetery, Livingston MT (see photo: M. Bury is Margaret, Josephine's mother)@998  
 Died: 26 Dec 1892 Livingston, Park, MT; Bur: Mountain View Cemetery, Livingston, MT@998

Born in New Hampshire, Henry moved with his father and step-mother from PA to MN shortly after 1850. In March 1862, Henry married Josephine Bury and they lived in Faribault, Rice, MN. When the 2nd Minnesota Cavalry Regiment called for volunteers, Henry enlisted as a First Lieutenant on 4 Jan 1864. He was assigned to Company G. The regiment spent its first five months at Fort Snelling, MN then rendezvoused with other troops near Fort Sully on the Missouri River before setting out to control hostile Indians and make the area safe for homesteaders. The regiment sought out Indians in the Badlands and patrolled the frontier until the promoted to Captain in November of rank 29 December 1865. To *Minnesota in the Civil and Indian 1890*, available on Google Books.

Henry returned to Faribault where census recorded his two male age 3/12. Babe soon was named switched from the grocery business had been prominent in developing since the 1860s and had more than to sons Harry, now 13, and Arthur, and born in the Dakota Territory, household also had two male



end of 1865. Henry had been 1864, thus was mustered out at that read more about the Indian Wars see *Wars, 1861-1865, Volume I*. St. Paul,

he worked as a grocer in 1870. The children as Harry, age 3 and Babe, Arthur C. By 1880 Henry had to flour manufacturing. Faribault technology for the flouring process one large flour mill. In addition 10, nephew Joseph C. Hinman, age 5 lived with Henry and Josephine. The boarders.

In 1888 Josephine applied for a was enumerated on the Veterans veterans living in Livingston, Park, MT. Two years later, Henry was dead and buried in Mountain View Cemetery. Josephine and family remained in Livingston where in 1900 she was a notions merchant and her two Hinman nephews who lived with her were salesman and clerk. Her mother, Margaret, her daughter in-law, Bertha, widow of son Arthur, and her grandson, child of Arthur, also lived with her.

Civil War pension and in 1890 Henry Schedules along with several other

Nephew Joseph Hinman lived with Josephine until she died in 1930, age 85. The 1920 census taker mixed names recording Josephine with surname Hinman and Joseph with given name John. Grandson Arthur Henry had married and set up housekeeping on his own in Livingston. Joseph continued in his trade as salesman of books and stationery.

Children

- 1.10a.4a.1.10.3a.7.1. Babe 1864 (died before named)
- 1.10a.4a.1.10.3a.7.2. Harry T. 1867 NAI
- 1.10a.4a.1.10.3a.7.3. Arthur C. 1870

=====

1.10a.4b.9a.2.5a.7. **Elbert Howard BINGHAM** (Albert M., Horace, Vine, Elijah, Joseph, Thomas) *new info and bio sketch 7-86*  
 Born: 4 Sep 1872, Mt Morris, Livingston Co NY@211  
 Mar: 1901 **Ruth Mary**; Born: 1875, NY  
 Died: Mar 1958, MI@820

So far, the earliest information we have on Elbert is his 1908 application for a passport. He gave his residence as Detroit, MI and occupation as chemical engineer. He described himself as having a high forehead, gray eyes, and medium brown hair. Ruth M. Bingham, his wife, signed as witness. [Misentered in index to as Albert H.]

On the 1910 census, Elbert's occupation was listed simply as Engineer. His household had three white, female servants from Canada and a trained nurse to help care for his four young children.

Howard was doing well financially for by 1920 he was a manager and could still afford three servants for his family of six children. Judging by their surname, the servants were sisters and two had been with the family for ten years or more. One was a cook, one a servant, and one a housemaid. The family lived on Jefferson Ave.

An entry in TAB claimed that in 1925, Elbert lived in Birmingham, Oakland Co., MI. From Polk's 1928-29 Detroit City Directory, we do know that the family lived at 8122 St Paul Street, Detroit and that Marion lived at home and worked as a clerk for Union Trust Company. The other girls who were at home in 1930, that is all but Clara, did not work. Elbert was President of a cement manufacturing company.

Children born Detroit, Wayne, MI<sup>881</sup>  
1.10a.4b.9a.2.5a.7.1. Marion Starr 1902  
1.10a.4b.9a.2.5a.7.2. Howard Murray 1904  
1.10a.4b.9a.2.5a.7.3. Clara 1907  
1.10a.4b.9a.2.5a.7.4. Margaret Ruth 1909  
1.10a.4b.9a.2.5a.7.5. Nancy 1912  
1.10a.4b.9a.2.5a.7.6. Elizabeth (Betty) 1915

## Generation Eight

**CHILDREN OF IRA AUGUSTUS** (Ira, Edward, Elisha, Jonathan, Abel, Thomas)

*new entry: 8-56*

1.2.8b.3.4.1.5.1. **Ira Wilcox BINGHAM** (Ira A., Ira, Edward, Elisha, Jonathan, Abel, Thomas)

Born: 1869, Spencer, Tioga, NY

Mar: 11 Jun 1913 **Lula May Bass ROOT** New Orleans, LA<sup>914</sup>; Born: 3 Apr 1883, Baton Rouge, East Baton Rouge, LA; Died: Jun 1972, Baton Rouge, East Baton Rouge, LA<sup>820</sup>

Died: 12 Sep 1939, E. Baton Rouge, LA<sup>916</sup>

Between the 1870 census for Spencer, Tioga, NY, taken when Ira was 10 months old and the 1920 census taken when Ira was a farm manager in Louisiana, we have not found a record for him other than his marriage to Lula May Bess Root in 1913 in Louisiana. A granddaughter, Carol Bingham Hicks, noted that her father, that is, the son of this Ira Wilcox was born in WI in 1915 and that he and his parents moved to Louisiana from Portage WI in 1917.<sup>1003</sup> That places this Ira Wilcox in WI in 1915. Most accurately, they did not move to LA in 1917, but they *moved back* to Louisiana in 1917 since this Ira Wilcox was in LA in 1913 to marry Lula Root. Ira's occupation as a farm manager may help explain the move back and forth from LA to WI since he may have moved frequently. But, he may also have been a practicing minister in WI. However, after he returned to LA in 1917 he remained there where he was enumerated in 1920 and 1930 in Wilson, East Feliciana.<sup>1001</sup>, <sup>1002</sup> He had one son also named Ira Wilcox. The Louisiana Statewide Death Index, 1900-1949 places the title Reverend before Ira's name. At the time of his death, he lived in E. Baton Rouge Parish. In 1944-1945, after WW II, Lula rented out rooms at 136 E. Boyd, Baton Rouge. <sup>918</sup>.

Child

1.2.8b.3.4.1.5.1.1. Ira Wilcox 1915

1.2.8b.3.4.1.5.2. **Edward Augustus BINGHAM** (Ira A., Ira, Edward, Elisha, Jonathan, Abel, Thomas)

Born: 1874, Spencer, Tioga, NY

Mar: 1906 **Augusta RODGERS**; Born: 1878; Died: 1963; Bur: Evergreen Cemetery, Spencer, Tioga, NY<sup>920</sup>

Died: 1971 Spencer, Tioga, NY; Bur: Evergreen Cemetery, Spencer, Tioga, NY<sup>920</sup>

Edward was a public school teacher. He was 32 years old when he married in 1906. The earliest record we have for him at this point is the 1910 census when he, wife Augusta, and son Clifton lived in Van Etten, Chemung, NY.<sup>1005</sup> Edward apparently gave up teaching and returned to Spencer to farm sometime before 1920.<sup>1006</sup> Since the 1930 census for Spencer is missing, we have no further information about Edward other than his death date and place.

Children born NY

1.2.8b.3.4.1.5.2.1. Clifton A. 1908

1.2.8b.3.4.1.5.2.2. Keith Leroy 1911

1.2.8b.3.4.1.5.3. **Lewis Jay BINGHAM** (Ira A., Ira, Edward, Elisha, Jonathan, Abel, Thomas)

Born: 20 Jul 1876, Spencer, Tioga, NY<sup>970</sup>

Mar: 20 Jul 1907 **Florence Marion STRAIGHT** (Wellington STRAIGHT, Marion Wyman TISDEL) Pittsburgh, Allegheny, PA<sup>970</sup>; Born 13 Oct 1880, Hudson, Summit, OH<sup>970</sup>; Died: 25 Aug 1927, Boise, ID<sup>970</sup>

Died: 1953 Seattle, King, WA<sup>970</sup>

Lewis was Ira Augustus' third child, born when Ira was 32 and Eliza was 29. His mother died when he was barely seven years old. His father remarried thereafter, and that woman would have been Lewis's main mother-figure. We have no further information about Lewis until 1910 when he was 34 years old and married with one newborn child. He and family lived in Kirksville, MO. The census taker recorded that he had no occupation, which was technically correct for the era.<sup>972</sup> However, he was a student at Kirksville School of Osteopathy, now called the A.T. Still University, Kirksville College of Osteopathic Medicine. Lewis graduated with his Doctorate in Osteopathy that year (1910) and from then on could call himself a D.O.<sup>975</sup>

By 1912 he had returned to NY and set up practice in Ithaca. We know this because his only child at the time, Lewis J. Jr. died in Ithaca 31 Aug 1912, age 2.<sup>970</sup> Lewis and wife Florence had two more children: Marion in 1915 and Wellington in 1917. The family still lived in Ithaca in 1920.<sup>971</sup>

Neither Lewis, Florence, nor Wellington show up on the 1930 federal census so we do not yet know where they were living, then. However, sometime before 1953, when Lewis died, the family moved to Seattle, King, WA. One of Florence's grand

## Bingham Association UPDATE 2008-2009

nephews, Robert S. Straight, wrote about his 1952 visit when they lived in Seattle. His comments are posted at [awt.ancestry.com](http://awt.ancestry.com).

### Children

1.2.8b.3.4.1.5.3.1. **Lewis J. Jr.** 21 Mar 1910 Kirksville, Adair, MO; Died 31 Aug 1912 Ithaca, Tompkins, NY@970

1.2.8b.3.4.1.5.3.2. Marion Tisdell 1915 Ithaca, Tompkins, NY@971

1.2.8b.3.4.1.5.3.3. Wellington Straight 1917

1.2.8b.3.4.1.5.4. **Arthur Garfield BINGHAM** (Ira A., Ira, Edward, Elisha, Jonathan, Abel, Thomas)

Born: Mar 1880 or 20 Jul 1876, Spencer, Tioga, NY@1007, @970

Mar: **Fannie M.**; Born: abt 1885; Died: 1929; Bur: Evergreen Cemetery, Spencer, Tioga, NY@920

Died: 1965; Bur: Evergreen Cemetery, Spencer, Tioga, NY@920

Arthur probably lived in Spencer, Tioga, NY his entire life. His two children were born there, he was there in 1920, and he was buried there.

Children born Spencer, Tioga, NY

1.2.8b.3.4.1.5.4.1. Kenneth L. 1906

1.2.8b.3.4.1.5.4.2. Robert Ira 1912

=====

**CHILDREN OF JOHN J.** (Seth, Edward, Elisha, Jonathan, Abel, Thomas)

*new entry: 8-56*

1.2.8b.3.4.4.2.1. **Seth BINGHAM** (John J., Seth, Edward, Elisha, Jonathan, Abel, Thomas)

Born: 24 Jun 1884 PA

Mar: **Rachel T.**; Born: 1884; Died: 1955; Bur: Evergreen Cemetery, Spencer, Tioga, NY@920

Died: Jul 1971, Poughkeepsie, Dutchess, NY@820; Bur: Evergreen Cemetery, Spencer, Tioga, NY@920

Seth was twenty-five in 1910, still living at home and working as a signalman for the Erie R.R.@953 He married Rachel about 1914 and they had two daughters before 1920. He had given up the railroad job and worked as a merchant in a store in Owego, Tioga, NY. His wife's two step sisters lived with them and mother Amanda, a widow, lived in the next dwelling.@952

### Children

1.2.8b.3.4.4.2.1.1. Virginia 1915

1.2.8b.3.4.4.2.1.2. Helen 1916

1.2.8b.3.4.4.2.2. **William BINGHAM** (John J., Seth, Edward, Elisha, Jonathan, Abel, Thomas)

Born: Jul 1885 PA

Mar: 1912 **Myrtle BAUER** (Martin L. BAUER; Emma E.); Born: 1885, NY

William married Myrtle in 1912 when he was 27. She had two children from a previous marriage to a Crandell dating from 1904. In 1920 the family lived in a rented home in Owego, Tioga, NY. William was the proprietor of a glove company.@954 The children were gone by 1930 and William and Myrtle had moved in with her parents. William was working as an upholsterer in a chair factory and Myrtle worked there, also. Her son, James J. was also part of the extended family. He was a postal clerk.@955

=====

**CHILD OF OZRO G.W.** (Benjamin, Ripley L., Abner, Abisha, Samuel, Thomas)

*new entry: 8-58*

1.9a.2.3.1a.1.1.2. **Arthur C. BINGHAM** (Ozro G.W., Benjamin, Ripley L., Abner, Abisha, Samuel, Thomas)

Born: Aug 1852, Janesville, Rock, WI@895

Mar: 7 Jan 1875 **Amanda McGONIGLE** (Bartemus McGONIGLE, Catherine) Monona, Clayton, IA@893; Born: 26 Aug 1848,

Monona, Clayton, IA@893; Died: abt 1918; Bur: Maple Grove Cemetery, lot 8, block 69, division 3, Dodge City, Ford, KS@896

Died: abt 1918; Bur: Maple Grove Cemetery, lot 7, block 69, division 3; Dodge City, Ford, KS@896

Arthur's first job at age 18 in 1870 was clerk in a dry goods store.@902 He worked as a merchant for the next fifteen years or so, but on the 1900 census he claimed to be a music teacher. He then lived in Alliance, Box Butte, NE.@906

Arthur married in 1875 and lived with his wife in her parent's home in Monona, Clayton, IA. By 1880 he had taken up the lightning rod business and traveled around the midwest selling. In 1880 he was enumerated both in IA and in St Paul, MN in a boarding house. An A. Bingham fitting the vitals for his Uncle Amander (1.9a.2.3.1a.1.2.) was enumerated at the same residence in MN.@903, @904

Arthur moved his wife and daughter Ellen to Boardman Township, Clayton, IA before 1885. His mother and his wife's mother lived together next door.@905 Ellen was born in 1882 as she was 3 years old in 1885. After their stay in Alliance, Box Butte, NE where he was a music teacher in 1900, they settled in Dodge City, Ford, KS before 1910.@893 @908, @907

### Child

1.9a.2.3.1a.1.1.1.1. Helen Maud/Ellen 1882-<1900@895

=====

**CHILDREN OF WILLIAM HURD** (Elisha, John Clark, Abner, Abisha, Samuel, Thomas)

new entry: 8-60

1.9a.2.3.2a.2.1.1. **Silas E. BINGHAM** (William H., Elisha, John Clark, Abner, Abisha, Samuel, Thomas)Born: abt 1834 NY<sup>92</sup>Mar: 17 Mar 1856 **Elizabeth BELFIELD McKEWEN** Kendall, IL<sup>546</sup>; Born: 24 Mar 1824, Oneida Co, NY<sup>83, 897</sup>;Mar (1): John McKewen<sup>633</sup>; Died: 2 Dec 1902, Seward, Kendall, IL<sup>627</sup>; Bur: Seward Mound Cemetery<sup>897</sup>Died: 14 Dec 1889, Plattville, IL; Bur: Seward Mound Cemetery<sup>897</sup>

Silas arrived in Kendall Co. in 1843 with his parents when he was 8 years old. He married in 1856 less than two months before his twenty-first birthday. His wife, Elizabeth was older than he by six years and had been married to John McKewen in 1851. An 1859 plat map of Seward Twp shows Silas with acreage in parts of sections 3 and 10.<sup>1014</sup> The 1876 *Biographical Directory of Kendall County, Illinois* claimed that Silas owned 200 acres in sections 3 and 10 valued at \$10,000, the same location as the 1859 plat map.<sup>898: 68</sup> The 1860 census continues to place Silas and family in Seward Township. His grandmother Betsy Bingham age 71, b. Mass lived with him. Silas was 25, Elizabeth 31, Lucy 3, William 5/12.<sup>628</sup>

When the Civil War broke out, Silas enlisted on September 7, 1861 in Company C, 4th IL Cavalry for a three year period. He was ranked as corporal. He served his three years at the same rank and mustered out November 3, 1864. The regiment fought in the battles of Fort Donelson and Shiloh and then did guard duty in various places until it was sent to Vicksburg where it remained until October 1864.<sup>1016</sup> His Civil War Detail Report describes Silas as 5' 8" tall with black hair and gray eyes.<sup>981</sup>

The 1865 Illinois state census showed Silas back home in Seward Township and the 1870 federal census likewise placed him at home in Seward, Kendall, IL, with both children at home.<sup>983@629</sup> Silas does not seem to be enumerated on the 1880 census and his obituary tells us that he died on 25 Dec 1889.<sup>625</sup>

Wife Elizabeth continued to live on the farm. In 1900 her son, William, and her brother, Isaac Belfield, lived with her. She claimed to have had four children, but only two were living.<sup>1017</sup>

Children born Seward, Kendall, IL

1.9a.2.3.2a.2.1.1.1. Lucy Ann 1857

1.9a.2.3.2a.2.1.1.2. William H. 1859

1.9a.2.3.2a.2.1.2. **Hiram Ozro BINGHAM** (William H., Elisha, John Clark, Abner, Abisha, Samuel, Thomas)Born: May 1838 NY<sup>92</sup> <sup>1020</sup>Mar: 15 Oct 1867 **Laura STARKWEATHER**<sup>633</sup>; Born: 1 Apr 1844, IL; Died: 30 Apr 1891, Benton Co, IN; Bur:Mount Gilboa Cemetery, Fowler, Benton, IN<sup>682</sup>Died: aft 1900; Bur: Millington-Newark Cemetery, Millington, Kendall, IL<sup>682</sup>

Hiram O. served in Company C, 4th IL US Cavalry during Civil War along with his brother, Silas. Although younger than Silas, he was promoted to Full Sergeant, served his three years, and mustered out 3 November 1864. He was single when he enlisted and described as 5' 10" with black hair and gray eyes.<sup>981</sup> [Note: Other Civil War databases use both Hiram and Harvey for Hiram's first name. In fact, on the federal census he is variously named Hiram O., Harvey O., H.O., and H. Oswell. Dates and names of family members identify him as one and the same.]

After returning home he married Laura Starkweather using the name Harvey O. in 1867.<sup>633</sup> The child Elma, 6 years old in 1870, may or may not have been his daughter and may or may not have been 6 years old.. Harvey/Hiram and family lived in Nausay, Kendall, IL and an Ela Gustin, also 6 and James Bingham, 20, his youngest brother, lived with him.<sup>1018</sup> Laura came from a very large family and the family entry in the 1850 census when Laura was 6 is not clear as to her parents.<sup>1052</sup> In 1860, age 16, Laura and older sister Elizabeth/Lizzie worked as Domestic in the Jas Whitlock household. Whitlock was a farmer in Nausay, Kendal, IL.<sup>1053</sup>

In 1880, under the name H. Oswell, Hiram and family lived in Union, Benton County, IN where he had moved between 1871-1875 judging by the ages of his children and where they were born as recorded on the census.<sup>1019</sup> An Elen M. Preston, 13, and a Silas O. Bingham age 17, b. IL, unidentified, lived with the family.

Wife Laura died in 1891 and Hiram did not remarry. In 1900 we find him visiting or living with daughter Clara in Harrison, Kootenai, ID. His name was written as Harvey O. Bingham, and reported to be a widower and father-in-law of head of household Wayne Bridgeman. Bridgeman's wife, Clair, fits the age and birth place of Hiram's daughter Clara as does Harvey's fit Hiram's. Harvey/Hiram's occupation was "Land Lord." Walter and Clara lived in Harrison ID through at least 1930, but Harvey/Hiram does not appear on later censuses. See Clara's entry for more details.

Children:

1.9a.2.3.2a.2.1.2.1. Elma 1864 NAI

1.9a.2.3.2a.2.1.2.2. Clara Edna 1871

1.9a.2.3.2a.2.1.2.3. Florence B. 1875; 1880 census: Union, Benton, IL, age 5; NAI

1.9a.2.3.2a.2.1.2.4. Hattie G. 1879; 1880 census: Union, Benton, IL, age 1; NAI

1.9a.2.3.2a.2.1.3. **Amanda D. BINGHAM** (William H., Elisha, John Clark, Abner, Abisha, Samuel, Thomas)Born: 2 Apr 1838, Chautaugua, NY<sup>92</sup> IL: Kendall: 256Mar: 29 Sep 1860, **George W. GEAR** Will, IL <sup>633</sup>; Div: abt 1874; Born: 30 Sep 1839, MA; Died: 21 Jul 1912,Liberty, Labette, KS <sup>682</sup>; Bur: Montana Cemetery; Mar 2nd 5 Jun 1875 Elizabeth Hannah Parlett, Labette, La-bette, KS<sup>1055</sup>Died: 29 Aug 1896, Seward, Kendal, IL <sup>897</sup>

Amanda married George Gear/Geer when she was 20 years old. 633 He was working as a farm laborer for William Caton in Plainfield, Will, IL. He claimed to be 28 years old and born in Canada, but neither his age nor his birth place were given that way on ensuing censuses until 1920.1059 The couple apparently lived in Illinois through 1869, if the birthplaces of their three oldest children are accurate. By 1870 they had moved to Montana, Labette, KS where they were enumerated on the census. Cousin Lillie/Lilly Bingham (1.9a.3.5a.10a.2.2.), age 18, lived with them and worked as a Domestic.1048 Their fourth child, Anna, was born in Montana, KS in 1873.

Surprisingly, the Kansas State Census taken in March 1875 shows George and the children, but not Amanda.1049 And then we learn that George married Elizabeth Parlette on 5 June 1875.1055 Were it not for the D under marital status after Amanda's name on the 1880 census, we would question the sources. In fact, in 1880, Amanda and daughter Anna lived with Aunt Elvira Bingham, wife of Uncle Elisha in Nausay, Kendall, IL.1036 Daughter Lizzie, age 10, lived in Jackson, Will, IL with 1st cousin Lucy Ann Bingham Shearer. Lizzie was classed as a servant!1047 George Gear and his new wife, Elizabeth, their 3 year old daughter, Josie, and his two sons by Amanda, William and George lived in Labette, KS.1054 Son George died in 1882, but George and Elizabeth had another daughter, Mattie, that same year.682 Next we learn from a very inaccurate newspaper obituary that Elizabeth was killed in an unusual horse and buggy accident in 1888. Son Benjamin Harrison Gear was an infant. Grandmother Catherine Parlett took the baby and changed his name to Gear Parlett.1060 Elizabeth's two daughters probably went to live with other relatives.

Amanda and other family members moved to Joliet, Will, IL and in 1891 lived at 509 Herkimer. Daughter Lizzie and son William H. lived with her. William worked at IL Steel Co.1050 Amanda's brother James Albert also lived with them and worked in 1889 and 1890 at Joliet Steel Plate Co and 1891 at Fox Solid Pressed Steel Co.1051

George and William, both of whom were probably partially responsible for Elizabeth's accident show up in Precinct 6 {Sheridan Lake}, Kiowa, CO in 1900. Both were recorded as widowed and farmers. George owned the farm and house mortgage free. His birth date was recorded as Sep 1836 and birth place as MA.1057 William had married Elizabeth Findlay in 1894. She was from Seward, Kendall, IL. She died in childbirth August 1895 and their infant son died two months later in October. They are both buried in Seward Mound Cemetery, Kendall, IL.897

William H. Gear, widower, remained in Colorado, farming, until he moved to Phoenix, AZ sometime before he died in 1929. On the 1920 federal census, he reported his father's birthplace as Canada and his mother's as New York.1058 His father, George Gear, returned to Montana, Labette, KS where, in 1910 he lived with daughter Jossie Jones, her husband Nicholas W. Jones and their nine children.1056 He died two years later in 1912. His daughter, Mattie/Martha had married photographer John Harris Wright and lived in St. Louis in 1910. Son Benjamin Harrison Gear married and remained in KS.1055

Amanda was only 56 years old when she died in Seward, Kendall, IL, probably while living with daughter Lizzie and John Findlay.

#### Gear children

1. William H. 1862-1929
2. George W. 1864-1882
3. Elizabeth "Lizzie" 1869-1941
4. Anna 1873

#### 1.9a.2.3.2a.2.1.4. **William Henry BINGHAM** (William H., Elisha, John Clark, Abner, Abisha, Samuel, Thomas)

Born: Jul 1842, NY92, 1029

Mar: 2 Sep 1863 **Eliza A. MUDGETT**, Kendall, IL897, Marriages By Grooms (A1: 107);

Born: 1848, IL; Died: 19 Jan 1927, Cass, IN; Bur: Spring Creek Christian Cemetery, Metea, Cass, IN682

Died: 28 Dec 1921, Cass, IN682; Bur: Spring Creek Christian Cemetery, Metea, Cass, IN682

William Henry was a baby when his family arrived in Nausay, Kendall, IL in 1843. He did not serve in the Civil War, but did marry in 1863 when he was 20 years old.897 We cannot find him on the 1870 U.S. Census, so 1880 is the earliest record we have at this time. The family then lived in Union, Benton, IN. William H. worked as a farmer and his three children were at home. The two oldest were born in IL and the youngest in IN so we know that the family lived in IL through 1869 and had moved to IN by Dec 1872.1028

By 1900 at age 56 William was Superintendent of the Benton County Farm and lived in the town of Center. The farm had fifteen inmates. The children were no longer at home.1029

From the County Farm, William went to work on a horse farm in Cass County, IN. In 1910 he was recorded under the name Henry on the federal census. He and wife Eliza lived on Perrysburg Road in Clay.1026

William retired before 1920 and moved to Logansport, Cass, IN where his son James lived three dwellings away.1027

#### Children

- 1.9a.2.3.2a.2.1.4.1. Silas B. 1865 IL
- 1.9a.2.3.2a.2.1.4.2. James G. 1869 IL
- 1.9a.2.3.2a.2.1.4.3. Katie J. 1872 IN





1.9a.2.3.2a.2.1.5. **James Albert BINGHAM** (William H., Elisha, John Clark, Abner, Abisha, Samuel, Thomas)

Born: 1851, Kendall, IL

Mar: 18 Oct 1871 **Julia E. STEELE** Kendall, IL<sup>633</sup>; Born: abt 1854, IL; Died: 1890 Joliet, Will, IL; Bur: Oakwood Cemetery

Died: 1891 Joliet, Will, IL; Bur: Oakwood Cemetery

In 1870, age 20, James lived with brother Hiram Ozro in Naasay, Kendal. IL.<sup>1018</sup> The next year he married Julia Steele in Kendall County. They went to Leadville, their hand at gold mining. Daughter Cornelia, in claimed Leadville as her 1872 birth place although Silver was not discovered in Leadville until 1874. Washington, Newton, IN where James farmed and shows that James and Julia had two children and 1882, James bought his own 120 acre farm in Albert Hurd, was born in Minooka, Grundy, IL in twice before he moved to Joliet, Will, IL to work in brother William Henry at 509 Herkimer Street in Between 1890 and 1891 he changed companies and



Colorado soon after their marriage, perhaps to try her obituary written by niece Johana Henderson, that information never appeared on a census.<sup>1088</sup> Before 1875, the family had returned east to daughter Florence was born. The 1880 census his mother, Malvina, lived with them.<sup>1040</sup> In Washington Township. A third child and only son, 1883.<sup>780</sup> James returned to Leadville once or the steel mills. He lived with sister Amanda and 1889 and worked at Joliet Steel Plate Co.<sup>1051</sup> went to work for Fox Solid Pressed Steel.<sup>1050</sup> Julia

had died in 1890 and James died in 1891, one researcher claims of typhoid fever. When he died, he owned a two story house in Joliet and the 120 acre farm in Indiana. He left two children under 10 (Albert and Mabel), 16 year old Florence and 19 year old Nelli.

Children

1.9a.2.3.2a.2.1.5.1. Cornelia 1874

1.9a.2.3.2a.2.1.5.2. Florence 1876

1.9a.2.3.2a.2.1.5.3. Albert Hurd 1883

1.9a.2.3.2a.2.1.5.3. Mabel White 1885

Above: James Albert Bingham

Left: Julia Elizabeth & James Albert

(Source: Barb McEntire, *Pubic Member Stories* Ancestry.com)



**CHILDREN OF ELISHA** (Elisha, John Clark, Abner, Abisha, Samuel, Thomas)

*new entry: 8-60*

1.9a.2.3.2a.2.5.4. **Theodore Smith BINGHAM** (Elisha, Elisha, John Clark, Abner, Abisha, Samuel, Thomas)

Born: 24 Feb 1854, IL

Mar: 20 Dec 1882 **Ella M. BECKWITH** (Peter BECKWITH; Betsey BEHRENS) Kendall, IL <sup>630</sup>; Born: 15 Apr 1849, IL; Died: 10 Jun 1902, Plainfield, Will, IL <sup>1039</sup>; Bur: Plainfield Cemetery, Plainfield, Will, IL <sup>1039</sup>; <sup>1112</sup>

Died: 13 Oct 1906, Plainfield Will, IL <sup>1039</sup>; Bur: Plainfield Cemetery, Plainfield, Will, IL <sup>1039</sup>; <sup>1112</sup><sup>1115</sup>

Theodore was Elisha and Elvira's fourth child, but the first to survive beyond the age of three. The middle initial S. stood for Smith. He was 17 years old when his father died in 1871. His mother kept the family farm and the *Biographical Directory of Kendall County* has him and his brother and sister all at home in 1874 or 1875.<sup>898</sup> In 1880, by the time he was 26 years old, Theodore was working as a hired hand on David Morison's farm in Lisbon.<sup>1096</sup>

In Dec 1882 Theodore married Ella M. Beckwith. She was born in NY in 1849. The couple soon went to New Mexico where according to the 1900 census they were in 1887 when daughter Elvira B. was born and her twin brother was stillborn.<sup>1043</sup> For three and a half years Theodore and Ella lived in Raton, near Colfax and aunt Mary Jane Terhune and husband G.W. Terhune. The Terhunes had left Indiana to try raising cattle in New Mexico and probably convinced Theodore that there was work available for a ranch hand. (see 1.9a.2.3.2a.2.8.)

Theodore and Ella returned to Illinois in 1888. The 1900 census places them on Division Street in Plainfield not far from Theodore's mother, Elvira. Theodore had the job of Sexton of the Plainfield Cemetery and his house was next to the cemetery. <sup>1043</sup> Wife Ella died in 1902 and Theodore died four years later in 1906. That left daughter Elvira with no parents age 19, but ten days earlier she had married.<sup>1115</sup>

Child

1.9a.2.3.2a.2.5.4.1. Elvira B. 1887

1.9a.2.3.2a.2.5.4.2. ~~Male Twin~~ 1887 (stillborn)

1.9a.2.3.2a.2.5.6. **Willard H. BINGHAM** (Elisha, Elisha, John Clark, Abner, Abisha, Samuel, Thomas)

Born: 19 Oct 1858 Naasay, Kendall, IL <sup>172</sup> T746-11

Mar: 17 Feb 1885 **Elizabeth FIDDYMENT** (Fred FEDDYMENT; Catherine) Kendall, IL <sup>546</sup>; Born: 5 Nov 1862, Will, IL;

Died: 17 Oct 1944, Joliet, Will, IL <sup>1039</sup>; Bur: Plainfield Cemetery, Plainfield, Will, IL <sup>1039</sup>

Died: 28 May 1897, Plainfield, Will, IL <sup>1039</sup>; Bur: Plainfield Cemetery, Plainfield, Will, IL <sup>1039</sup>; <sup>1112</sup>

We know very little about Willard. He lived at home, farming, until after 1880.<sup>1036</sup> He married in 1885, but was dead by 1900 so we have no further census record for guidance. Wife Elizabeth and daughter Nettie lived on Center Street in Plainfield, Will, IL in 1900.<sup>1098</sup>

Child

1.9a.2.3.2a.2.5.6.1. Nettie E. 1886

=====

**CHILDREN OF LEROY MONROE** (Royal Tyler, Elias. Elias, Lemuel, Samuel, Thomas)

*new entry: 8-63*

1.9a.3.7a.2c.4.2.1. **Harry LeRoy BINGHAM** (LeRoy Monroe, Royal Tyler, Elias. Elias, Lemuel, Samuel, Thomas)

Born: 6 Jun 1872, Stowe, Lamoille, VT

Mar: 29 Aug 1914 **Amy L. GRIFFITH** (Clarence Melvin, Ida B.); Born: Sep 1892 Waterbury Village, Washington, VT@875;

Died: 19 Jul 1979 Seminole, FL@868

Died: 20 Nov 1929, Burlington, Chittenden, VT

Harry was still single at age 37 when he appeared on the 1910 U.S. census living in a residence hotel in Waterbury, Washington County, VT. He gave his occupation as electrician.@835 In 1914 he married a woman twenty years younger and they had two children. The family lived in Waterbury and Harry worked as a foreman in the talc mine.@836 Presumably this was the Waterbury Talc Mine doing extensive underground mining on four levels until 1955. The mine took up to twelve valid minerals out of the ground including talc [[www.mindat.org/loc-22506.html](http://www.mindat.org/loc-22506.html)]. A death certificate would indicate if Harry's death was related to his work in the mine.

Wife Amy lived in Watertown in 1930 with her three children and her mother Ida B. Griffith who worked as a seamstress at the Vermont State Hospital. She also had a lodger and was the census taker.@837

Children

1.9a.3.7a.2c.4.2.1.1. LeRoy Melvin 3 Feb 1916

1.9a.3.7a.2c.4.2.1.2. Elizabeth Bolling 19 Dec 1919

1.9a.3.7a.2c.4.2.1.3. Ann 1921, unmarried, alive 2004, lived Huntsville AL@838

1.9a.3.7a.2c.4.2.3. **Amy Belle Proctor BINGHAM** (LeRoy Monroe, Royal Tyler, Elias. Elias, Lemuel, Samuel, Thomas)

Born: 19 Jul 1878, Burlington, Chittendon, VT@59

Amy lived with her parents in Burlington at 110 College and then 49 William, probably until shortly after 1911 when her father died. Amy was then thirty-three years old. @822 By 1916, she and her mother had moved to another home at 165 Prospect.@841 Her mother died in 1918, but Amy and brother Royal E. stayed on at 165 Prospect until sometime after 1920.@842

For a few years in the 1920s Amy worked at Carson College in Pennsylvania. We know this because an Amy Proctor Bingham, age 40, born Burlington, Chittenden, VT arrived in New York on 3 Sept 1923 from Southampton on the ship Orduna. She gave her address as Carson College, Flourtown, PA.@876 Robert N. Carson, a Pennsylvania railway and traction magnate founded Carson College as "a rural children's village for poor, white orphan girls." The school opened in 1917. In 1965 it was reincorporated as Carson Valley School to provide special education and treatment services for emotionally disturbed/behaviorally disordered students. In 2008 Carson Valley merged with the Children's Aid Society and now functions as a non-profit child welfare agency. [[www.carsonvalley.org](http://www.carsonvalley.org)].

By 1930, Amy had probably moved to NYC and taken a job as a supervisor in the social industry. Her age of fifty-one, her single marital status, and birthplace of Vermont all fit the 1930 census description.@845

We also know that in 1931 Amy went to France and arrived back in NYC on 7 Sept. The ship was the Pennland, pictured here. Amy was the only Burlington and Vermont resident on the ship. Further, we know it was this Amy because her date of birth was listed on the passenger list of U. S. Citizens on the ship. There were only 30 U S Citizens on the ship.@843



1.9a.3.7a.2c.4.2.5. **Royal Edwards BINGHAM** (LeRoy Monroe, Royal Tyler, Elias. Elias, Lemuel, Samuel, Thomas)

Born: 2 Jan 1885, Burlington, Chittendon, VT

Mar: 1915 **Florence/Florina B. BARLOW** Burlington, Chittenden, VT@655; Born: 1885, VT

Died: 26 Dec 1941, Burlington, Chittendon, VT@59

Royal was enumerated twice on the 1910 federal census. His parents reported him as living at home, 49 William Street, and he also appeared as a lodger in Rutland Ward 2 where he worked as a machinist at the railroad shop.@822, @857, @858 By 1916, Royal was back in Burlington living at 454 S. Union and working as a bookkeeper with B T Co [Burlington Trust?]. @841 In 1917 when he registered for the World War I draft, Royal Edwards was 33 and a bank teller at the Chittenden County Trust Co in Burlington. He was married to Florence Barlow, sometimes also called Florina. They were the same age, thus both were married when age 30. In 1920 Royal and Florina lived at 165 N Prospect, the home that Royal's mother had owned after his father died. Royal was still a bank teller. Sister Amy lived with them as a boarder.@842 The children were not enumerated.

By 1930 Royal had become an automobile dealer worth \$10,000. They still lived at 165 No Prospect and Royal was now the owner. They had a radio - a question asked on the 1930 census.

Children

1.9a.3.7a.2c.4.2.5.1. Ruth 18 Feb 1918@JLCK

1.9a.3.7a.2c.4.2.5.2. Royal Edwards Jr. 1 May 1920@859

=====

1.10a.2a.3.10.1.4.5. **Seth Daniels BINGHAM Jr.**

*new for bio sketch: 8-68*

**Seth Bingham's** organ works are being recorded by **Christopher Marks** for the Raven CD label as the first integral set of the prolific New York City composer's organ music. The premiere of the series, entitled, Organ Music of Seth Bingham: Vol. 1 Unto The Hills, is currently available online for immediate delivery from [www.RavenCD.com](http://www.RavenCD.com) for \$14.98 with free delivery worldwide, and will be released through record stores and other outlets in May. The complete set of recordings of **Bingham's** organ works are anticipated to comprise two additional CD's.

The first CD volume includes four major suites published in the period 1937 to 1951: *Pastoral Psalms*, op. 30; *Five Pieces*, op. 36; *Baroques*, op. 41; and *Variation Studies*, op. 54. The well-known "Rhythmic Trumpet" and "Bells of Riverside" are among the pieces in these suites that also include similarly colorful works.

"The organ music of **Seth Bingham** (1882-1972) represents a unique intersection between the French symphonic style and an American outlook and sensibility," said **Marks**, "and is evident in the 1923 Casavant organ he designed for his New York church." **Bingham** was organist of Madison Avenue Presbyterian Church in New York City 1913-1951.

The 1923 organ at MAPC was entirely replaced by a new Casavant in 1961, requiring a symphonic organ similar to the original organ on which **Bingham** played to be used for the recording. **Marks** recorded *Unto The Hills* on the very large **Schoenstein** organ of symphonic inspiration built in 1997 at First Plymouth Congregational Church in Lincoln, Nebraska, able to utilize the special tonal and dynamic effects as suggested in the music.

**Marks** said that the great surprise on the first volume is the musical quality of the least known *Variation Studies*, op. 54. "It is hard to imagine why the *Variation Studies* have largely escaped notice," he said. "This well-crafted set of variations on an original theme explores a staggering variety of styles, registrations, and textures. The piece was dedicated to Harold Gleason and edited and fingered by Catharine Crozier."

**Seth Daniels Bingham** composed many works for orchestra, choir, organ, chamber ensembles, and voice throughout a distinguished career as professor of composition at Columbia University 1920-54 and lecturer at the School of Sacred Music of Union Theological Seminary 1953-1965. A student of **Horatio Parker** (composition) and **Harry Benjamin Jepson** (organ) at Yale, he taught theory and composition there from 1907-1919 and received the Heald Prize with poet **Brian Hooker** in 1907 for creating the Yale song, "Mother of Men." In Paris and Berlin 1906-07, he studied with **Vincent d'Indy**, **Alexandre Guilmant**, and **Charles-Marie Widor**, and met and married the musician Blanche Guy of Paris. He returned to France frequently for family visits, allowing him to maintain an active acquaintance with French composers of the time, including **Widor**, **Vierne**, **Dupré**, **Duruflé**, **Langlais**, and others, allowing him to be credited with introducing the French style of organ to the U.S. Though his music shows the influence of these French composers, there is also an unmistakably American quality to his music—the occasional folk-like theme, jazz-influenced harmonies, and in his later music, a certain angularity and dissonance that was part of the mid-century American sound.

He served the American Guild of Organists as vice--president, Chairman of the Convention and Expansion Committee, and as a member of the AGO Examination Committee. He received an honorary doctorate from Ohio Wesleyan University in 1952 and thereafter was known as "Doctor Bingham." according to family members.

**Christopher Marks** is assistant professor of organ at the University of Nebraska, Lincoln, having moved there in 2006 from a similar post at Syracuse University where he had served since 1999. Marks will coordinate the first Pipe Organ Encounter Advanced (for advanced students of the AGO's Pipe Organ Encounters Program) sponsored by the AGO, to be hosted by the Lincoln, Nebraska, Chapter, July 6-11, 2008. An endowed scholarship in memory of **Seth Bingham** helps to support student enrollment in Pipe Organ Encounters.

In celebration of the release of this historic CD, **Bingham's** great- grandson, **Noah Albrecht**, has created a website devoted to the composer: [www.sethbingham.com](http://www.sethbingham.com)

=====

**CHILDREN OF CHARLES** @BJO(Leander, Samuel, Samuel, Gideon, Joseph, Thomas)

*new entry: 8-70*

1.10a.2b.1.1.8.1.1. **Marion L. BINGHAM** (Charles, Leander, Samuel, Samuel, Gideon, Joseph, Thomas)

Born: 4 Sep 1884 NY

Died: 22 Sep 1961 (burial record); Bur: Woodlawn Cemetery, Bronx NY (burial record)

1.10a.2b.1.1.8.1.2. **Helen F. BINGHAM** (Charles, Leander, Samuel, Samuel, Gideon, Joseph, Thomas)

Born: 25 Jun 1899 NY (SSDI, census)

Mar: **John A. BOURNE** (John Bourne, Mary ?); Born: 21 Aug 1876 (WWI draft card, gravestone); Mar (1): Esther L.; Died: 14 Aug 1960 (burial record); Bur: Woodlawn Cemetery, Bronx NY (burial record)

Died: 12 Feb 1992 (burial record); Bur: Woodlawn Cemetery, Bronx NY (burial record)

=====

1.10a.2b.1.1.8.2a.1. **Dorothy P. BINGHAM**@BJO (Herbert M., Leander, Samuel, Samuel, Gideon, Joseph, Thomas)

*new info: 8-70*

Born: 9 Jul 1888 Nutley NJ (birth cert)

Mar: 14 Sep 1912 **Arthur D. CAMP** (William S. Camp, Anne Curtis) NYC; Born: 25 July 1881 CT (WWI draft card, census); Mar (2): Philippine Huss, OH (gravestone); Died: Sep 1965 NY (social security death index)

Died: 16 Mar 1931 Lakewood City, Cuyahoga Co OH (death cert); Bur: Woodlawn Cemetery, Bronx NY (death cert)

Bingham Association UPDATE 2008-2009

1.10a.2b.1.1.8.2a.2. **Kathryn Elise BINGHAM**@BJO (Herbert M., Leander, Samuel, Samuel, Gideon, Joseph, Thomas) *new info: 8-70*  
Born: 2 Nov 1894 Nutley NJ (birth cert)  
Mar: 2 Oct 1916 **Raymond J. DAVIS** (John Davis, Cora A. Dury) NYC; Born: 24 Jan 1894 Kent, Litchfield, CT (WWI draft card); Mar (2): Otilie Zenker; Died: 7 Jan 1980 Dade City, Pasco Co FL (death cert)  
Died: 5 Jan 1919 Kent, Litchfield, CT (death cert); Bur: Woodlawn Cemetery, Bronx, NY (obit)

=====

1.10a.2b.1.1.12a.2.1. **Millard Fillmore BINGHAM III**@BJO (Millard F. Jr., Millard F., Samuel, Samuel, Gideon, Joseph, Thomas) *new info: 8-71*  
Born: 21 Jul 1904 St Louis, MO (death cert)  
Mar: **Gladys J. SWINFORD** (William R. Swinford, Rebecca B. ?); Born: 22 Sep 1904 Hammond, IN@876; Died: 7 Oct 1995 Springfield, Sangamon, IL@208  
Died: 16 May 1975 Gardner, Sangamon, IL (death cert); Bur: Valhalla Cemetery, St. Louis MO (death cert)

Millard was a twenty year old student at Cornell University in 1924 when he filled out his first passport application for a trip to England and France.@880, 1092, 876 Millard next sailed in 1930 on an eighteen day cruise departing and returning New York. This time new wife Gladys was with him. He gave his address as Chicago, but Gladys' address was Indianapolis.@876

Between 1930 and 1964 we know nothing of this family. However, in 1964 Millard and Gladys bought the David Frackelton house in Petersburg, Menard County, IL. Presumably, Millard would have been retiring at this time and looking for a project. He found that project in the complete restoration of this house which happened to be a perfect example of Victorian architecture.@1111 Unfortunately, Millard died before he saw the house placed on the National Register of Historic Places in 1976 as part of the new Petersburg historic district.@1117; @DGBM

Children

1.10a.2b.1.1.12a.2.1.1. Deborah; Mar: WHEELER

1.10a.2b.1.1.12a.2.1.2. Millard Fillmore IV; Died 1967 Perersburg, Menard, IL@1111

1.10a.2b.1.1.12a.2.2. **Fred Parker BINGHAM**@BJO (Millard F. Jr., Millard F., Samuel, Samuel, Gideon, Joseph, Thomas) *new info: 8-71*  
Born: 28 Feb 1907 St Louis, MO (death cert)  
Mar (3): 16 May 1964 **Vivian Freda CHESTER CARROLL** (Albert B. Chester, Celesta M. Enzor) CA (CA marriage index); Born: 5 May 1921 OH (death cert); Died: 26 Nov 2002 (death cert); Cremated and ashes scattered  
Died: 8 Jul 2000 Morro Bay CA (death cert); Cremated: 13 Jul 2000 (death cert)

1.10a.2b.1.1.12a.2.3. **Leila Ruth BINGHAM**@BJO (Millard F. Jr., Millard F., Samuel, Samuel, Gideon, Joseph, Thomas) *new info: 8-71*  
Born: 18 Jul 1914 St Louis, MO (death cert)  
Mar: **Thomas Booker CUMMINGS** (Thomas W. Cummings, Lavina W. Booker); Born: 7 Oct 1911 (death cert); Died 18 Jan 1996 (death cert); Bur: Pacific View Memorial Park, Newport Beach CA (death cert)  
Died: 30 Aug 1998 Corona del Mar CA (death cert); Bur: Pacific View Memorial Park, Newport Beach CA (burial record)

=====

1.10a.2b.1.1.12a.3.1. **Carl Geary BINGHAM, Jr.**@BJO (Carl G., Millard F., Samuel, Samuel, Gideon, Joseph, Thomas) *new info: 8-71*  
Mar: **Cornelia FREAN**; Died: May 1974 (obit); Bur: Rosehill Cemetery, Chicago, Cook, IL (burial record)  
Died: 5 Jan 1978 Chicago, Cook, IL (death cert); Bur: Rosehill Cemetery, Chicago, Cook, IL (burial record)

1.10a.2b.1.1.12a.3.2. **John Norris BINGHAM**@BJO (Carl G., Millard F., Samuel, Samuel, Gideon, Joseph, Thomas) *new entry: 8-71*  
Born: 24 Dec 1921 Chicago, Cook, IL  
Died: 25 Feb 1985, Deerfield, Lake, IL (death cert); Bur: Rosehill Cemetery, Chicago IL (burial record)

=====

1.10a.2b.1.1.12a.4.1. **Samuel Almiron BINGHAM, Jr.**@BJO (Samuel A., Millard F., Samuel, Samuel, Gideon, Joseph, Thomas) *new info: 8-71*  
Mar: 18 Sep 1937 **Jane Helen RAOUL** Died 8 Sep 2001 Asheville, Buncombe, NC (death cert); Cremated  
Died: 30 June 1988 Asheville, Buncombe, NC (death cert); Cremated  
Samuel was educated at Cornell University and worked as an industrial engineer.

1.10a.2b.1.1.12a.4.2. **Ann Dearden BINGHAM**@BJO (Samuel A., Millard F., Samuel, Samuel, Gideon, Joseph, Thomas) *new info: 8-71*  
Born: 20 Dec 1920 Wheaton, DuPage, IL (death cert)  
Mar: 27 Mar 1943 **James Burdett Lawrence RUSH** (Ralph Rush, Leida Burdett) Tryon, NC; Born: 30 Sep 1914, Whitehall NY (death cert); Died: 4 Sep 1996 Winston Salem, Forsyth Co NC (death cert); Bur: St. Paul Episcopal Church Cemetery, Winston Salem, NC (death cert)  
Died: 21 May 1980 Winston Salem, Forsyth, NC (death cert); Bur: St. Paul Episcopal Church Cemetery, Winston Salem NC (death cert)

James went to Williams College, worked as a newspaper journalist, and served in the Army in World War II.

=====

**CHILD OF HENRY W.** (George E., Nathan, Elijah Jr., Elijah, Joseph, Thomas)

*new entry: 8-77*

**1.10a.4a.1.10.3a.7.3. Arthur C. BINGHAM** (Henry W., George E., Nathan, Elijah Jr., Elijah, Joseph, Thomas)

Born: 1870, MN  
 Mar: **Bertha M.**; Born: Mar 1870, IA  
 Died: 1890s MT

We have no information other than birth, to whom married and decade of death for Arthur C. Bingham.  
 Child

1.10a.4a.1.10.3a.7.3.1. Arthur Henry 1891

=====

**CHILDREN OF ELBERT HOWARD** (Albert Mortimer, Horace, Vine, Elijah, Joseph, Thomas)

*new entry: 8-78*

**1.10a.4b.9a.2.5a.7.2. Howard Murray BINGHAM** (Elbert H., Albert M., Horace, Vine, Elijah, Joseph, Thomas)

Born: 11 Aug 1904, Detroit, Wayne, MI@881, @882  
 Mar: 1928 @885 **Eleanor L.**; Born: 1909, NY@885  
 Died: 5 Jul 1996, Asheville, Buncombe, NC@883

According to the 1930 U. S. Census, Howard had been married for 2 years and lived in Grosse Point, Wayne, MI. He worked as a dry good merchant. The household had one servant girl, age 27, from Germany.@885

=====

**GENERATION NINE**

**1.1.8a.2.6.1.4.3.5. Stanley Corbett BINGHAM**

*new data: 9-9*

Mar: **Dorothy Faye NESTOR**; Died: 3 Sep 2007, Pikeville, TN; Bur: Wood-Kortright-Borkoski Funeral Home, 8 Sep 2007, Edinburg Cemetery, Edinburg, OH.@829

As a child, Dorothy helped her parents with their vegetable growing business and farm animals. She graduated from Atwater High School.@829

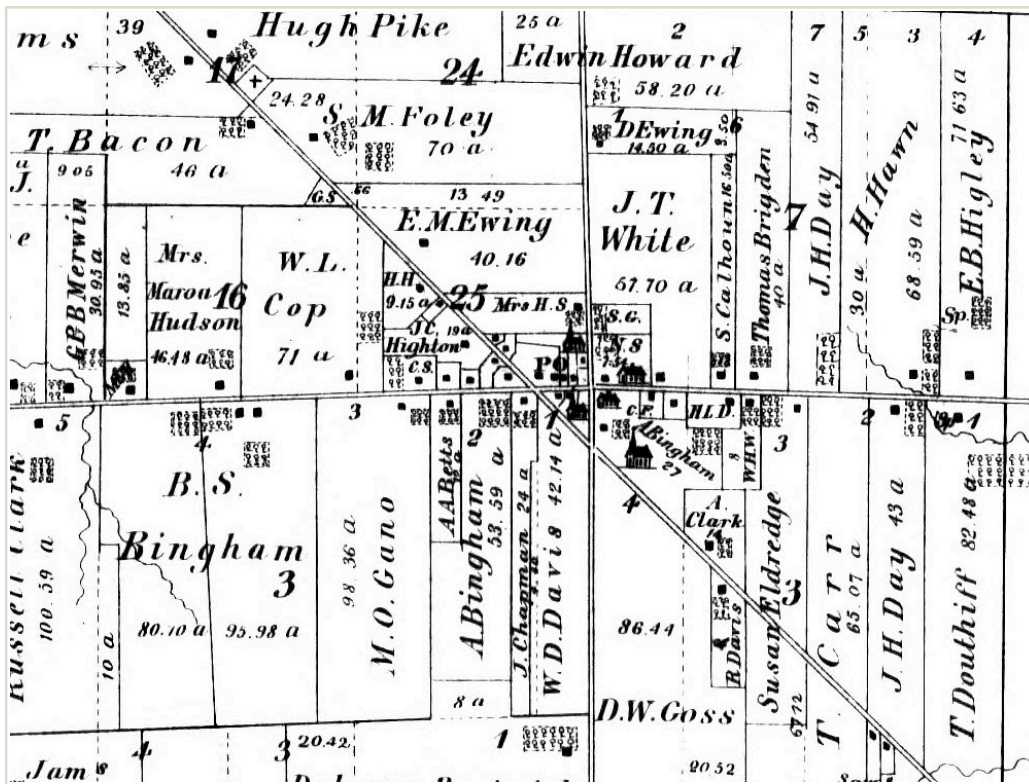

*Edinburg Township Land Ownership dating from the 1880s. The farm owned by B. S. Bingham [Benjamin Sackett] descended to his grandson Stanley Corbett Bingham. Note: A. Bingham was Benjamin Sackett's brother Asa Bingham. Asa's two tracts are close to the crossroads. The diagonal road is state route 14. The horizontal road is now Interstate 76. The Edinburg Cemetery is .2 of a mile north of I 76 on the east side of Rt 14. Map taken from U.S. County Land Ownership Atlases, c. 1864-1918. Online: Ancestry.com and elsewhere in book form.*

**CHILDREN OF IRA WILCOX** (Ira A., Ira, Edward, Elisha, Jonathan, Abel, Thomas)

*new entry: 9-67*

1.2.8b.3.4.1.5.1.1. **Ira Wilcox BINGHAM Jr.** (Ira W., Ira A., Ira, Edward, Elisha, Jonathan, Abel, Thomas)

Born: 28 Jan 1915 WI

Mar: 21 Jun 1947 **Name Unknown** Jefferson County, AL@942

Died: 27 Oct 1997, Baton Rouge, East Baton Rouge, LA@820; Bur: Rose Lawn Memorial Park@859

This Ira Wilcox was born in WI, probably Portage as per his daughter's comments on Ancestry Message Boards, but moved to Louisiana when he was about two years old. During World War Two, he served in the US Navy on a PHM or Hydrofoil Missile Patrol Ship. After the war, he attended LSU, worked at the VA Hospital, and married.@918

Children:

1.2.8b.3.4.1.5.1.1.1. Ira W. 1951

1.2.8b.3.4.1.5.1.1.2. Carol; Mar: Hicks

**CHILDREN OF EDWARD AUGUSTUS** (Ira A., Ira, Edward, Elisha, Jonathan, Abel, Thomas)

*new entry: 9-67*

1.2.8b.3.4.1.5.2.1. **Clifton A. BINGHAM** (Edward A., Ira A., Ira, Edward, Elisha, Jonathan, Abel, Thomas)

Born: 1908, NY

Mar: **Annora Elizabeth McNIEL**

Children

1.2.8b.3.4.1.5.2.1.1. Douglas Edward

1.2.8b.3.4.1.5.2.1.2. James Clifton

1.2.8b.3.4.1.5.2.2. **Keith Leroy BINGHAM** (Edward A., Ira A., Ira, Edward, Elisha, Jonathan, Abel, Thomas)

Born: 1911, NY

Mar: **Ruth VANMITA**

**CHILDREN OF LEWIS JAY** (Ira A., Ira, Edward, Elisha, Jonathan, Abel, Thomas)

*new entry: 9-67*

1.2.8b.3.4.1.5.3.3. **Wellington Straight BINGHAM** (Lewis J., Ira A., Ira, Edward, Elisha, Jonathan, Abel, Thomas)

Born: 6 Jul 1917 Ithaca, Tompkins, NY@971

Mar: **Patricia DAVIS**; Born: 29 Dec 1919 Seattle, King, WA; Died: 13 Jun 1992, Spokane, Spokane, WA@970

Died: 31 Mar 1996, Spokane, Spokane, WA@743

W.S. retired as managing partner of a large west coast food brokerage firm.

Children

1.2.8b.3.4.1.5.3.3.1. David

1.2.8b.3.4.1.5.3.3.2. Richard

1.2.8b.3.4.1.5.3.3.3. Carol 19 Sep 1947, Spokane, Spokane, WA; Died: 3 Apr 1990, Malaga, SPAIN [auto accident]@970

**CHILDREN OF ARTHUR GARFIELD** (Ira A., Ira, Edward, Elisha, Jonathan, Abel, Thomas)

*new entry: 9-67*

1.2.8b.3.4.1.5.4.1. **Kenneth L. BINGHAM** (Arthur G., Ira A., Ira, Edward, Elisha, Jonathan, Abel, Thomas)

Born: 30 Apr 1906, Spencer, Tioga, NY

Mar: 15 Feb 1942 **Ruth V.**; Born: 1910; Died: 1998; Bur: Evergreen Cemetery, Spencer, Tioga, NY @920

Died: Sep 1977 Spencer, Tioga, NY @820; Bur: Evergreen Cemetery, Spencer, Tioga, NY @920

1.2.8b.3.4.1.5.4.2. **Robert Ira BINGHAM** (Arthur G., Ira A., Ira, Edward, Elisha, Jonathan, Abel, Thomas)

Born: 18 Jul 1912, Spencer, Tioga, NY

Mar: 8 Oct 1943 **Ann L.**; Born 17 Oct 1914; Died 1 Mar 2003; Bur Evergreen Cemetery, Spencer, Tioga, NY @920

Died: 3 May 1995, Spencer, Tioga, NY; Bur: Evergreen Cemetery, Spencer, Tioga, NY @920

=====

**CHILDREN OF SILAS E.** (William H., Elisha, John Clark, Abner, Abisha, Samuel, Thomas)

*new entry: 9-70*

1.9a.2.3.2a.2.1.1.1.1. **Lucy Ann BINGHAM** (Silas E., William H., Elisha, John Clark, Abner, Abisha, Samuel, Thomas)

Born: 3 Mar 1857, Seward, Kendall, IL<sup>83</sup>, <sup>897</sup>

Mar: 1 Jan 1879 **Robert SHEARER**, Will, IL<sup>633</sup>; Born: Aug 1853, IL<sup>258</sup>

Died: 8 Jan 1906, Seward, Kendal, IL; Bur: Seward Mound Cemetery<sup>897</sup>

After they married, Lucy Ann and Robert Shearer lived in Jackson, Will, IL with 7 month old daughter Florence. Cousin, Lizzie Gear, 10, (See 1.9a.2.3.2a.2.1.3. **Amanda**) and George Rust lived with them. Lizzie was classed as servant.<sup>1047</sup> After Lucy's father died in 1889, the family moved to Seward Township, Kendall Co. to help work the farm. They lived in the dwelling next to her mother, Elizabeth, brother William, and uncle Isaac.<sup>1079</sup>

Shearer children

1. Florence 1879
2. James R 1883
3. Lida J 1884
4. Earl H. 1889
5. Ira H. 1893
6. Alice L. 1896

1.9a.2.3.2a.2.1.1.2. **William H. BINGHAM** (Silas E., William H., Elisha, John Clark, Abner, Abisha, Samuel, Thomas)

Born: 24 Dec 1859, Seward, Kendall, IL<sup>83</sup>, <sup>897</sup>

Died: 6 Apr 1911, Joliet, IL<sup>897</sup>; Bur: Seward Mound Cemetery, Kendal, IL<sup>897</sup>

William lived at home with parents, then with his mother on the property next to sister Lucy Ann. He helped with the farm until his mother died in 1902. In 1910 he lived with Fred A. Belfield, age 44, probably a nephew. William had his own income and was not employed.

**CHILDREN OF HIRAM O.** (William H., Elisha, John Clark, Abner, Abisha, Samuel, Thomas)

*new entry: 9-70*

1.9a.2.3.2a.2.1.2.2. **Clara Edna BINGHAM** (Hiram O., William H., Elisha, John Clark, Abner, Abisha, Samuel, Thomas)

Born: 23 Feb 1871, IL

Mar: 4 Jun 1891 **Wayne Scott BRIDGEMAN** Spokane, Spokane, WA; Born: 5 May 1865, Newton Co, IN; Died: 19 Dec 1950, Jackson, Amador, CA<sup>621</sup>; Bur: Jackson Cemetery, Jackson, Amador, CA

Died: 11 Oct 1953, Humboldt, CA<sup>621</sup>

Some researchers claim that Clara married Wayne Bridgeman in Spokane, Spokane, WA rather than in their home state of Indiana. The date and place needs to be verified. They settled in Harrison, Kootenai, ID. Harrison is south of Coeur D'Alene on the east side of Lake Coeur D'Alene and once was the largest city on the lake. Founded in 1891 as a timber town, Harrison had eleven working timber mills in its heyday. Wayne and Clara and Wayne's brother and family saw an opportunity in the hardware store business. They operated that store until they retired. Wayne and Clara had a fairly nice house valued at \$1500.00 in 1930.<sup>1022</sup> After they retired, they moved to Jackson, Amador, California. <sup>621</sup> Jackson is southeast of Sacramento.

Clara and Wayne had three children. The youngest, Jack, was born in San Diego in 1911, but the U S Census shows the family at home in Harrison in 1900, 1920, and 1930.<sup>1020</sup>, <sup>1021</sup>, <sup>1022</sup> The 1910 census shows the family in El Cajon, San Diego, CA. Wayne was working as a fruit farmer.<sup>1025</sup> Son Jack remained in Harrison until he died in 1977.

Bridgeman children

1. Glenn H. 1900
2. Gertrude Hellen 1907
3. Wayne E. "Jack" 1911

**CHILDREN OF WILLIAM HENRY** (William H., Elisha, John Clark, Abner, Abisha, Samuel, Thomas)

*new entry: 9-70*

1.9a.2.3.2a.2.1.4.1. **Silas B. BINGHAM** (William Henry, William H., Elisha, John Clark, Abner, Abisha, Samuel, Thomas)

Born: 1865, IL

All we know of Silas B. is that in 1880 he lived with parents in Union, Benton, IN and worked as a farm laborer.<sup>1028</sup>

1.9a.2.3.2a.2.1.4.2. **James G. BINGHAM** (William Henry, William H., Elisha, John Clark, Abner, Abisha, Samuel, Thomas)

Born: 1869, IL

Mar: 29 Apr 1908 **Mabel A. SIMPSON**, Cass, IN<sup>1030</sup>; Born: 1880; Died: 1971, Cass, IN; Bur: Spring Creek

Christian Cemetery, Metea, Cass, IN<sup>682</sup>

Died: 7 Jan 1935, Cass, IN<sup>682</sup>, Memorial # 20042517; Bur: Spring Creek Christian Cemetery, Metea, Cass, IN<sup>682</sup>

The 1880 U.S. census recorded James' and his grave stone give him the middle initial R. appears in the census. were buried in the same cemetery as his Wife Mabel was ten years younger. They Cass, IN where James worked as a retired and moved to Logansport to live died before 1930, but mother-in-law Mary James. They owned their home worth James was not working.<sup>1032</sup> He died in share a headstone in Spring Creek



middle initial as R., but all later censuses initial G. No other James with middle Furthermore, James G. and wife Mabel parents. James married in 1908 at age 39. had no children and lived in Logansport, carpenter.<sup>1031</sup> Before 1920 his parents just three doors away.<sup>1027</sup> Both parents E. Simpson then lived with Mabel and \$3,000.00, but did not have a radio and 1935, but Mabel lived until 1971. They Christian Cemetery, Metea.

- 1.9a.2.3.2a.2.1.4.3. **Katherine “Katie J.” BINGHAM** (William Henry, William H., Elisha, John Clark, Abner, Abisha, Samuel, Thomas)  
 Born: Dec 1872, Benton, IN  
 Mar: 27 May 1895 **Thomas B. SNYDER** Benton, IN@1030; Born: Sep 1872; Died: 1945 Cass, IN; Bur: Spring Creek Christian Cemetery, Metea, Cass, IN@682  
 Died: 1954 Cass, IN; Bur: Spring Creek Christian Cemetery, Metea, Cass, IN@682



Married in 1895, Katherine, who went by the name, Katie J., and Thomas B. Snyder first appeared on the 1900 census living in Fowler, Benton, IN. Thomas was working as a well digger and they had no children.@1061 They did not appear on the 1910 census, and by 1920 they had moved to Park Avenue, Logansport Ward 1, Cass, Indiana. Thomas worked as a plumber and their only child, daughter Catherine M. was 7 years old.@1063 Ten years later, in 1930, they also lived on Park Avenue, Logansport, Cass, IN and Thomas was still a plumber. Daughter Catherine was not at home.@1062  
 Snyder child 1. K/Catherine M.

**CHILDREN OF JAMES ALBERT** (William H., Elisha, John Clark, Abner, Abisha, Samuel, Thomas)

*new entry: 9-70*

- 1.9a.2.3.2a.2.1.5.1. **Cornelia BINGHAM** (James A., (William H., Elisha, John Clark, Abner, Abisha, Samuel, Thomas)

Born: 26 Aug 1872 Leadville, CO@1088

Mar (1): 13 Jan 1893 **James BULL** (John Bull, Isabella) Newton, IN@1030 Newton County Clerk's Office, Bk 3, p. 109; Born: Jun 1865, Seward, Kendall, IL; Died: abt 1920 Washington, Newton, IN; Bur: Riverside/Brook Cemetery@1081

Mar (2): 5 Mar 1925 **Webster D. SELL**, Tippecanoe, IN@1030, Tippecanoe County Clerk's Office, Bk. M-40, p. 251. Born: 5 Dec 1861 York Co., PA; Mar (1): 5 Oct 1884 Josephine Anderson; Died: 22 Mar 1946, Jasper, IN@1082; @1088; Bur: Riverside/Brook Cemetery@1081

Died: 1941, Brook, Newton, IL; Bur: Riverside/Brook Cemetery@1081

Cornelia, went by the name Nellie. Her obituary claimed that she had been born in Leadville, CO. Subsequent census records claimed Indiana. See James Albert's bio sketch for further comment. Nellie married in 1892 when she was 19, about a year after her father died. Since she married in Newton, IN, and her new husband, James Bull was from Seward, Kendall, IL, it may be that Cornelia had been living in Washington, Newton County, IN and youngest was a farmer and they continued in live in James died before 1920, for in that year, Nellie home in the town of Beaver in Newton  
 Nellie married second when she was 47 in 1925, Cornelia's brother Albert called him Charles Sell Webster's wife Josephine Anderson Sell had died town of Brook.@1086 They were married a little not mention his second marriage. Both were was buried with first husband James Bull and not Porter, *Public Member Stories, Ancestry.com*.



Newton, IN. Certainly, in 1900 the couple lived in sister Mabel, age 14, lived with them.@1083 James Washington, Newton County through 1910.@1084 was recorded as a widow. She owned her own County.@1085  
 a widower named Webster D. Sell age 63, on his World War II draft registration form.@675 in 1920.@1087 Nellie and Webster lived in the little over twenty years, but Webster's obituary does buried in Riverside or Brook Cemetery, but Nellie with Webster. *Photo of Cornelia: Christine*

No children

- 1.9a.2.3.2a.2.1.5.2. **Florence BINGHAM** (James A., (William H., Elisha, John Clark, Abner, Abisha, Samuel, Thomas)

Born: May 1875, Brook, Newton, IN

Mar: 25 May 1904 **Charles Henry CROOKS** (James Henry Crooks, Margaret Baird); Born: 10 Dec 1875 Bethel, Wyandotte, KS@880; Died: 18 Jan 1949 St Augustine, St John, FL@272; Bur: Evergreen Cemetery@1089

Died: 26 Jun 1962 St Augustine, St John, FL; Bur: Evergreen Cemetery, St Augustine@1089

Florence was fifteen when her mother died and 16 when her father died. Older sister Nellie took over as head of the family. Florence stayed with Nellie until 1894 when she applied to Park College in Missouri. She must have started at Park in September 1894 when she was 19 and she was located in Pettis Twp, Platte County, MO. Brother Park College offered a work/study curriculum hours a day in addition to classes and studies. interesting early history of the school and several genealogytrails.com/mo/platte/school.  
 still a pupil in 1900, age 25. Park College was Albert Hurd was a pupil there in 1900, also.@1064 open to anyone willing to work three to four The main building is pictured here. For an o t h e r p h o t o s s e e



H. Crooks. Charles was from Bethel, Kansas. At of Kansas City, KS. Charles graduated from Park College of Physicians and Surgeons, Kansas City, Park College in 1900 for while Charles was in Missionary of the Presbyterian Church in the were married June 25, 1904 and made Bethel, KS

At Park, Florence met husband-to-be, Charles that time Bethel was a farming community west College in 1901 and went on to graduate from the KS in 1904.@272 Florence must have finished at medical school, Florence served with the Home U.S.A. 1900 to 1904.@1090 Florence and Charles their permanent U. S. residence. (This photo of Florence and Charles is dated 1901. Source: Barb McEntire, *Public Member Stories, Ancestry.com*)





Charles also became a missionary for the Presbyterian Church. Two days after they were married, Charles applied for his first passport for himself and Florence. Within a few months, they were on their way to Siam, now Thailand, as Charles had been appointed by the Board of Foreign Missions of the Presbyterian Church in the U.S.A. to work in Northern Siam. The couple arrived there November 10th, 1904 and remained until August 17th, 1910 working between Prae and Chiengrai. Technically, Charles was assigned to the Van Santvoort Hospital as a medical itinerant and Florence did literature work. They then went to London in 1911 so Charles could attend the London School of Tropical Medicine. Published passenger lists do not contain their names as entering the United States at this time, so they may have returned directly to Siam. From

February 22, 1912 to May 17, 1918, they lived in Lampang. Charles spent time developing the hospital as well as medical work in the city.

We know they returned to Kansas temporary return passport from the 17, 1918. That passport was Seattle on July 11, 1918. They Charles filled out his World War I remained there for about a

On August 5, 1919, Charles and steamship Fushimi Maru headed way back to Lampang, Siam. Their June, 1919. Their first trip back S.S. "President Cleveland" in San 20. They returned to Siam in Glasgow, Scotland on the ship

In 1935 Charles transferred to and expanded the area medical superintendent of a school for

Charles retired in 1941 after missionary in Siam. He and FL. She wrote a short book *Tales of Thailand* privately printed Florence wrote a small pamphlet *of the Cross: Dr. Charles H. Siam, 1904-1940*. That was printed throughout Florida about their 1963.

Note: for map see source 1095

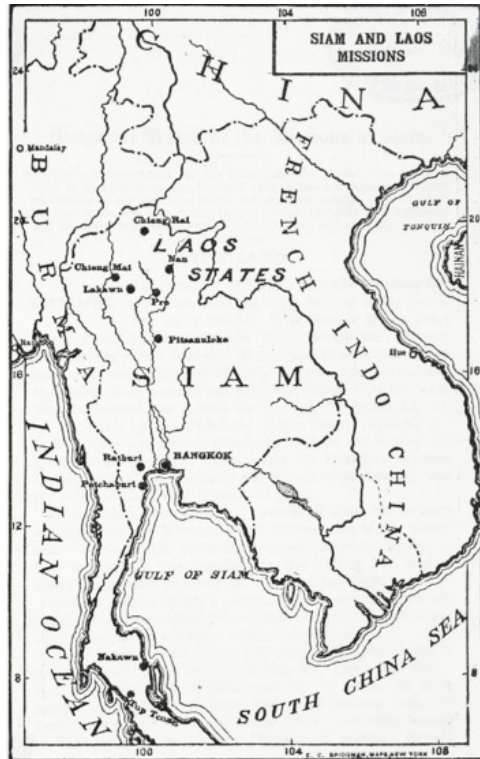

in 1918 for they needed to obtain a U.S. Embassy in Bangkok on May cancelled upon their arrival in were in Kansas in September when draft registration card and they year.

Florence left Seattle on the for Hong Kong via Japan on their new passport application was dated home was in 1926, arriving on the Francisco from Yokohama on April April, 1927 sailing from New York to "Cameronia."

Nan where he rebuilt the hospital services. He also served as boys.

thirty-seven years as a medical Florence settled in St. Augustine, about their years in Siam titled in 1942. After Charles died in 1949, titled *A Tribute to a Gallant Soldier Crooks, Medical Missionary to* in 1951. Florence also lectured missionary work. She died in

1.9a.2.3.2a.2.1.5.3. **Albert Hurd BINGHAM** (James A., (William H., Elisha, John Clark, Abner, Abisha, Samuel, Thomas)

Born: 22 Apr 1883 Minooka, Grundy, IL  
Died: 1976 Muncie, Delaware, IN

Albert was 7 when his mother died in 1890 and 8 when his father died in 1891. Thereafter, sister Nellie was head of household. He entered Park College, Parkville, Pettis Township, Platte, MO in 1899 age 16 and was there in 1900 at age 17. Sister Florence was a pupil there at the same time. In 1910 Albert may have been the 27 year old Albert Bingham who was a teamster in a sawmill in Aberdeen, WA. The age and birthplace fit. We do know that Albert eventually went to work for the Great Northern Railroad and in 1918 lived in Fargo, Cass, ND where he worked in the Freight House. Roll 1819406 Albert was not married, but referenced his sister, Mrs. James Bull, of Brook, Newton, IN on his World War 1 draft registration card. In fact, in 1942 when Albert filled out his World War II draft registration card, that is where he was living.

1.9a.2.3.2a.2.1.5.4. **Mabel White BINGHAM** (James A., (William H., Elisha, John Clark, Abner, Abisha, Samuel, Thomas)

Born: 11 Nov 1885 Joliet, Will, IL

Mar: 14 Feb 1906 **Henry Sterling HENDERSON** Sedgewick, KS; Born: Mar 1883, KS; Died: 3 Nov 1940,

Sedgewick, KS; Burial: Park Cemetery, Sunnysdale, Sedgewick, KS

Died: 21 Oct 1958, Fredonia, Wilson, KS

Mabel lived with oldest sister Nellie after their parents died in 1890 and 1891 respectively. She was still living with Nellie in 1900, age 14, after Nellie married James Bull. Mabel next appeared in Kansas where in 1905 she was living with and working for J. G. and Annie Richardson. We do Harry in 1900 at age 17 was working as a servant Grant, Sedgewick, KS. And in 1905 Harry Mabel and Harry had two children and a hired Their third child was born there in 1913, probably about ten years before returning to KS. Two 1926. Harry died in 1940 and was buried in grave marker indicates that he once served as a that is needed. Mabel lived another eighteen burial place is needed as she was not buried with Mabel White Bingham courtesy of Christine Henderson children



Mabel married in 1906, Henry "Harry" S. not know how or where Mabel met Harry, but or farm laborer for the Harry K. Ryder family in was working for the P.J. Pfile family. By 1910 man. They then moved to Colorado to farm. Craig, Moffat County and they stayed there for more children were born in KS in about 1924 and Park Cemetery, Sunnysdale, Sedgewick, KS. His Private in the U.S. 15th Cavalry. Verification of years dying in 1958 in Fredonia, Wilson, KS. A husband Harry in Park Cemetery. This photo of Porter, *Public Member Stories*, Ancestry.com.

- |                     |                      |                     |                  |
|---------------------|----------------------|---------------------|------------------|
| 1. Florence L. 1907 | 2. Ceres I. 1910     | 3. Sterling A. 1913 | 4. Vesta H. 1915 |
| 5. John L. 1918     | 6. Sadie Eunice 1921 | 7. James L. 1924    | 8. Lloyd D. 1925 |

**CHILD OF THEODORE S.** (Elisha, Elisha, John Clark, Abner, Abisha, Samuel, Thomas)

*new entry: 9-70*

1.9a.2.3.2a.2.5.4.1. **Elvira B. BINGHAM** (Theodore S., Elisha, Elisha, John Clark, Abner, Abisha, Samuel, Thomas)

Born: 25 Jun 1887, Raton, NM

Mar: 3 Oct 1906 **Floyd Alexander WORST** (Albert WORST; Rose M. OSMAN) Will, IL; Born: 29 Sep 1885, Lockport,

Will, IL; Died: Jun 1973, Plainfield, Will, IL; Bur: 4 Jun 1973, Plainfield Cemetery, Will, IL

Died: 20 Jul 1965, Plainfield, Will, IL; Bur: 22 Jul 1965, Plainfield Cemetery, Will, IL

Elvira was married in 1906, ten days before her father died. In 1910 she and Floyd and their two children lived four dwellings away from Grandmother Elvira on Division Street in Plainfield, Will, IL. Between them lived the new cemetery sexton and two funeral home employees. Floyd owned a barber shop and as late as 1942 was still cutting hair. They had five children. The oldest died when he was 15.

Worst children:

1. Harold 1908; Died 28 Nov 1923 Plainfield, Will, IL; Bur: Plainfield Cemetery, Plainfield, Will, IL
2. Rosella 1909
3. Howard 1913
4. Ruth 1917
5. Robert 1919

**CHILD OF WILLARD** (Elisha, Elisha, John Clark, Abner, Abisha, Samuel, Thomas)

*new entry: 9-70*

1.9a.2.3.2a.2.5.4.1. **Nettie E. BINGHAM** (Willard, Elisha, Elisha, John Clark, Abner, Abisha, Samuel, Thomas)

Born: Apr 1886, IL

Mar: 17 Feb 1906 **Albert Ernest SCROGGINS**; Born: 24 Jul 1884, Clark City, IL; Died: Oct 1969, Minooka,

Grundy, IL; Bur: 28 Jul 1965, Plainfield Cemetery, Plainfield, Will, IL

Died: Jul 1965, Minooka, Grundy, IL; Bur: 28 Jul 1965, Plainfield Cemetery, Plainfield, Will, IL

Nettie was 20 years old when she married Albert Scroggins, barber. According to the 1910 and 1920 censuses, they lived on Chicago Street in Plainfield, Will, IL until almost 1930 when they moved to the family farm in Nausay Township, Kendall County. They had no children, but DeWayne Richards lived with them and worked as a farm laborer. Nettie and Albert treated him like a son and provided a burial plot for him, but apparently it was not used. Nettie and Albert died in the 1960s, but Richards died in Beebe, White County, AZ on 5 September 2001. Sometime between 1930 and 1942 Nettie and Albert had moved to a farm in Minooka, Grundy, IL and that is where they were living when they died.

No Children

=====

**CHILD OF HARRY LEROY** (LeRoy Monroe, Royal Tyler, Elias, Elias, Lemuel, Samuel, Thomas)

*new entry: 9-72*

1.9a.3.7a.2c.4.2.1.1. **LeRoy Melvin BINGHAM** (Harry L., LeRoy M., Royal T., Elias, Elias, Lemuel, Samuel, Thomas)

Born: 3 Feb 1916, Waterbury, Washington, VT

Mar: Jan 1937 **Anita KITTELL** (Walter H. and Lillian B. Kittell) Burlington, Chittenden, VT; Died: 1992

Died: 5 May 2004, Auburn, Androscoggin, ME

Named for his grandfather, LeRoy grew up in Waterbury, VT. He attended Mt. Herman School and graduated from Waterbury High School where he was on the basketball team. After high school he served in the Civilian Conservation Corp (CCC) before attending the University of Vermont. He majored in Agriculture and received his BS degree in 1940.

Anita, who was to become LeRoy's wife, was a student in 1931 living at home with her retired father and working mother, an employee at the Golden Pheasant Tea Room in Burlington.®860 By 1936, Anita had a job as a stenographer at the University of Vermont and lived at 355 S Union.®871

LeRoy and Anita married in 1937. After LeRoy graduated from college he went to work as a soil conservationist for the U.S. Department of Agriculture in Fort Kent and Madawaska both in Aroostook County, ME. He did not serve in the active military during WW II, but did enlist in the army on the day that WW II formally ended in Europe, 8 May 1945.®783 He was sent to Italy and served as a sergeant.®838 He returned to Auburn and for over twenty years worked as a soil conservationist for both Androscoggin and Sagadahoc counties, ME. LeRoy had a Friday morning agricultural news program on WCOU in Lewistown, ME.

After his retirement in 1974, he and Anita moved to Zephyrhills, FL where they spent their winters and summered at their camp on Taylor Pond in Auburn. In his last few years, LeRoy lived at the Schooner Retirement Community in Auburn.®838

Children

1.9a.3.7a.2c.4.2.1.1.1. Lee Monroe 1942

1.9a.3.7a.2c.4.2.1.1.2. Peter K. 1944

**Children of Royal Edwards** (LeRoy Monroe, Royal Tyler, Elias, Elias, Lemuel, Samuel, Thomas)

*new entry: 9-72*

1.9a.3.7a.2c.4.2.5.2. **Royal Edwards Jr. BINGHAM** (Royal E., LeRoy M., Royal T., Elias, Elias, Lemuel, Samuel, Thomas)

Born: 1 May 1920®859

Mar (1): 1942 **Helen Dorothy UNKNOWN** Dade, FL; Div: 1943 Brevard, FL®872, ®873

Mar (2): 1946 **Patricia UNKNOWN**, Pinellas, FL®873

Died: 15 Apr 1995; Bur: 26 Apr 1995, Barrancas National Cemetery, Pensacola, FL®859 Sec. 39, Site 297, Naval Air Station, 80 Hovey Road, 32508

At present, we know little about Royal E. He served as a 1st Lt in the U. S. Army in WW II and Korea, but his service did not begin until 15 Aug 1946 when he would have been 26 years old and married and divorced once. He had no children by his first wife whose surname we do not know. Only because of online ship passenger lists do we have the names of his second wife and two children. All three arrived in San Francisco from Yokohama on the ship General Hugh J. Gaffey on 5 Dec 1949. On the passenger list, Patricia's last name is listed as Bingham instead of Bingham.

Children Patricia

1.9a.3.7a.2c.4.2.5.2.1. Royal E. 1947, NJ®874

1.9a.3.7a.2c.4.2.5.2.2. Michele L. 1948, b. JAPAN

=====

**CHILD OF ARTHUR C.** (Henry W., George E., Nathan, Elijah Jr., Elijah, Joseph, Thomas)

*new entry: 9-81*

1.10a.4a.1.10.3a.7.3.1. **Arthur Henry BINGHAM** (Arthur C., Henry W., George E., Nathan, Elijah Jr., Elijah, Joseph, Thomas)

Born: 23 Nov 1891, Livingston, Park, MT

Mar: 25 Oct 1913 **Emelie T. NELL** (Frank, Leann NELL) Livingston, Park, MT; Born: 8 Sep 1892, PA; Died: Jan 1980, Denver, Denver, CO®820

Died: 10 Jun 1970, Billings, Yellowstone, MT®820, ®1118; Bur: Sunset Memorial Gardens, Billings, MT

Arthur and Emelie were both 22 when they married. His World War I Draft Registration Card dated June, 1917 showed them living in Livingston and he working as a delivery clerk. Arthur served in the war and was an active member of American Legion Post 4 in Billings MT. His only child, a daughter, was born in Livingston in 1920. The family moved to Billings, Yellowstone County in 1925. Arthur worked for the Northern Pacific Railroad as a Roundman and as a Security Officer.®1127 Following that, he worked for Pacific Car and Foundry Midland Empire Fairgrounds Plant until 1944 when he was appointed a Deputy Sheriff.®1128

Child

1.10a.4a.1.10.3a.7.3.1.1. Dorothy J. 1920

## GENERATION TEN

**CHILDREN OF IRA WILCOX JR.** (Ira Wilcox, Ira A., Ira, Edward, Elisha, Jonathan, Abel, Thomas)

*new entry: 10-21*

1.2.8b.3.4.1.5.1.1.1. **Ira W. BINGHAM** (Ira Wilcox JR, Ira Wilcox Sr, Ira A., Ira, Edward, Elisha, Jonathan, Abel, Thomas)

Born: Mar 1951

Mar: 3 Aug 1970 **Magda M. NISSING** Orange TX®919; Born: abt 1950

In 2009 Ira lived at 190 N Cities Service Hwy, Sulphur, LA 70663.

**CHILDREN OF CLIFTON A.** (Edward A., Ira A., Ira, Edward, Elisha, Jonathan, Abel, Thomas)

*new entry: 10-21*

1.2.8b.3.4.1.5.2.1.1. **Douglas Edward BINGHAM** (Clifton A., Edward A., Ira A., Ira, Edward, Elisha, Jonathan, Abel, Thomas)

Bingham Association UPDATE 2008-2009

Mar: **Darlene LOTT**  
Children  
1.2.8b.3.4.1.5.2.1.1.1.1. Ben  
1.2.8b.3.4.1.5.2.1.1.1.2. Amy

1.2.8b.3.4.1.5.2.1.2. **James Clifton BINGHAM** (Clifton A., Edward A., Ira A., Ira, Edward, Elisha, Jonathan, Abel, Thomas)

Mar: **Susan Anne JACKSON**  
Children  
1.2.8b.3.4.1.5.2.1.2.1. James Clifton Jr.  
1.2.8b.3.4.1.5.2.1.2.1. Jeffrey Scott

=====

**CHILDREN OF LEROY MELVIN** (Harry L., LeRoy M., Royal Tyler, Elias. Elias, Lemuel, Samuel, Thomas)

*new entry: 10-24*

1.9a.3.7a.2c.4.2.1.1.1. **Lee Monroe BINGHAM** (LeRoy M., Harry L., LeRoy M., Royal T., Elias. Elias, Lemuel, Samuel, Thomas)

Born: 1942, ME  
Mar: **Glenna**

In 2004 Lee lived at 31 Fox Run Lane, Surry ME 04684 and Scottsdale AZ .

1.9a.3.7a.2c.4.2.1.1.2. **Peter K. BINGHAM** (LeRoy M., Harry L., LeRoy M., Royal T., Elias. Elias, Lemuel, Samuel, Thomas)

Born: 1944, ME  
Mar: **Connie**

In 2004, Peter lived Cumberland Center, ME.

=====

**CHILD OF ARTHUR H.** (Arthur C., Henry W., George E., Nathan, Elijah Jr., Elijah, Joseph, Thomas) *new entry: 10-29*

1.10a.4a.1.10.3a.7.3.1.1. **Dorothy J. BINGHAM** (Arthur H., Arthur C., Henry W., George E., Nathan, Elijah Jr., Elijah, Joseph, Thomas)

Born: 23 Mar 1920, Livingston, Park, MT@820

Mar: **William L. SIMON** Born: 29 Jul 1918; Died: 22 Jun 1999, Denver, Denver, CO@682; Bur: Fort Logan  
National Cemetery, Denver, Denver, CO

Died: 14 Feb 2009, Denver, Denver, CO@820; Bur: Fort Logan National Cemetery, Denver, Denver, CO@682

Dorothy's husband always went by the name Bill. Bill was a Staff Sergeant, U S Army Air Force, World War II, hence the burial at Fort Logan. The couple lived in Denver, CO and had two children.

## GENERATION ELEVEN

**CHILDREN OF JAMES CLIFTON** (Clifton A., Edward A., Ira A., Ira, Edward, Elisha, Jonathan, Abel, Thomas) *new entry: 11-9*

1.2.8b.3.4.1.5.2.1.2.1. **James Clifton BINGHAM Jr.** (James C., Clifton A., Edward A., Ira A., Ira, Edward, Elisha, Jonathan, Abel, Thomas)

Mar: **Sheril HAYES**  
Children

1.2.8b.3.4.1.5.2.1.2.1.1. Jagar James  
1.2.8b.3.4.1.5.2.1.2.1.1. Jayme Lynn

1.2.8b.3.4.1.5.2.1.2.1. **Jeffrey Scott BINGHAM** (James C., Clifton A., Edward A., Ira A., Ira, Edward, Elisha, Jonathan, Abel, Thomas)

Mar: **Colleen JONES**

Jeffrey lives in Rochester, NY. and is working on filling out the details of this Bingham line.

Children

1.2.8b.3.4.1.5.2.1.2.1.1. Jaxtin Dougles

## Sources

Please note two items: (1) You will find source numbers below 833 in *THE BINGHAM FAMILY IN THE UNITED STATES; THE DESCENDANTS OF THOMAS BINGHAM OF CONNECTICUT* and in previous *UPDATES*; (2) The format of these sources now spans a time period of thirteen years. The software that I use has gone through several versions; online companies have changed the way they format sources; I have also made some changes in the way I record sources. Consequently, variation may occur with the same record. Users should still have enough information within the text and the source to locate the record. If assistance is needed, please contact me at [dgbmunger@att.net](mailto:dgbmunger@att.net).

- 833.** *Biographical Encyclopaedia of Vermont of the nineteenth century*. Boston: Metropolitan Pub. and Engraving Co., 1885. Ancestry.com.
- 834.** Child, Hamilton, and William Adams. *Gazeteer of Washington County, VT., 1783-1889*. Syracuse, N.Y.: Syracuse Journal Co., printers, 1889. History, Part XI, p. 91. Online: [rootsweb.ancestry.com/~Vermont/WashingtonCoHistory11.htm](http://rootsweb.ancestry.com/~Vermont/WashingtonCoHistory11.htm). Accessed 24 March 2008.
- 835.** 1910 U. S. Census: Waterbury, Washington, Vermont; Roll T624\_1617; p. 1A.
- 836.** 1920 U. S. Census, Waterbury, Washington, Vermont. Roll 625\_1875, p. 10B.
- 837.** 1930 U.S. Census. Waterbury, Washington, Vermont. Roll 2431, p. 2B.
- 838.** Obituary. *Sun Journal*, Lewistown, ME. 8 May 2004. Ancestry.com.
- 841.** *Burlington and Winooski (Vermont) Directory 1916*. Springfield MA: H. A. Manning Company, 1916
- 842.** *Burlington and Winooski (Vermont) Directory 1920*. Springfield MA: H. A. Manning Company, 1920
- 843.** *Passenger and Crew Lists of Vessels Arriving in New York, New York, 1897-1957*; (National Archives Microfilm Publication T715). Records of the Immigration and Naturalization Service, National Archives, Washington, D.C. Ancestry.com as New York Passenger Lists, 1820-1957.
- 844.** 1880 U.S. Census. Fletcher, Franklin, VT. Roll T9\_1344. Ancestry.com.
- 845.** 1930 U.S. Census. New York City, 13th Assembly District, Ward M, ED 31-854. Roll T626\_1562. Ancestry.com.
- 846.** Ashline, Donella K., ed. *Franklin, Grand Isle Counties, Vermont Business Directory, 1883*. Ancestry.com.
- 847.** 1920 U.S. Census. Barton, Orleans, Vermont: Roll T625\_1874, p. 1B. Ancestry.com.
- 848.** 1880 U.S. Census. Fletcher, Franklin, VT. Roll T9\_1344. Ancestry.com.
- 849.** 1900 U.S. Census. Fletcher, Franklin, VT. Roll T623\_1692, p. 1B. Ancestry.com.
- 850.** 1910 U.S. Census. Fletcher, Franklin, VT. Roll T624\_1614, p. 1B.
- 851.** 1920 U.S. Census. Barton, Orleans, VT. Roll T625\_1874, p. 1B.
- 852.** 1850 U.S. Census. St Albans, Fletcher, VT. Roll M432\_924, p. 80. Ancestry.com.
- 853.** 1860 U.S. Census. Fletcher, Franklin, VT. Roll M653\_1321, p. 264. Ancestry.com.
- 854.** 1870 U.S. Census. Fletcher, Franklin, VT. Roll M593\_1620, p. 233. Ancestry.com.
- 855.** Child, Hamilton. *Gazetteer and Business Directory of Lamoille and Orleans Counties, VT for 1883-84*. Syracuse, N.Y., H. Child, 1883. p.527. Ancestry.com.
- 856.** 1910 U.S. Census. Lowell, Orleans, VT. Roll T624\_1615, p. 8B. Ancestry.com.
- 859.** National Cemetery Administration. Nationwide Gravesite Locator. Ancestry.com as U.S. Veterans Gravesites, ca. 1775-2006.
- 864.** Talcott Cemetery, Lanesboro, MA: Transcribed by Dawn Newton Quinn: Photos By: Kelly Townsend. USGenweb.org
- 865.** "John Lazell of Hingham Mass and some of his descendants." *Genealogies of Mayflower Families, II*. Ancestry.com.
- 867.** Mulvey, Susan Stalker. *History of Nobletown New York*. see [usgennet.org/usa/ny/county/columbia/hill/histhills.htm](http://usgennet.org/usa/ny/county/columbia/hill/histhills.htm)
- 868.** Florida Death Index, 1877-1998. Ancestry.com. Original: State of Florida Dep't of Health, Office of Vital Records. Florida Death Index, 1877-1998.
- 869.** McLean County Genealogical Society. *Dawson Township Cemeteries*. Vol. 1-R. 1970. see Publications at [www.mcgs.org](http://www.mcgs.org)
- 871.** *U.S. City Directories, Burlington, Vermont, 1936*, p. 106. Ancestry.com.
- 872.** *Florida Divorce Index, 1927-2001*. Ancestry.com.
- 873.** *Florida Marriage Collection, 1822-1875 and 1927-2001*. Ancestry.com.
- 874.** *California Passenger and Crew Lists, 1893-1957*. Ancestry.com.
- 875.** 1900 U.S. Census. Waterbury, Washington, VT. Roll: T623 1695; p. 7B. Ancestry.com
- 876.** *New York Passenger Lists, 1820-1957*. Ancestry.com. Original data NARA T715 Passenger and Crew Lists of Vessels Arriving at New York, 1897-1942. RG 85, Roll 3363, Line 16.
- 880.** *U.S. Passport Applications, 1795-1925*. Ancestry.com.
- 881.** 1910 U. S. Census. Detroit Ward 4, Wayne, MI; Roll T624\_681; P. 2B. Ancestry.com.
- 882.** 1920 U.S. Census. Detroit Ward 17, Wayne, MI; Roll T625\_816; P. 4B; ED 518; Image 38.

## Bingham Association UPDATE 2008-2009

- 883.** North Carolina Department of Health. *North Carolina Deaths, 1993-96. Part of North Carolina Death Collection, 1908 - 2004.* Ancestry.com.
- 884.** *Polk's Detroit City Directory (1929)*, R.L. Polk & Company. Online: University of Michigan Digital Collection.
- 885.** 1930 U.S. Census. Grosse Pointe Farms, Wayne, MI; Roll 1071; P. 100A; ED: 927. Ancestry.com.
- 886.** 1930 U.S. Census. Detroit, Wayne, MI. Roll 1055; P. 21A; ED 555. Ancestry.com
- 887.** Mount Pleasant-Scrabble Hill Cemetery, Collins, NY. Thomas A. Hawkins, recorder, 3 Dec 2006. Findagrave.com.
- 893.** *History of Clayton County, Iowa, 1882.* p. 651. see [www.rootsweb.ancestry.com/~iaclayto/index.html](http://www.rootsweb.ancestry.com/~iaclayto/index.html)
- 894.** [iowawpagraves.org](http://iowawpagraves.org) [WPA - Work Projects Administration 1930's Graves Registration Survey]
- 895.** 1900 U. S. Census. Alliance, Box Butte, Nebraska; Roll T623\_917, p. 15B.
- 896.** Kansas, Ford County Cemeteries; Dodge City. see [www.skyways.org/genweb](http://www.skyways.org/genweb)
- 897.** [www.kendallkin.org](http://www.kendallkin.org) [USGenWeb.org; Illinois, Kendall]
- 898.** *Biographical Directory of ... Kendall County, Illinois.* Chicago, G. Fisher & Co., 1876. Ancestry.com
- 899.** 1900 U.S. Census. Newark, Kendall, IL, Roll T623\_313, p. 13B.
- 900.** *Historical Encyclopedia of Illinois and History of Kendall County.* Chicago: Munsell Pub. Co., 1914. Ancestry.com.
- 901.** Hicks, E. W. *History of Kendall County Illinois ....* Aurora, Ill: Knickerbocker & Hodder, 1877. Ancestry.com.
- 902.** 1870 U S Census. Monona, Clayton, IA. Roll M593\_383, p. 437.
- 903.** 1880 U S Census. Monona, Clayton, IA. Roll T9\_333; FH Film 1254333; p. 508.
- 904.** 1880 U S Census. 3rd Ward, St. Paul, Ramsey, MN. Roll T9-0630; FH Film 1254630, p. 142A.
- 905.** Iowa State Census Collection, 1836-1925. Ancestry.com.
- 906.** 1900 U S Census, Alliance, Box Butte, NE; Roll T623\_917, p. 15B.
- 907.** Kansas State Census Collection, 1855-1925. Ancestry.com.
- 908.** 1910 U S Census. Dodge Ward 3, Ford, Kansas, Roll T624\_439, p. 14B.
- 909.** For a history of Rochester Medical School see University of Rochester, River Campus Libraries, Rare Books etc., University of Rochester History by Arthur J. May [[www.lib.rochester.edu](http://www.lib.rochester.edu)]
- 910.** Lakeview Cemetery Records, South Haven, Van Buren, MI. USGenWeb.org.
- 912.** "Newark Sketches." *Kendall County Record*, February 14, 1906. [www.kendallkin.org](http://www.kendallkin.org).
- 914.** *New Orleans, Louisiana Marriage Records, 1831-1925.* Ancestry.com
- 915.** Hall, Mary F., and Ida Hallock Fisher. *Cemetery Inscriptions.* [New York State?]: Uhl's Pub, 1996. See [tioga.nygenweb.net](http://tioga.nygenweb.net)
- 916.** *Louisiana Statewide Death Index, 1900-1949.* Ancestry.com
- 918.** *U.S. City Directories. Louisiana, Baton Rouge.* Ancestry.com
- 919.** *Texas Marriage Collection, 1814-1909 and 1966-2002.* Ancestry.com
- 920.** Kampula, Ty and Kaye et al. *Evergreen Cemetery Reading, 2000-2008. Spencer, Tioga, NY.* USGenWeb.org
- 921.** *Illinois Statewide Death Index, 1916-1950.* Illinois State Archives: [www.ilsos.gov](http://www.ilsos.gov)
- 938.** Clippings File. Dodge/Jefferson Counties Genealogical Society. Index online at [www.dodgejeffgen.com](http://www.dodgejeffgen.com). Original: *The History of Dodge County, Wisconsin ....*Chicago, Western Historical Co., 1880.
- 940.** Kendall County [Illinois] Folks Buried Outside of the County. By Elmer Dickson: [www.kendallkin.org](http://www.kendallkin.org)
- 941.** 1870 U.S. Census. Spencer, Tioga, New York; Roll M593\_1103; Page: 330.
- 942.** *Alabama Marriage Collection, 1800-1969.* Ancestry.com.
- 943.** 1860 U.S. Census. Big Grove, Kendall, IL; Roll M653\_194, p. 77.
- 944.** Obituary. *Kendall County Record.* March 10, 1909, p. 2.
- 945.** 1870 U.S. Census. Danby, Tompkins, NY; Roll M593\_1104, p. 49.
- 946.** 1900 U.S. Census. Spencer, Tioga, NY; Roll T623\_1168, p. 1B, ED 135.
- 947.** 1860 U.S. Census. Spencer, Tioga, NY, Roll M653\_867, p. o, Image 644.
- 948.** 1870 U.S. Census. Spencer, Tioga, NY, Roll M593\_1103, p. 330
- 949.** 1880 U.S. Census. Danby, Tompkins, NY, Roll T9\_938, FHL 1254938, p. 45.2000.
- 950.** 1910 U.S. Census. Spencer, Tioga, NY, Roll T624\_1084, p. 4A. ED 163.
- 951.** 1900 U.S. Census. Owego, Tioga, NY, Roll T623\_1168, p. 5B, ED 132.
- 952.** 1920 U.S. Census. Owego, Tioga, NY, Roll T625\_1270, p. 4B, ED 164.
- 953.** 1910 U.S. Census. Owego, Tioga, NY. Roll T624\_1084, P. 2A. ED 160.
- 954.** 1920 U.S. Census. Owego, Tioga, NY, Roll T625\_1270, p. 2A, ED 164.
- 955.** 1930 U.S. Census. Owego, Tioga, NY. Roll 1653, p. 12B, ED 15.
- 956.** 1880 U.S. Census. Ithaca, Tompkins, NY, Roll T9\_938, FH Film 1254938, p. 178.4000.
- 957.** 1900 U.S. Census. Ithaca, Tompkins, NY, Roll T623\_1169, p. 2B, ED 158.
- 958.** *Descendants of Daniel Davis.* See [nytompki.org/Genie/davis\\_d.htm](http://nytompki.org/Genie/davis_d.htm)

## Bingham Association UPDATE 2008-2009

- 959.** 1892 Town of Danby Census, Third Election District. NYGenWeb. Tompkins.
- 963.** 1900 U.S. Census. Chicago Ward 24, Cook, IL, Roll T623\_274, p. 6B, ED 739.
- 964.** *Album of Genealogy and Biography*, Cook County, Illinois. 3rd ed. Chicago: Calumet Book & Engraving Co., 1895. pp. 85-6.
- 965.** see Family Tree entries for Kirk, Ancestry.com
- 966.** *US IRS Tax Assessment Lists, 1862-1918*. [from NARA mfilm] Ancestry.com. See also The Tax History Museum online.
- 967.** 1870 U.S. Census. Harvard, Mc Henry, IL, Roll M593\_257, p. 242.
- 968.** 1880 U.S. Census. Harvard, Mc Henry, IL, Roll T9\_228; FHF: 1254228, p. 75-2000, ED 133.
- 969.** 1910 U.S. Census. Chicago Ward 7, Cook, IL, Roll T624\_247, p. 12A, ED 382.
- 970.** Straight, Robert S. & Beverly L. *Straight Families*. Ancestry World Tree [awt.ancestry.com.] [contact [rsstraight@surfbest.net](mailto:rsstraight@surfbest.net)].
- 971.** 1920 U.S. Census. Ithaca Ward 4, Tompkins, NY, Roll T625\_1265, pa. 4A, ED 190
- 972.** 1910 U.S. Census. Kirksville Ward 4, Adair, MO, Roll T624\_766, p. 3A, ED 7.
- 975.** Alumni Services. A.T. Still University of Health Sciences. Email reply to query 11 August 2009.
- 1008.** Kinsley, Julia Louise Cattanach (d. 2000). Courtesy of Tom Manning (tmjr@cox.net)
- 1009.** 1840 U.S. Census. Glenville, Schenectady, NY, Roll 337, p. 316.
- 1010.** 1860 U.S. Census. Lake Miles, Jefferson, WI, Roll M653\_1413, p. 359.
- 1011.** 1870 U.S. Census. Monona, Clayton, IA, Roll M593\_383, p. 437.
- 1012.** 1900 U.S. Census. Alliance, Boc Butte, NE, Roll T623\_917, p. 15B.
- 1014.** Plat Book Standard Atlas Kendall County, Illinois. George A. Ogle Company, Chicago 1922. See [kendallkin.org](http://kendallkin.org)., land records, Index to 1922 Plat Map by Elmer Dickson.
- 1016.** *American Civil War Regiments*. Ancestry.com.
- 1017.** 1900 U.S. Census. Seward, Kendall, IL. Roll T623\_313, p. 1B, ED 126.
- 1018.** 1870 U.S. Census. Nausay, Kendall, IL, Roll M593\_239, p. 432.
- 1019.** 1880 U.S. Census. Union, Benton, IN, Roll T9\_266, FH Film 1254266, p. 276.3000, ED 2.
- 1020.** 1900 U.S. Census. Harrison, Kootenai, ID, Roll ??
- 1021.** 1920 U.S. Census. Harrison, Kootenai, ID, Roll T625\_291, p. 8A, ED 198.
- 1022.** 1930 U.S. Census. Harrison, Kootenai, ID, Roll 401, p. 4B, ED 29.
- 1023.** *California Birth Index, 1905-1995*. Ancestry.com.
- 1024.** *California Voter Registrations, 1900-1968*. Ancestry.com.
- 1025.** 1910 U.S. Census. El Cajon, San Diego, CA, Roll T624\_95, p. 9A, ED 125.
- 1026.** 1910 U.S. Census. Clay, Cass, IN, Roll T624\_341, ED 20.
- 1027.** 1920 U.S. Census. Logansport Ward 3, Cass, IN, Roll T625\_425, p. 1B, ED 31.
- 1028.** 1880 U.S. Census. Union, Benton, IN, Roll T9\_266, FH Film 12542666, p. 217.2000, ED 2.
- 1029.** 1900 U.S. Census. Center, Benton, IN, Roll T623\_360, p. 11B, ED 2.
- 1030.** *Indiana Marriage Collection, 1800-1941*. Ancestry.com. Original from three sources: 1. Cass County; 2. Index to Marriage Records 1850-1920 inclusive; 3. W.P.A. Original Records located in County Clerk's Office.
- 1031.** 1910 U.S. Census. Logansport Ward 3, Cass, IN, Roll T624\_342, p. 18A, ED 22.
- 1032.** 1930 U.S. Census. Logansport, Cass, IN, Roll 579, p. 4A, ED 14.
- 1033.** 1860 U.S. Census. Vernon, Jennings, IN, Roll M653\_271, P. 219.
- 1034.** 1870 U.S. Census. Normal, McLean, IL, Roll M593\_259, p. 579.
- 1035.** 1880 U.S. Census. Worthington, Nobles, MN, Roll T9\_627, FH Film 1254627, p. 226.4000, ED 194.
- 1036.** 1880 U.S. Census. Nausay, Kendall, IL, Roll T9\_219, FH Film 1254219, p. 387.3000, ED 103.
- 1037.** 1880 U.S. Census. Plainfield, Will, IL, Roll T9\_260, FH Film 1254260, p. 406.1000.
- 1038.** 1900 U.S. Census. Plainfield, Will, IL, Roll Y623\_354, p. 15B, ED 142.
- 1039.** Internment.net. Contributed by Selina Brown, Nov 15, 2007.
- 1040.** 1880 U.S. Census. Washington, Newton, IN, Roll T9\_301, FH Film 1254301, p. 247.4000, ED 131.
- 1041.** [will.ilgenweb.net](http://will.ilgenweb.net). From Portrait and Biographical Album of Will County, Illinois. Chicago: Chapman Bros., 1890.
- 1042.** [will.ilgenweb.net](http://will.ilgenweb.net). "Real Estate Owners" Extracted by Margie Glenn from *History of Will County, Illinois*. Wm, LeBaron, Jr., & Co., 1878.
- 1043.** 1900 U.S. Census. Plainfield, Will, IL, Roll T623\_354, p. 15A, ED 142.
- 1044.** 1910 U.S. Census. Plainfield, Will, IL, Roll T624\_333, p. 9B, ED 193.
- 1045.** 1920 U.S. Census. Plainfield, Will, IL, Roll T625\_414, P. 4A, ED 201.
- 1046.** 1920 U.S. Census. Plainfield, Will, IL, Roll T625\_414, p. 6A, ED 201.
- 1047.** 1880 U.S. Census. Jackson, Will, IL, Roll T9\_260, FH Film 1254260, p. 109.4000, ED 196.
- 1048.** 1870 U.S. Census. Montana, Labette, KS, Roll M593\_436, p. 37.

## Bingham Association UPDATE 2008-2009

- 1049.** *Kansas State Census Collection, 1855-1925.* Liberty, Labette, KS, Roll 1875\_10.
- 1050.** *U.S. City Directories, Joliet, 1891.* Joliet News Bindery, 1891. Ancestry.com.
- 1051.** *U.S. City Directories, Joliet, 1889-1890.* Joliet, IL: W.F. Curtis and Co., 1890. Ancestry.com.
- 1052.** 1850 U.S. Census. Franklin, Kendall, IL, Roll M432\_113, p. 262.
- 1053.** 1860 U.S. Census. Nausay, Kendall, Illinois, Roll M653-194, P. 99.
- 1054.** 1880 U.S. Census. Liberty, Labette, KS, Roll T9\_385, FH Film 1254385, p. 318.3000, ED 111.
- 1055.** tlwht: Tracy Weirich Howell Turner, owner of Gear family tree on Ancestry.com. From "Early Marriage Records, Labette Co., KS, 30 Oct 1867 - 13 Apr 1878, 15 May 1880 - 27 Mar 1881, extracted from "The Southeast Kansas Independent-Observer, Oswego, KS", viewed at Joplin Public Library, Dec 1993.
- 1056.** 1910 U.S. Census. Montana, Labette, KS, Roll T624\_444, p. 5A, ED 135. [name spelled Geer]
- 1057.** 1900 U.S. Census. Precinct 6 (Sheridan Lake), Kiowa, CO, Roll T623\_125, p. 7B, ED 43.
- 1058.** 1920 U.S. Census. Payne, Delta, CO, Roll T625\_157, p. 8B, ED 21.
- 1059.** 1860 U.S. Census. Plainfield, Will, IL, Roll M653\_238, p. o.
- 1060.** 1900 U.S. Census. Montana, Labette, KS, Roll T623\_485, p. 7A, ED 114.
- 1061.** 1900 U.S. Census. Fowler, Benton, IN, Roll T623\_360; Page: 7B; Enumeration District: 3.
- 1062.** 1930 U.S. Census. Logansport, Cass, Indiana; Roll 579; p. 10A; ED 11.
- 1063.** 1920 U.S. Census. Logansport Ward 1, Cass, Indiana; Roll T625\_425; p.: 10B; ED: 26.
- 1064.** 1900 U.S. Census. Pettis, Platte, MO, Roll T623\_882, p. 8B, ED 139.
- 1065.** Midwest Historical and Genealogical Society. *Marriage Index, Bks. A-Z. 9 May 1870 - 24 May 1922.* skyways.lib.ks.us/genweb.
- 1066.** 1900 U.S. Census. Grant, Sedgewick, KS, Roll T623\_499, p. 2B.
- 1067.** 1910 U.S. Census. Grant, Sedgewick, KS, Roll T624\_455, p. 8A, ED 84.
- 1068.** 1920 U.S. Census. Craig, Moffat, CO, Roll T625\_167, p. 10B, ED 106.
- 1069.** 1930 U.S. Census. Louisburg, Montgomery, KS, Roll 712, p. 10A, ED 36.
- 1070.** 1850 U.S. Census. Union, Montgomery, IN, Roll M432\_161, p. 375.
- 1071.** Montgomery County, Indiana USGenWeb Project
- 1072.** 1860 U.S. Census. Rensselaer, Jasper, IN, Roll M653\_268, p. 818.
- 1073.** 1870 U.S. Census. Rensselaer, Jasper, IN, Roll M593\_326, p. 564.
- 1074.** 1880 U.S. Census. Colfax, NM, Roll T9\_802; FH Film 1254802, p. 224.1000, ED 7.
- 1075.** 1910 U.S. Census. Garden City Ward 3, Finney, KS, Roll T624\_439, p. 10B, ED 41.
- 1076.** 1910 U.S. Census. Garden City Ward 3, Finney, KS, Roll T624\_439, p. 7B, ED 41.
- 1077.** 1900 U.S. Census. Sherlock, Finney, KS, Roll T623\_480, p. 5A, ED 44.
- 1078.** 1900 U.S. Census. Plainfield, Will, IL, Roll T623\_354, p. 14A, ED 142.
- 1079.** 1900 U.S. Census. Seward, Kendall, IL, Roll T623\_313, p. 1B, ED 126.
- 1080.** 1910 U.S. Census. Aberdeen Ward 1, Chehalis, WA. Roll T624\_1653, p. 15B, ED 1.
- 1081.** Conrad, Kyle D. [KidClerk@aol.com] Riverside Cemetery, Newton County Indiana, The Tombstone Transcription Project. [[www.ingenweb.org](http://www.ingenweb.org)].
- 1082.** Frighetti, Paula. *Jasper County, Indiana Deaths, 1921-77.* Ancestry.com.
- 1083.** 1900 U.S. Census. Washington, Newton, IN, Roll T623\_394, p. 2B, ED 78.
- 1084.** 1910 U.S. Census. Washington, Newton, IN, Roll T624\_344, p. 5B, ED 135.
- 1085.** 1920 U.S. Census. Beaver, Newton, IN, Roll T625\_449, p. 13A, ED 128.
- 1086.** 1930 U.S. Census. Brook, Newton, IN, Roll 619, p. 8A, ED 6.
- 1087.** *Indiana Deaths, 1882-1920.* Ancestry.com
- 1088.** Obituary. *Brook Reporter*, Brook, Indiana. Obtained via email from Kyle D. Conrad, Newton Historical Society, 18 Oct 2009.
- 1089.** St. Augustine Genealogical Society. *Evergreen Cemetery.* compiled, surveyed & organized by C Mack Wills. Apr 2007. Update 10 Feb 2009. [www.stauggens.com/EvergreenCemNEW.htm](http://www.stauggens.com/EvergreenCemNEW.htm).
- 1090.** June 26, 1963 *St. Augustine Record* courtesy of St. Augustine Historical Society Research Library, Jennifer S. Newton, History Intern.
- 1091.** *California Passenger and Crew Lists, 1893-1957.* Ancestry.com.
- 1092.** *UK Incoming Passenger Lists, 1878-1960.* Ancestry.com.
- 1093.** herbswanson.com. *A Resource for the Study of the Thai Church.*
- 1094.** *Florida State Census, 1867-1945.* Ancestry.com.
- 1095.** "Historical Sketch of the Missions in Siam." Presbyterian Church in the U.S.A., Board of Foreign Missions; A. Williard Cooper. [www.archive.org](http://www.archive.org).
- 1096.** 1880 U.S. Census. Lisbon, Kendall, IL, Roll T9\_219, FH Film 1254219, p. 347.2000. ED 100.



## Bingham Association UPDATE 2008-2009

- 1097.** Worst, [Floyd] Family Tree. Ancestry.com (26 Oct 2009).
- 1098.** 1900 U.S. Census. Plainfield, Will, IL, Roll T623\_354, p. 15B, ED 142.
- 1099.** 1930 U.S. Census. Nausay, Kendall, IL, Roll 522, p. 3B, ED 14.
- 1100.** [ingenweb.org/jinmontgomery/marriages/index.htm](http://ingenweb.org/jinmontgomery/marriages/index.htm)
- 1101.** 1900 U.S. Census. Garden City, Finney, KS, Roll T623\_480, p. 14A, ED 41.
- 1102.** Taylor, Jane [[janezor@ultra1.pitnet.net](mailto:janezor@ultra1.pitnet.net)], 1 Mar 2000.
- 1103.** 1870 U.S. Census. Big Grove, Kendall, Illinois, Roll M593\_239; Page: 330.
- 1104.** Taylor, Jane [[janezor@pitnet.net](mailto:janezor@pitnet.net)] at [archiver.rootsweb.ancestry.com/th/read/TERHUNE/2000-03/0951965674](http://archiver.rootsweb.ancestry.com/th/read/TERHUNE/2000-03/0951965674).
- 1105.** *U.S. City Directories*, New York, Mount Vernon, Pelham and Sherwood Park of 1919, p. 73. Ancestry.com
- 1106.** 1920 U.S. Census. Mount Vernon Ward 5, Westchester, New York, Roll T625\_1277; Page: 12A; ED: 100.
- 1107.** 1930 U.S. Census. New Rochelle, Westchester, New York, Roll 1663; Page: 1A; ED: 266.
- 1108.** *New York City Directories*. NEHGS\_NewRochelle-NY-1936, Bk,B, p.63. Ancestry.com
- 1109.** 1910 U.S. Census. Knoxville, Allegheny, Pennsylvania, Roll T624\_1295; p 10B; ED 111
- 1110.** 1930 U.S. Census. Lakewood, Cuyahoga, Ohio, Roll 1787; p. 4A; ED 650.
- 1111.** Plews, Matilda Johnson. "Some Interesting Menard County Homes.". Petersburg, Illinois 1967 and 1974, *The Petersburg Observer Co.* [www.archive.org](http://www.archive.org).
- 1112.** Internment List, Plainfield Township Cemetery, email from Tina Baird, Plainfield Public Library
- 1114.** Obituary, Elvira Bingham, May 8, 1919. *The Enterprise*. Plainfield, IL. email from Tina Baird, Plainfield Public Library
- 1115.** Obituary, Theodore Smith Bingham, October 13, 1906. *The Enterprise*, Plainfield, IL. courtesy of Sharon Kinley, Plainfield Public Library
- 1116.** Kinley, Sharon, wife of Don Kinley, grandson of Elvira Bingham Worst. 17 Nov 2009.
- 1117.** [gis.hpa.state.il.us/hargis/PDFs/200685.pdf](http://gis.hpa.state.il.us/hargis/PDFs/200685.pdf)
- 1118.** Montana Bureau of Vital Statistics. *Montana State Death Registry Index*. [www.mtgenweb.org](http://www.mtgenweb.org)
- 1119.** Rogers, Col. George D. *History of Flour Manufacture in Minnesota*. [www.archive.org](http://www.archive.org) original in Collections of the Minnesota Historical Society, Volume X, St. Paul, Minnesota Historical Society, 1905.
- 1120.** 1870 U.S. Census. Northfield, Rice, MN. Roll T132\_9. p. 456. FHL Film: 830429.
- 1121.** 1880 U.S. Census. Faribault, Rice, MN, Roll T9\_632. FHL Film 1254632, p. 423-3000, ED 147.
- 1122.** 1890 Veterans Schedules. Livingston, Park, MT. Roll 35, p. 3, ED 82.
- 1123.** 1900 U.S. Census. Livingston, Park, MT. Roll T623\_913, p. 16B, ED 73.
- 1124.** 1920 U.S. Census. Livingston Ward 2, Park, MT. Roll T625\_974. p. 17A, ED 83.
- 1125.** 1930 U.S. Census. Livingston, Park, MT. Roll 1259, p. 12B, ED 6.
- 1126.** Williams, Martin. "Narrative of the Second Regiment of Cavalry" in Minnesota Board of Commissioners, *Minnesota in the Civil and Indian Wars, 1861-1865, Volume I*. St. Paul, Pioneer Press, 1890, pp. 543-551. Available on Google Books.
- 1127.** *Billings Gazette*, 25 April 1937.
- 1128.** *Billings Gazette*, 14 May 1944.